



240 SUMMIT BOULEVARD

BIRMINGHAM, AL 35243

PROPERTY FEATURES

- +/- 2,714 SF available on the 2nd floor
- Flexible use with an open floor plan
- On-site surface parking & covered parking deck
- Shop, live, work, play environment Located at Birmingham's premier mixed-use outdoor shopping center
- Convenient to I-459, Mountain Brook, Vestavia Hills, and downtown

LEASE RATE:
\$20.00 SF/yr

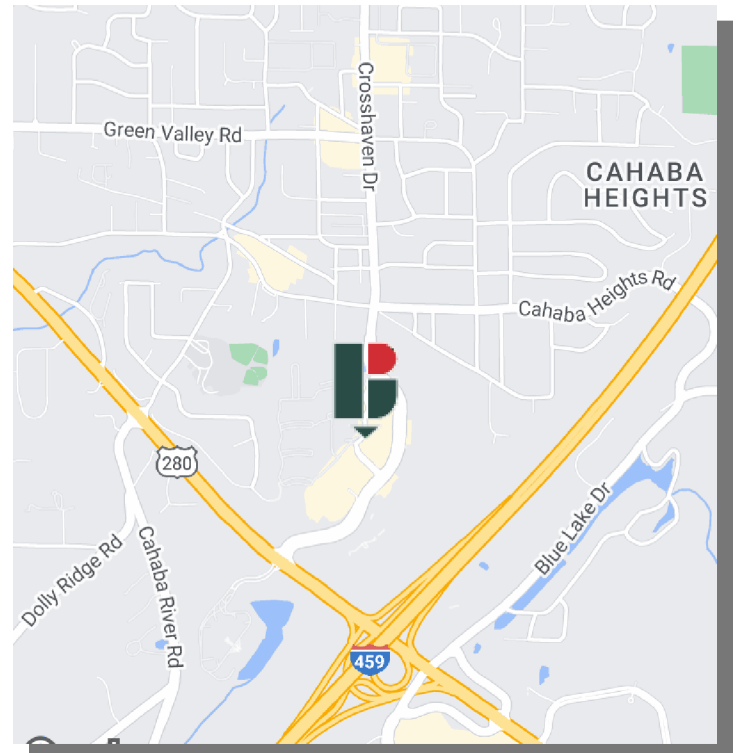

Philip Currie, SIOR, CCIM

205.313.4369

pcurrie@jhberry.com

OFFICE LAYOUT
SPACE #A2B

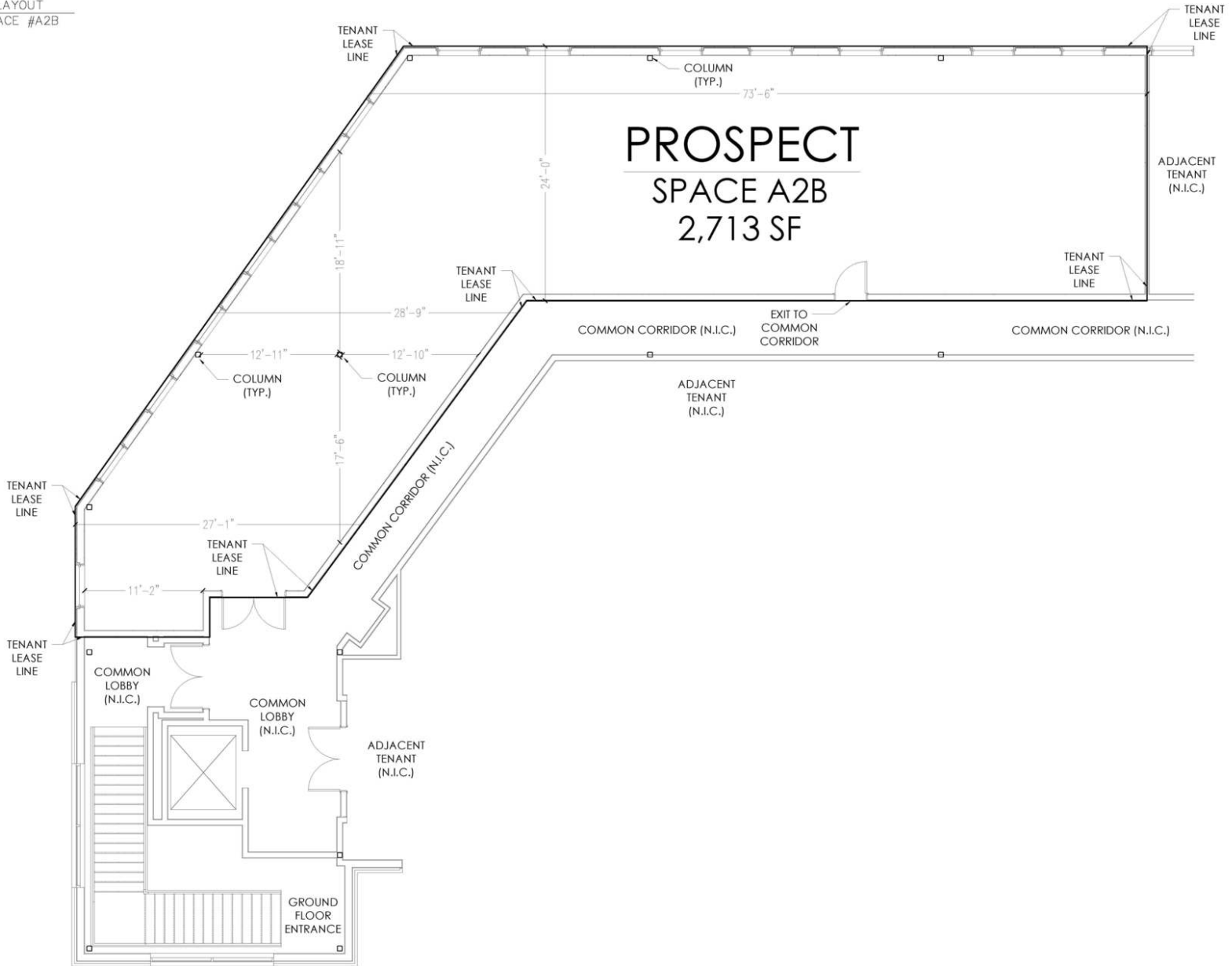

2nd Floor: +/- 2,714

Philip Currie, SIOR, CCIM
205.313.4369
pcurrie@jhberr.com

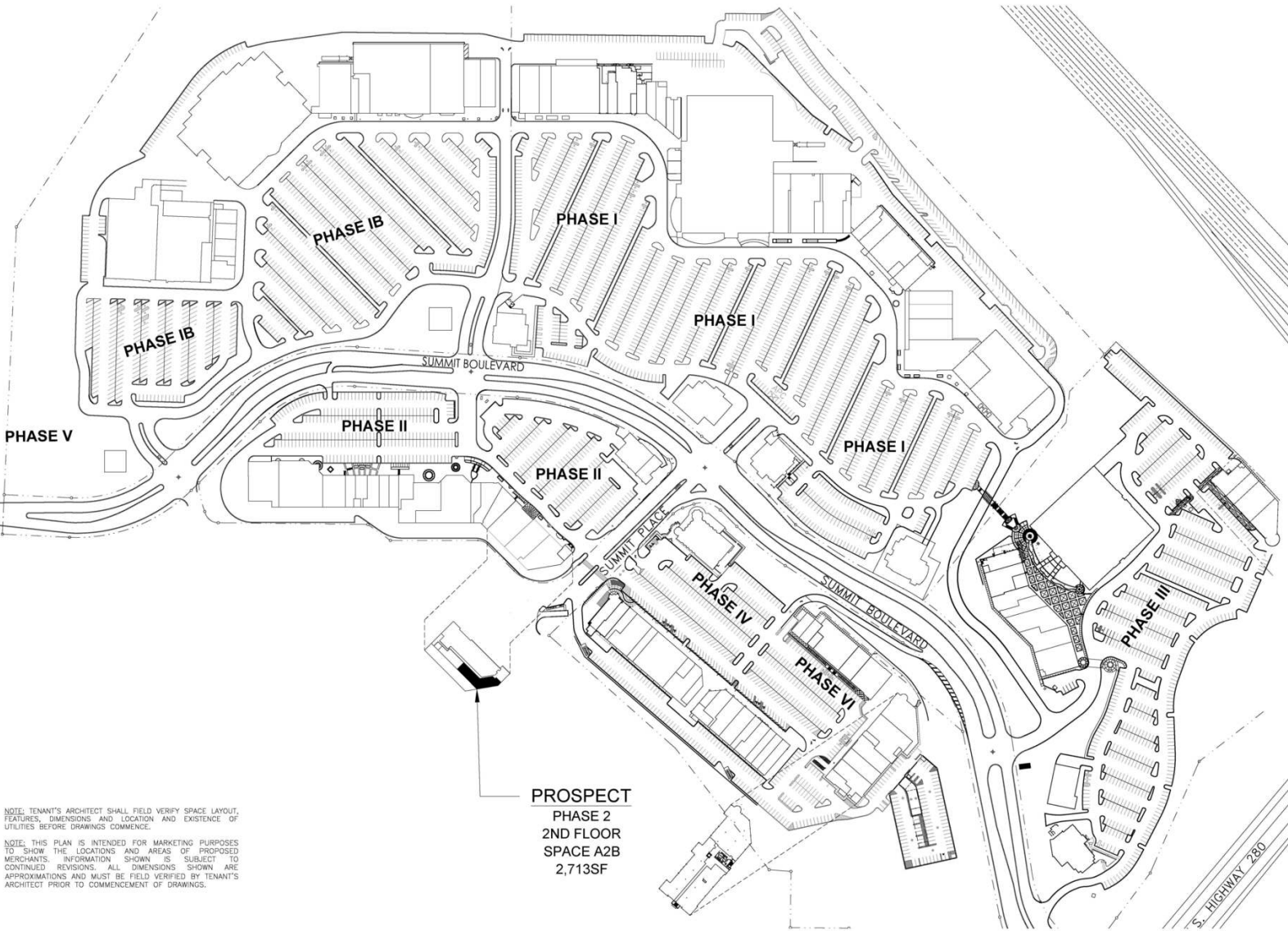

NOTE: TENANT'S ARCHITECT SHALL FIELD VERIFY SPACE LAYOUT, FEATURES, DIMENSIONS AND LOCATION AND EXISTENCE OF UTILITIES BEFORE DRAWINGS COMMENCE.

NOTE: THIS PLAN IS INTENDED FOR MARKETING PURPOSES TO SHOW THE LOCATIONS AND AREAS OF PROPOSED MERCHANDISE. INFORMATION SHOWN IS SUBJECT TO CONTINUED REVISIONS. ALL DIMENSIONS SHOWN ARE APPROXIMATIONS AND MUST BE FIELD VERIFIED BY TENANT'S ARCHITECT PRIOR TO COMMENCEMENT OF DRAWINGS.

Philip Currie, SIOR, CCIM

205.313.4369

pcurrie@jhberry.com