

MID PINELLAS MEDICAL OFFICE



2805 54th Avenue North | St. Petersburg, FL 33714

Class A Office Space for Lease



PROPERTY HIGHLIGHTS

- 15,525 RSF Available
- Located at the signalized intersection of 54th Avenue N. and 28th Street N.
- Easy access off Interstate 275
- Class A finishes
- Centrally located in Pinellas County
- 4 hospitals within 4 miles

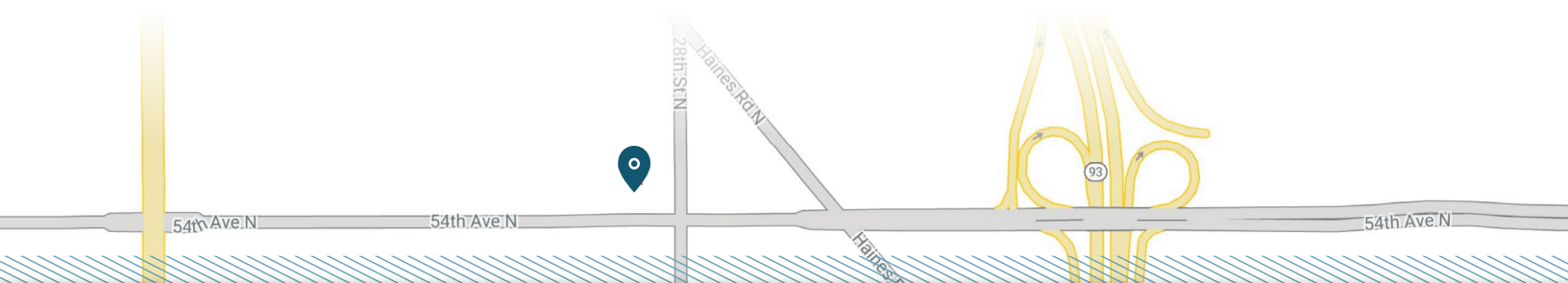

FranklinStreet

LICENSED REAL ESTATE BROKER | FranklinSt.com

CHAD RUPP

Managing Director

📞 813.345.5891

✉️ Chad.Rupp@FranklinSt.com

MATT ALEXANDER

Director

📞 813.559.2006

✉️ Matthew.Alexander@FranklinSt.com

FLOOR PLAN

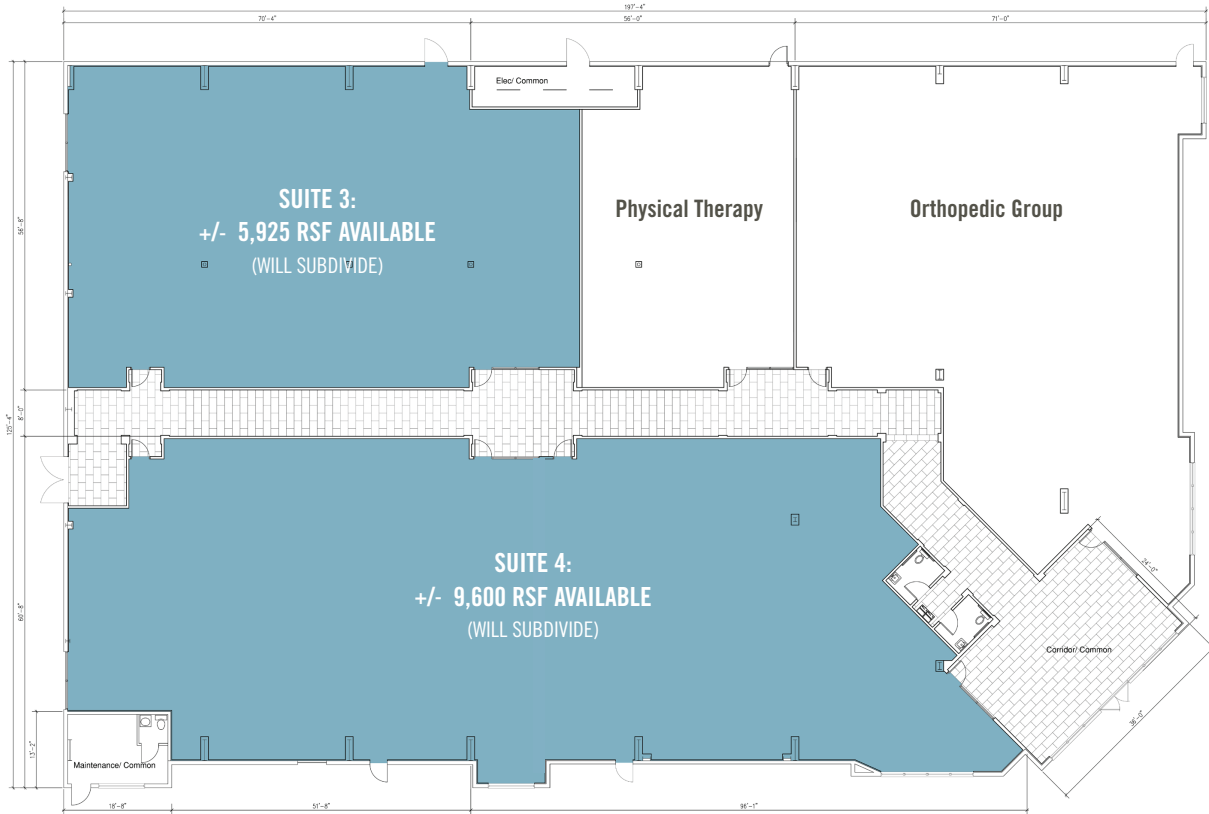

SITE PLAN

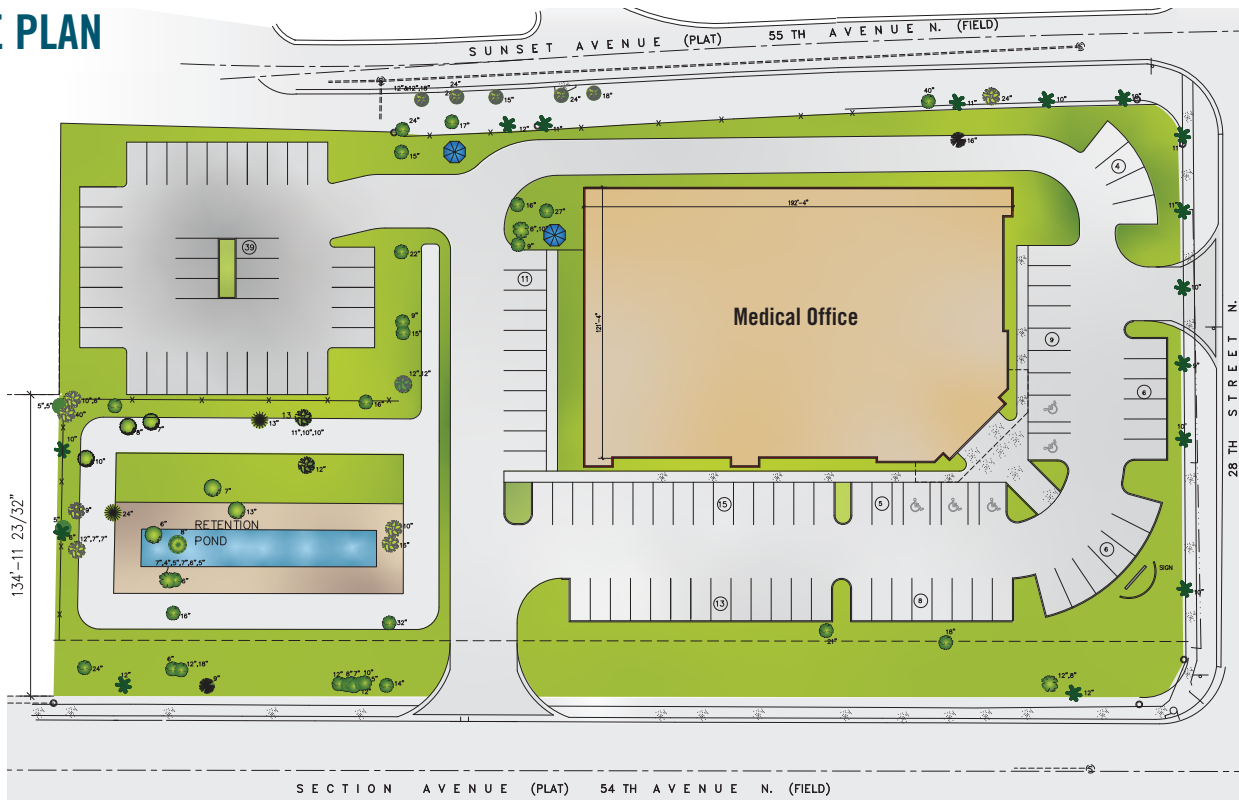

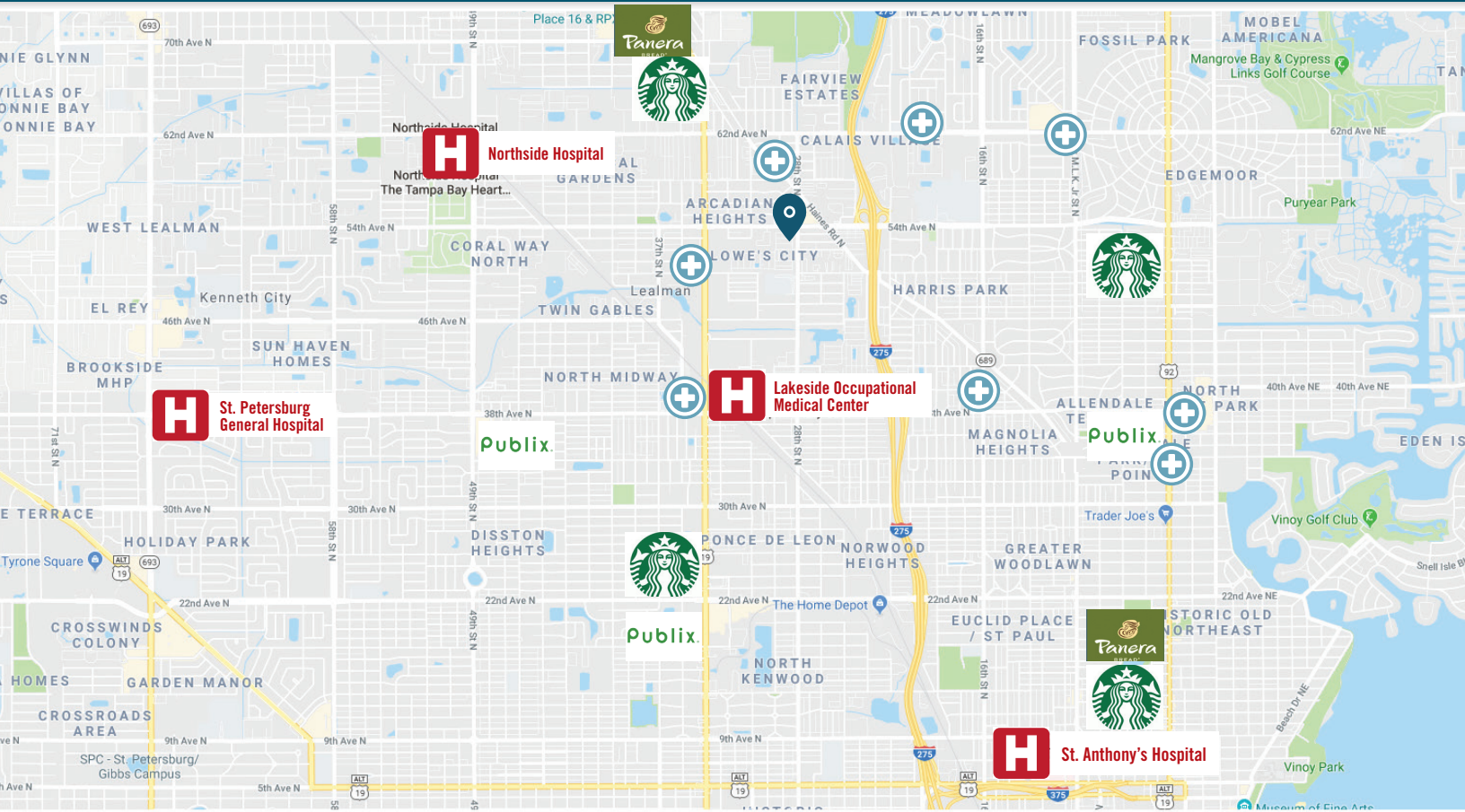

AREA HIGHLIGHTS



Hospitals

NORTHSIDE
2.1 miles from subject property

ST. PETERSBURG GENERAL
4.5 miles from subject property

BAYCARE MEDICAL GROUP
1.6 miles from subject property

ST. ANTHONY'S
4.2 miles from subject property



Medical Centers



Area Dining/Retail Options



Building Specifications

Class	A
Building Size	23,477
Year Built	1998
Parking	124 Surface Parking Spaces

Demographics

	1 mile	3 mile	5 mile
Population	15,855	128,793	294,277
Employees	5,220	45,708	171,200
Average Household	7,176	56,680	131,063
Median Age	45.2	43.4	42.9



LICENSED REAL ESTATE BROKER | FranklinSt.com

CHAD RUPP

Managing Director

📞 813.345.5891

✉️ Chad.Rupp@FranklinSt.com

MATT ALEXANDER

Director

📞 813.559.2006

✉️ Matthew.Alexander@FranklinSt.com



FranklinStreet

LICENSED REAL ESTATE BROKER | FranklinSt.com

CHAD RUPP

Managing Director

☎ 813.345.5891

✉ Chad.Rupp@FranklinSt.com

MATT ALEXANDER

Director

☎ 813.559.2006

✉ Matthew.Alexander@FranklinSt.com