

# Mooreville Office/Flex Space

4,850 SF of Office/Flex Space

167 & 165 River Park Road  
Mooreville NC 28117



## Space Highlights

- + Up to 4,850 square feet of office/shared warehouse available for use
- + Private entrance from glass vestibule
- + Ample parking on side and in front of building
- + Flexible office configurations available
- + Oversized grade level drive-in door in warehouse
- + Close to coffee shops, restaurants, grocery stores, and more retail

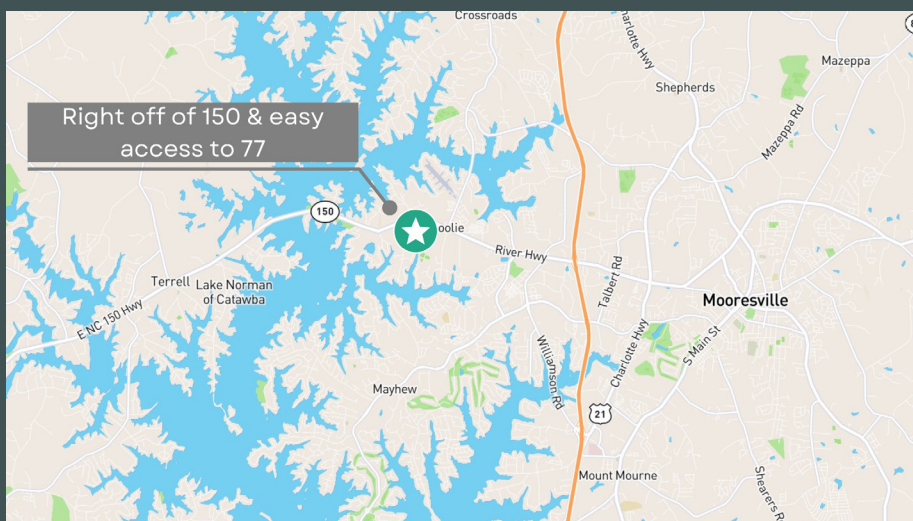

## Space Plan - 9,700 SF

- 5 offices
- 2 storage rooms
- Conference room
- Large reception area
- Spiral staircase to 2nd floor
- 2 private restrooms
- Large kitchenette/break room
- Additional work space and storage on 2nd floor
- Access to portion of shared warehouse space

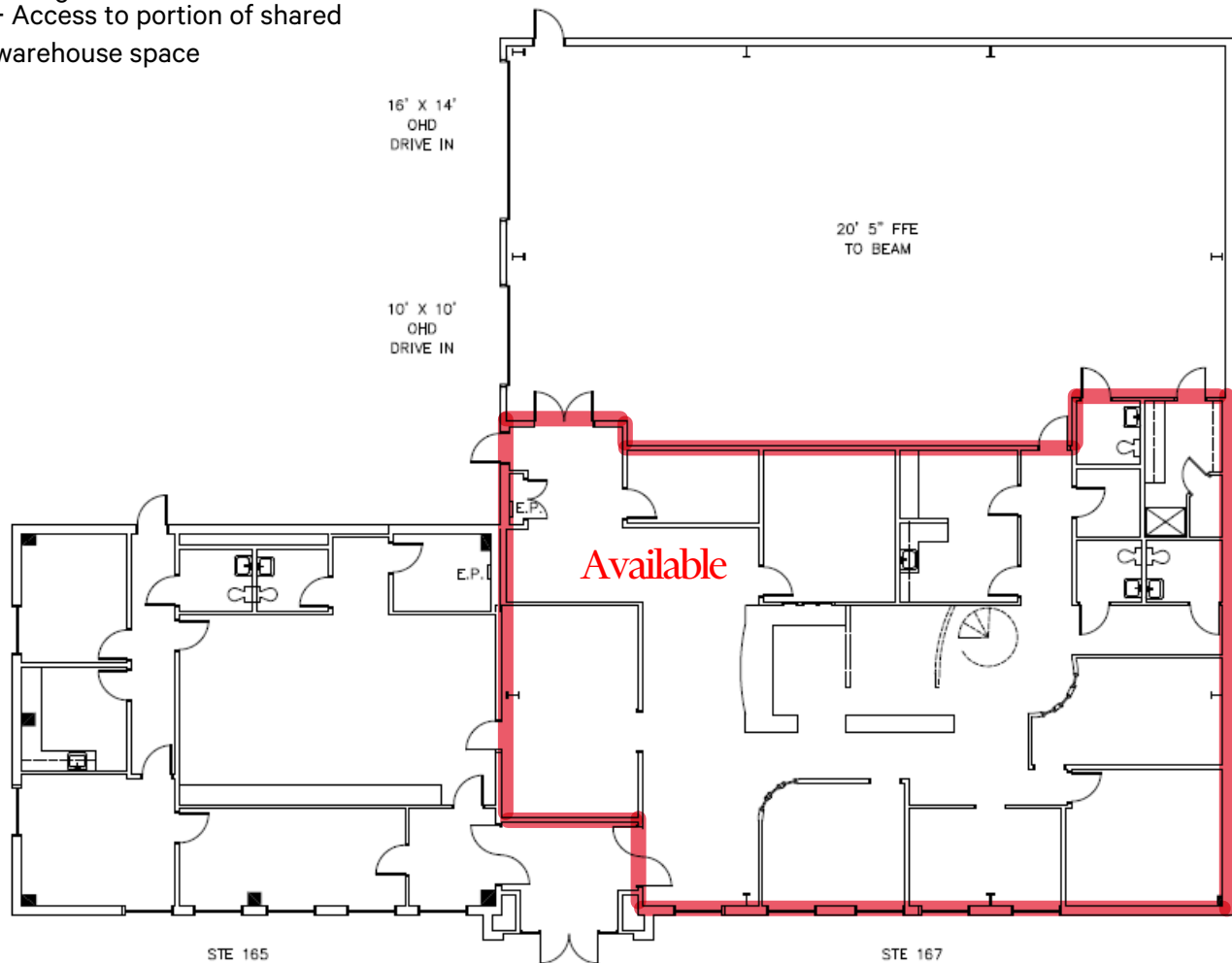
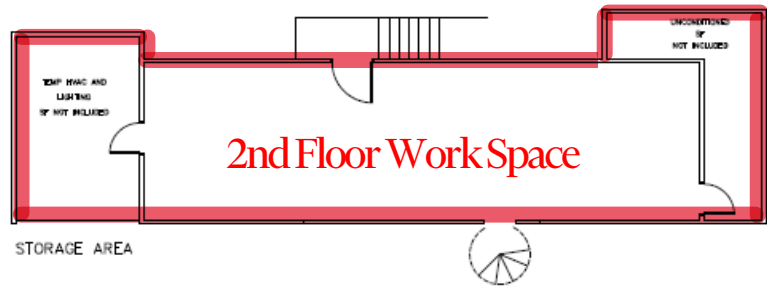





## Contact Us

**Diana Williams**

+1 585 613 5843

diana.williams@cbre.com

**John Christenbury**

+1 704 330 9988

john.christenbury@cbre.com

© 2021 CBRE, Inc. All rights reserved. This information has been obtained from sources believed reliable, but has not been verified for accuracy or completeness. You should conduct a careful, independent investigation of the property and verify all information. Any reliance on this information is solely at your own risk. CBRE and the CBRE logo are service marks of CBRE, Inc. All other marks displayed on this document are the property of their respective owners, and the use of such logos does not imply any affiliation with or endorsement of CBRE. Photos herein are the property of their respective owners. Use of these images without the express written consent of the owner is prohibited.