



6450 Gunpark Drive

Boulder, CO

High-Tech Workspaces With a “Destination Office” Feel

Steve Sims

steve@gibbonswhite.com

(303) 586-5932

www.gibbonswhite.com

Property Info & Gallery

View Map

Available Office Spaces

Unit	Size	Lease Rate / sq. ft.
1 (Includes Mezzanine)	5,998 sq. ft.	\$17.60 Modified Gross*
2	6,516 sq. ft.	\$17.60 Modified Gross*
3	2,499 sq. ft.	\$18.50 Modified Gross*
4	15,740 sq. ft.	\$17.30 Modified Gross*
5	20,784 sq. ft.	\$17.30 Modified Gross*

**Plus Prorated Electric & Janitorial*

- Energizing Creative Workspace that Attracts Talent, Sparks Creativity, & Makes People Excited to Show up. Central Location - Bicycle or Short Drive to Work. Restaurants & Shopping Across the Street.
- Spacious Common Areas with Smart Conference Room (“The Barn”), Huddle Rooms, Presentation Spaces, Outdoor Patios, Showers, & an On-Site Gym, Kitchen & Lunch Room.
- Easy Access to Diagonal (Hwy 119) with 10 Minute Drive to Boulder & Longmont & 20 Minutes To Louisville & Lafayette. Across the Street from King Soopers, Shopping Center, Coffee Shops, with many Nearby Restaurants.
- Denver International Airport is just a 55-minute Drive Away (44.2 miles)

© 2026 Gibbons-White, Inc.

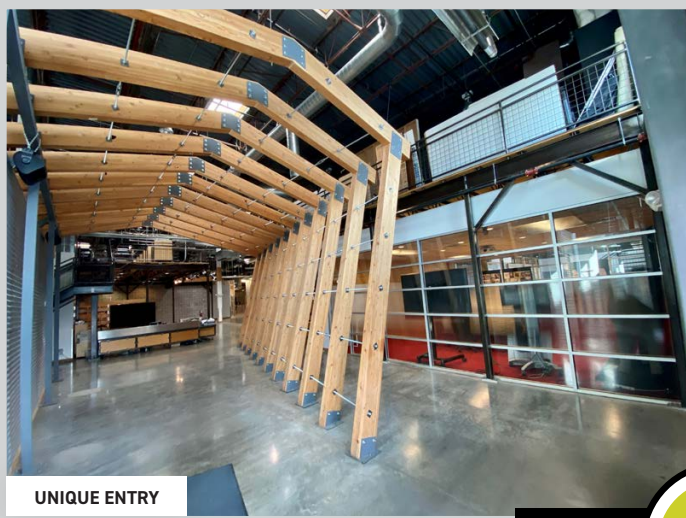
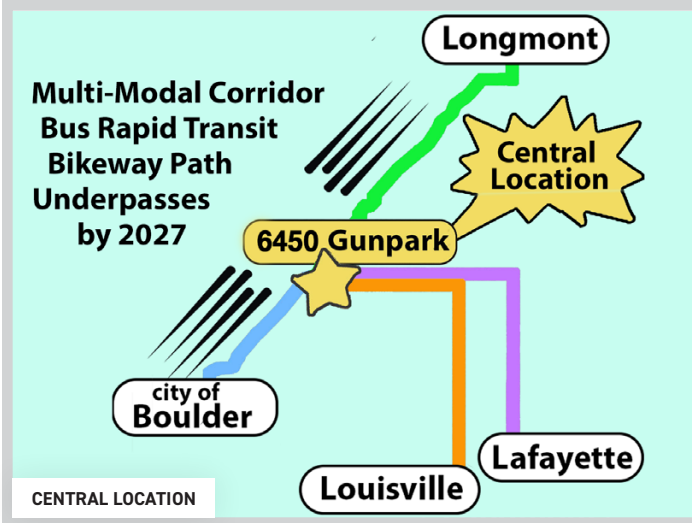

VIDEO  TOUR

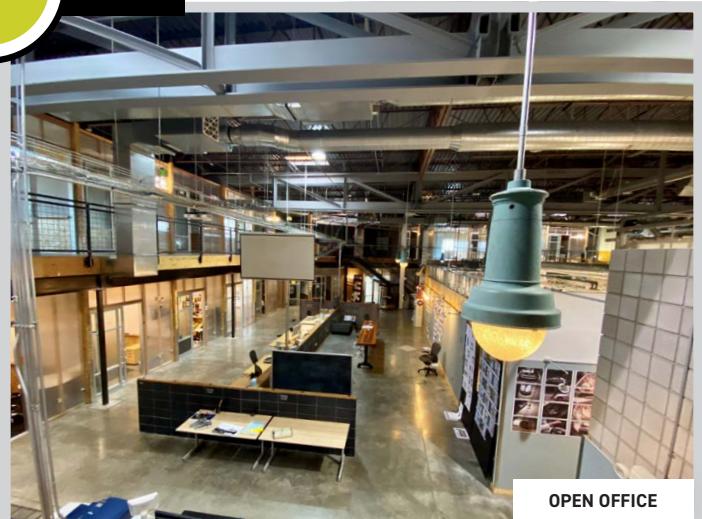

Main Level

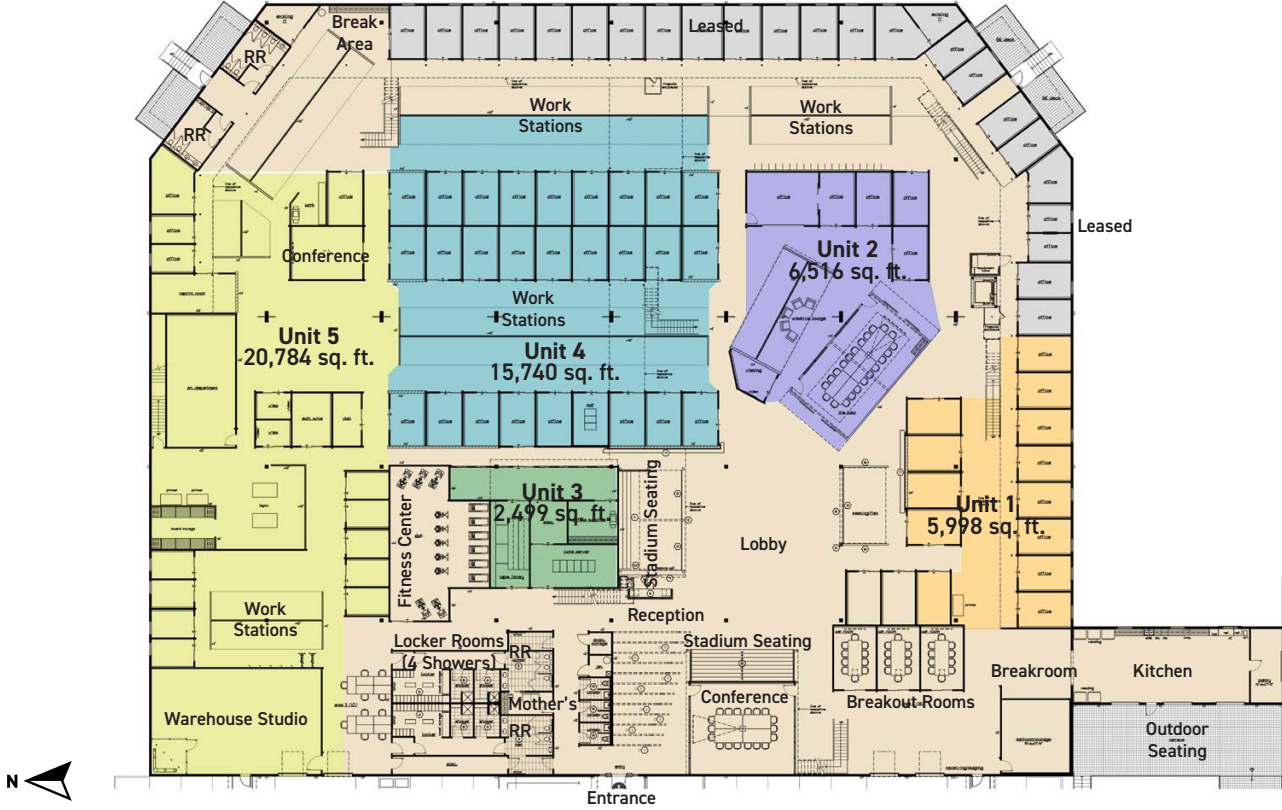

Mezzanine Level



