

For Sale
6,583 SF | \$1,025,000
Professional Office



Professional Office Building

275 Professional Court
Riverdale, Georgia 30274

Property Overview

Professional office building featuring approximately 6,583 SF on 0.935 acres in Riverdale, GA. The brick building features excellent parking ratios, multiple suite entrances, and professional landscaping. Located in Riverdale's established medical corridor with strong visibility and convenient I-75 access.

The building offers a mix of private offices, open work areas, conference space, and support functions. The brick exterior provides multiple suite entrances for tenant convenience and flexible floor plans that can accommodate various professional uses. Interior spaces include private offices, administrative areas with cubicle stations, a conference room, kitchen/break areas, and storage throughout.

The 0.935-acre site provides generous parking and accessible entries. The property is suitable for continued medical office use, multi-specialty group occupancy, or conversion to alternative professional uses.

Property Highlights

- ≈ 6,583 SF professional office building on 0.935 acres
- Flexible floor plan with multiple suite configurations
- Private offices, conference space, and open work areas
- Prime Riverdale location with I-75 access
- Ample parking with professional landscaping

Offering Summary

Sale Price:	\$1,025,000
Building Size:	≈ 6,583 SF
Lot Size:	0.935 Acres

For More Information

Brian Elrod, CCIM

O: 706 553 1000 | C: 678 859 6110
brian@naielrod.com | GA #251606

For Sale

6,583 SF | \$1,025,000

Additional Photos



For Sale
6,583 SF | \$1,025,000
Floor Plan

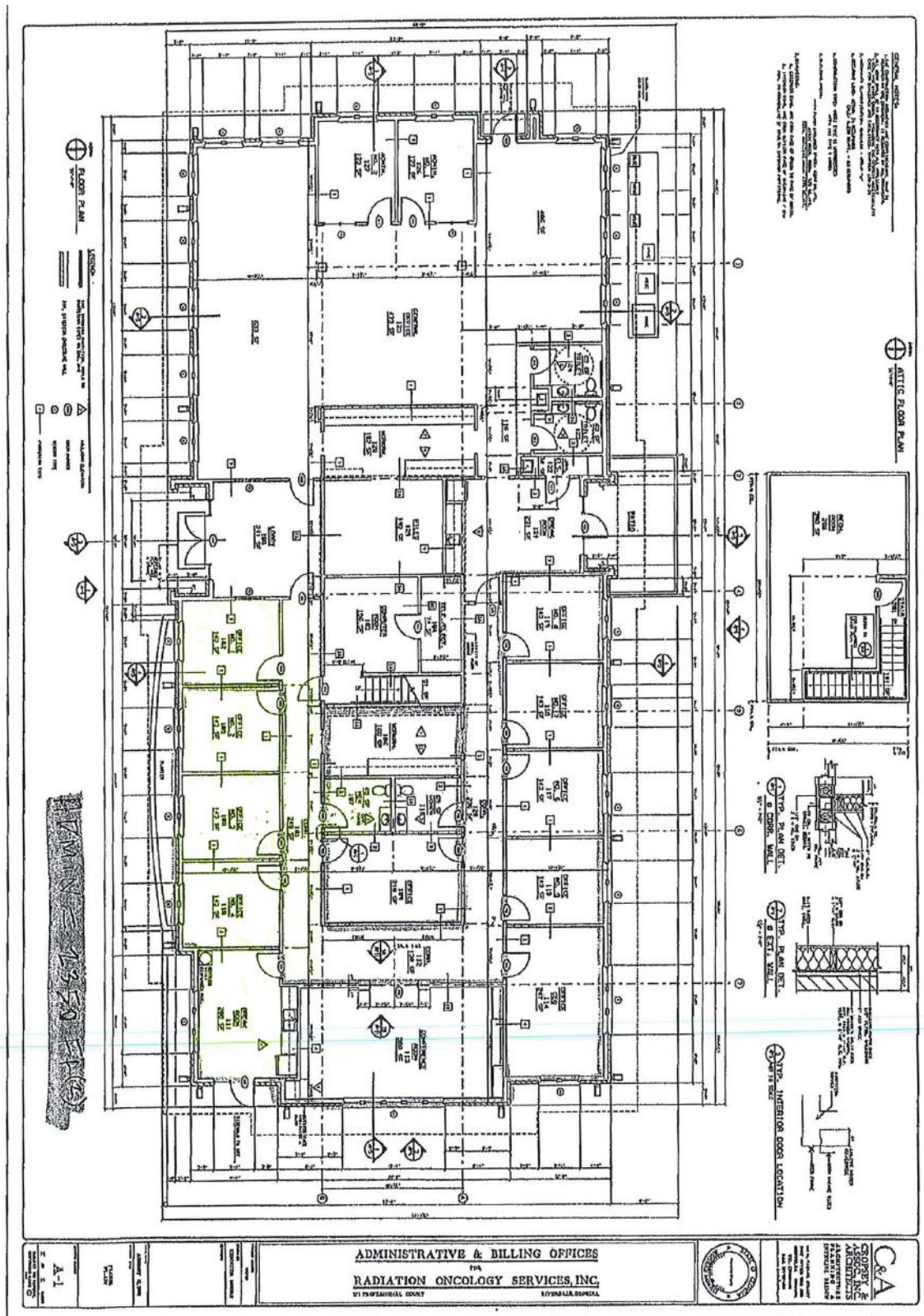

For Sale

6,583 SF | \$1,025,000

Aerial Photo





For Sale

6,583 SF | \$1,025,000

Location Map

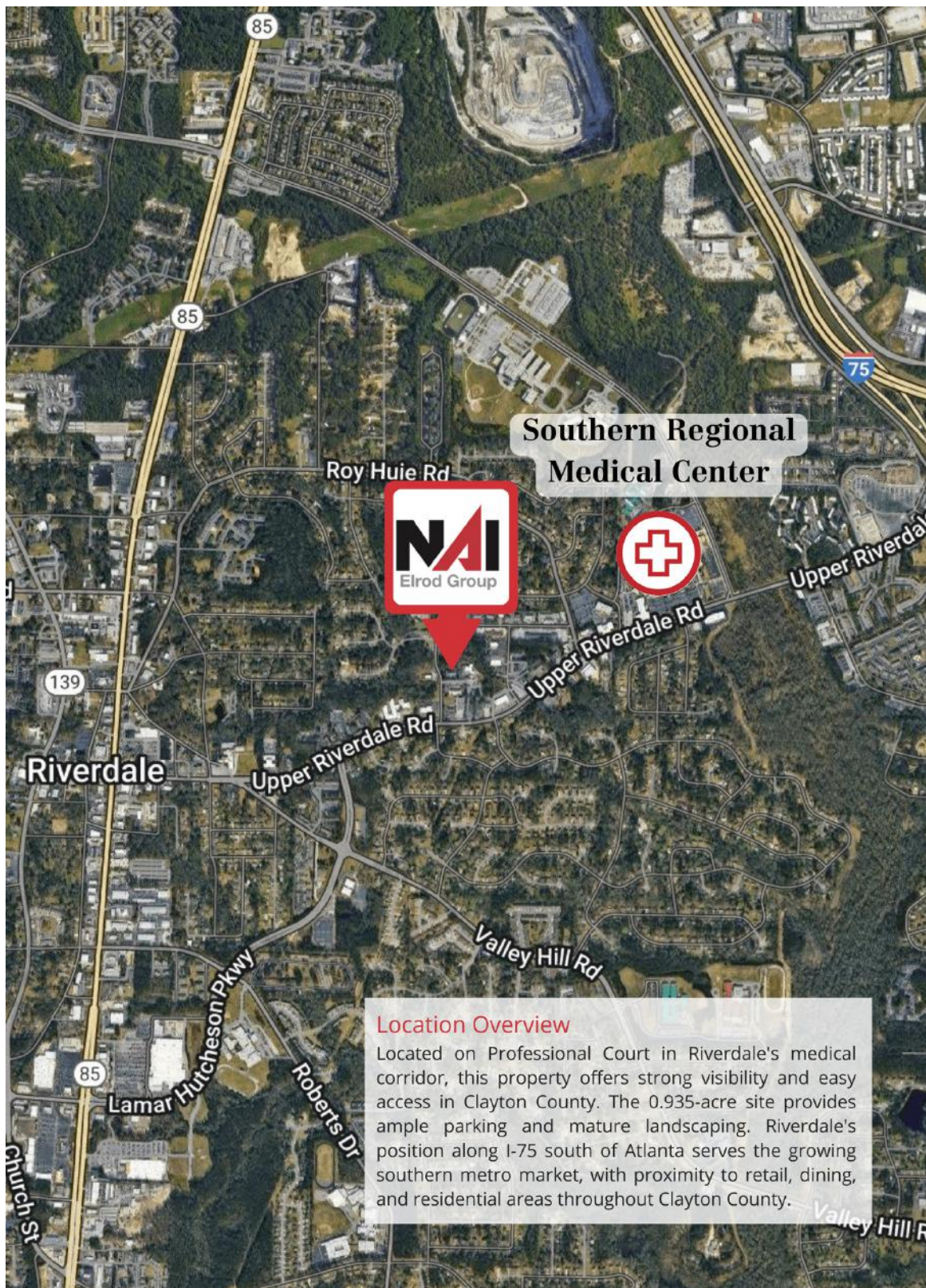

For Sale

6,583 SF | \$1,025,000

Aerial Analytics

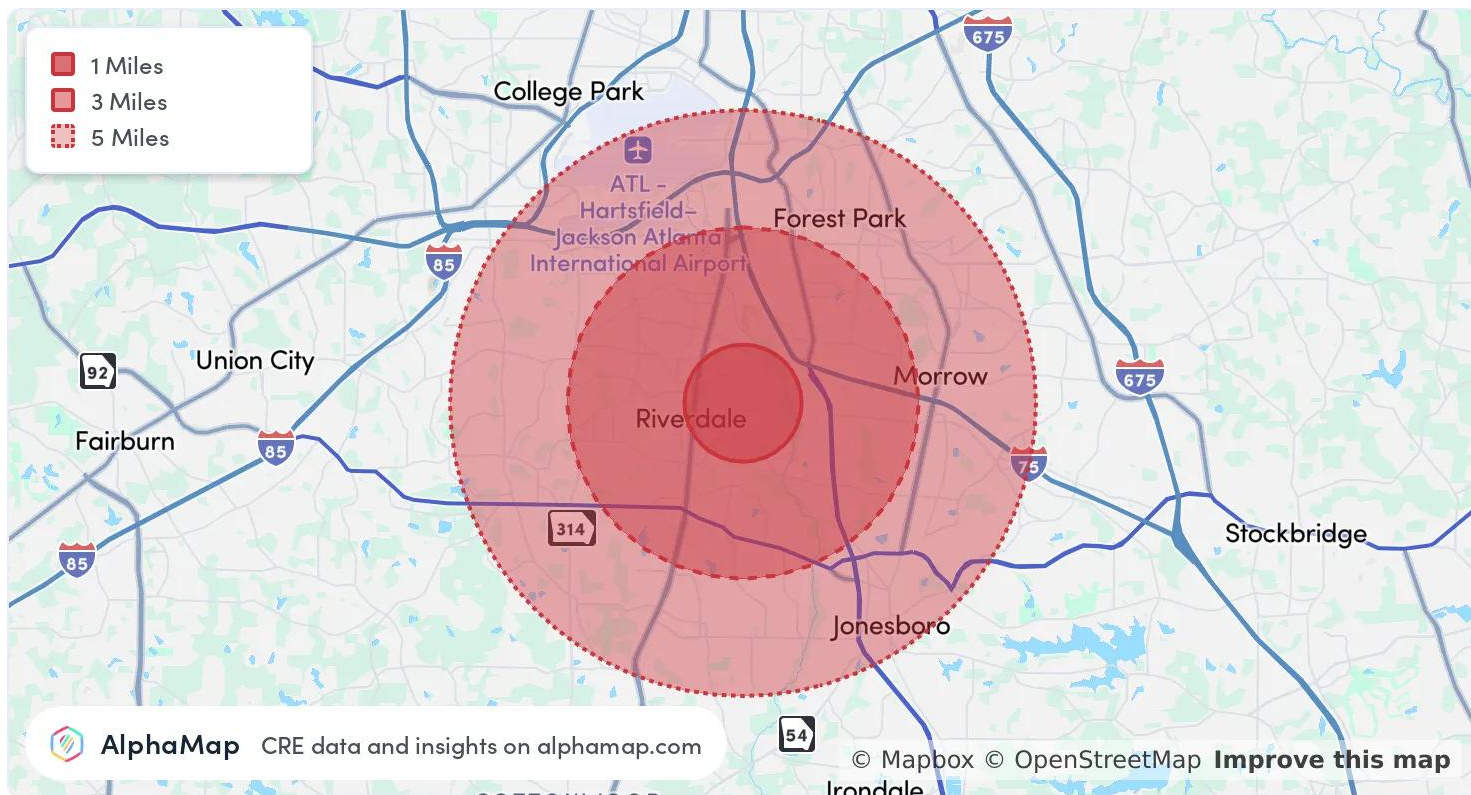

Population	1 Mile	3 Miles	5 Miles
Total Population	9,996	86,013	204,839
Average Age	37	36	37
Average Age (Male)	35	35	35
Average Age (Female)	38	37	38
Household & Income	1 Mile	3 Miles	5 Miles
Total Households	3,600	32,502	75,191
Persons per HH	2.8	2.6	2.7
Average HH Income	\$70,024	\$62,808	\$66,946
Average House Value	\$169,733	\$177,739	\$215,010
Per Capita Income	\$25,008	\$24,156	\$24,794

Map and demographics data derived from AlphaMap