



INDUSTRIAL BUILDING FOR SALE

845 VALLEY VIEW ROAD

SOUTHERN PINES, NC 28387

SCOTT HADLEY

D 919.576.2504

C 919.906.0524

shadley@lee-associates.com

HUNTER STEWART, SIOR, MBA

D 919.576.2507

C 919.548.3172

hstewart@lee-associates.com

AIMEE GIBBS, J.D.

D 919.591.2267

C 919.548.9649

agibbs@lee-associates.com

JAIME MAINOR

D 984.684.5009

C 919.628.5090

jmainor@lee-associates.com

 **LEE &
ASSOCIATES**

COMMERCIAL REAL ESTATE SERVICES
RALEIGH • DURHAM • WILMINGTON

All information furnished regarding property for sale, rental or financing is from sources deemed reliable, but no warranty or representation is made to the accuracy thereof and same is submitted to errors, omissions, change of price, rental or other conditions prior to sale, lease or financing or withdrawal without notice. No liability of any kind is to be imposed on the broker herein.

PROPERTY SUMMARY

OVERVIEW

The former Epic Enterprises building is a 44,500 SF industrial/manufacturing building with offices just east of the Southern Pines city limits with access to US 1 via the Hyland Hills intersection at the back of the property.

PROPERTY HIGHLIGHTS

- » 44,500 SF building
- » ±9.566 Total acres across 8 parcels
- » Residential properties are intentionally undeveloped to create a buffer
- » Industrial on northern side of Southern Pines
- » Access off of US-1 and Valley View Rd
- » Full movement intersection at US-1
- » Additional land
- » Public water
- » 1 dock, 1 grade level door
- » Septic
- » ±6,000 SF of office
- » Conditioned office space; heated warehouse
- » Ceiling heights:
 - » Right side: 14' at center and 11' 8" at eaves
 - » Left side: 14' 8" at center and 11' 3" at eaves
- » Ample parking

PRICING

- » \$3,500,000



OFFICE AREA



WAREHOUSE AREA



FLOOR PLAN

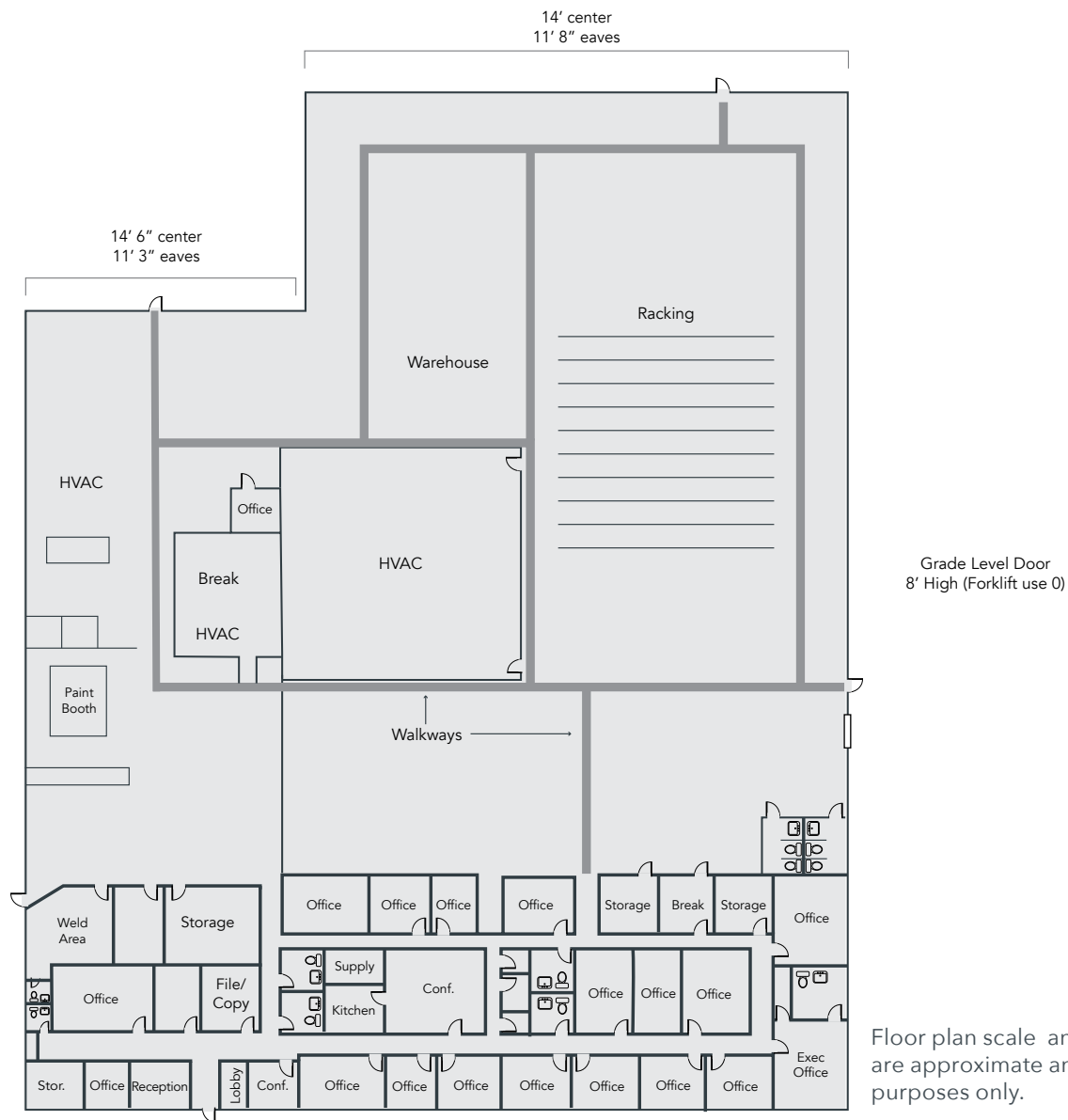

Floor plan scale and door locations are approximate and for illustrative purposes only.



INDUSTRIAL BUILDING FOR SALE | 845 VALLEY VIEW ROAD | SOUTHERN PINES, NC 28387

AREA OVERVIEW

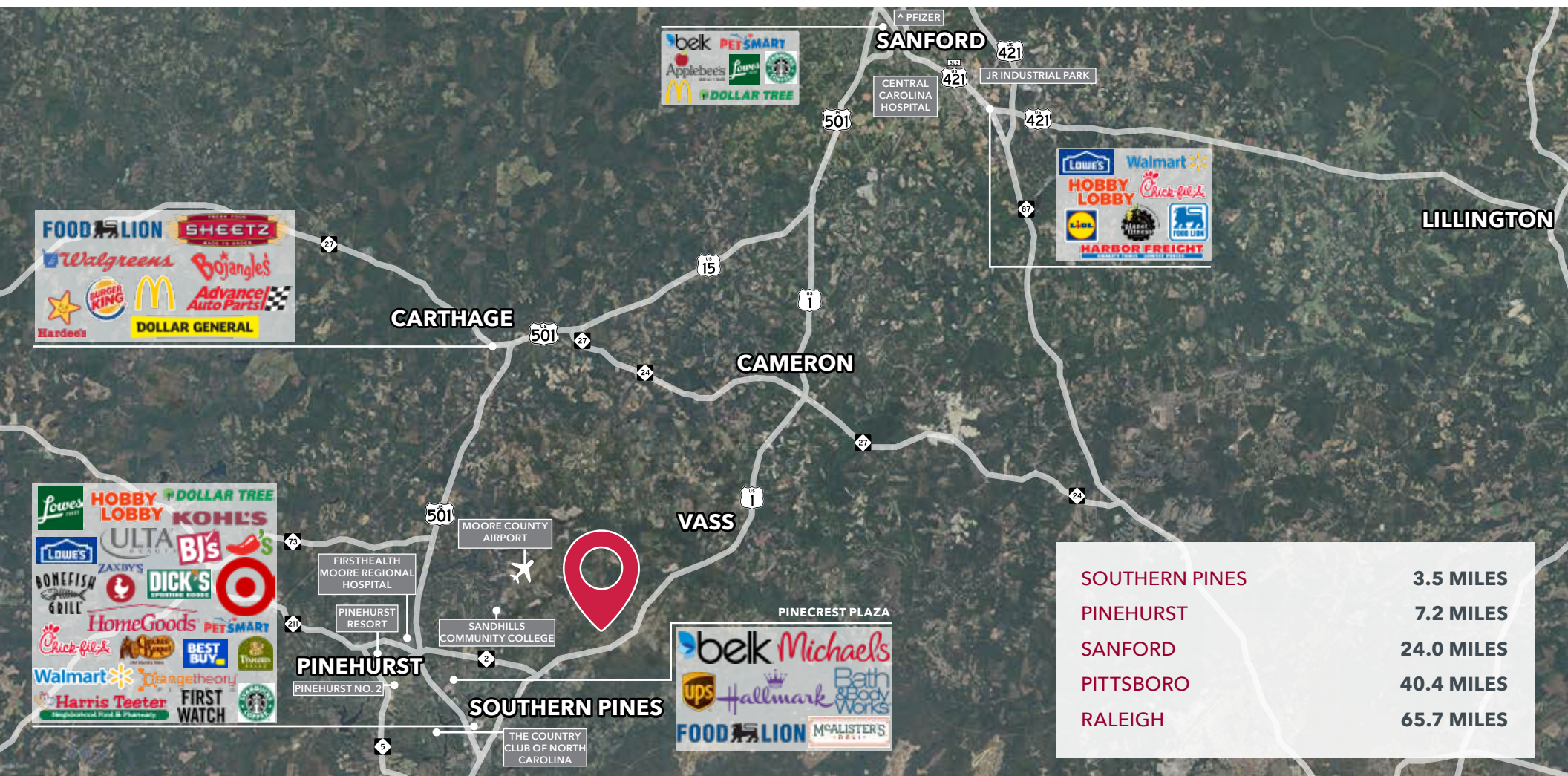

SOUTHERN PINES	3.5 MILES
PINEHURST	7.2 MILES
SANFORD	24.0 MILES
PITTSBORO	40.4 MILES
RALEIGH	65.7 MILES

DEMOGRAPHICS

	5 MILES	10 MILES	15 MILES
Population (2025)	381	7,230	23,825
2030 Projected Population	431	9,061	32,354
Daytime Population	351	9,393	34,720
Median Age	44.1	44.7	43.6
Median Home Value	\$332,692	\$404,732	\$446,449



SCOTT HADLEY

VICE PRESIDENT, PRINCIPAL

D 919.576.2504

C 919.906.0524

shadley@lee-associates.com

AIMEE GIBBS, J.D.

BROKER

D 919.591.2267

C 919.548.9649

agibbs@lee-associates.com

HUNTER STEWART, SIOR, MBA

VICE PRESIDENT, PRINCIPAL

D 919.576.2507

C 919.548.3172

hstewart@lee-associates.com

JAMIE MAINOR

ASSOCIATE BROKER

D 984.684.5009

C 919.628.5090

jmainor@lee-associates.com

100 Walnut Street | Cary, NC 27511 | 919.576.2500 | lee-associates.com/raleigh

All information furnished regarding property for sale, rental or financing is from sources deemed reliable, but no warranty or representation is made to the accuracy thereof and same is submitted to errors, omissions, change of price, rental or other conditions prior to sale, lease or financing or withdrawal without notice. No liability of any kind is to be imposed on the broker herein.



COMMERCIAL REAL ESTATE SERVICES
RALEIGH • DURHAM • WILMINGTON