

FOR LEASE

Owned and Operated by



333 N. Euclid Way

Anaheim, CA 92801

±60,245 SF



Property Highlights

Total SQFT	60,245 SQFT
USDA Production	5,000 SQFT
Refrigeration*	27,000 SQFT
Frozen*	2,500 SQFT
Loading	6 Dock Doors, 1 Grade Level

*** Refrigeration/Freezer mechanical systems will need to be installed.**



LEASING INFO & CONTACT

Randy Ellison
Brett Lockwood

(949) 930-4371 / randy.ellison@cushwake.com
(949) 930-2481 / brett.lockwood@cushwake.com





SITE PLAN



FLOORPLAN

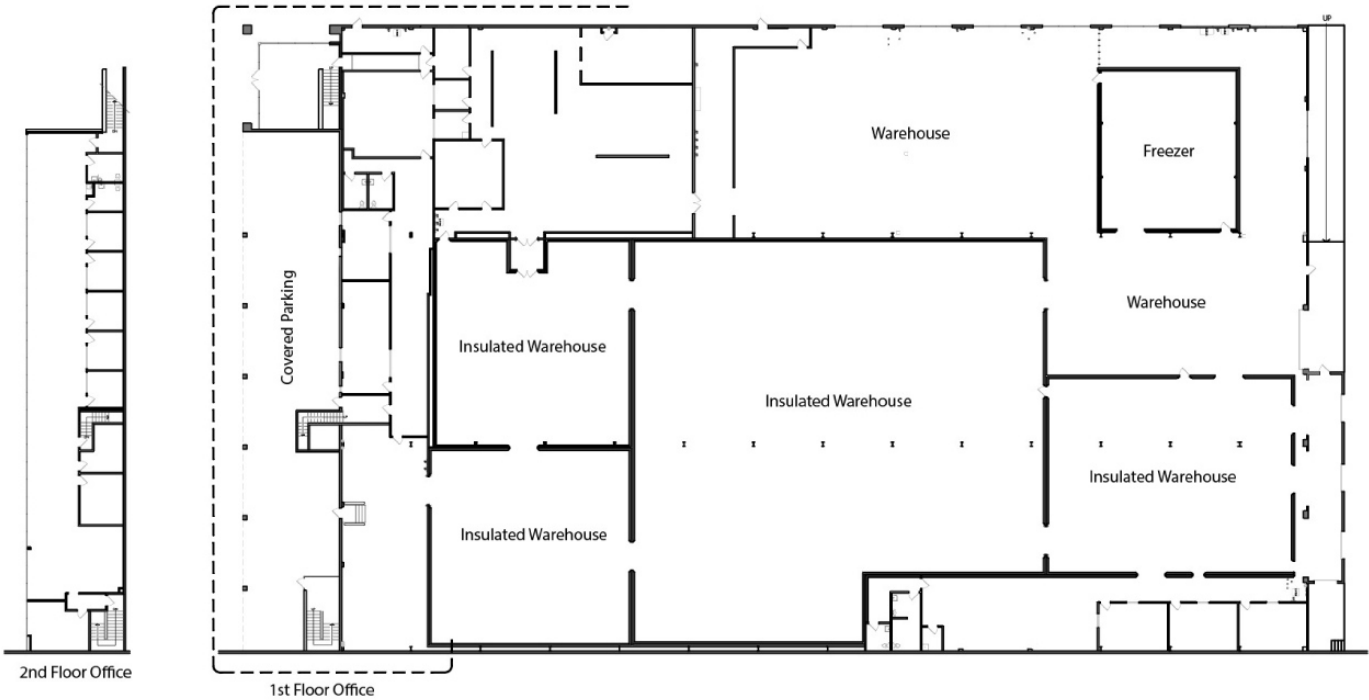

Locator Map

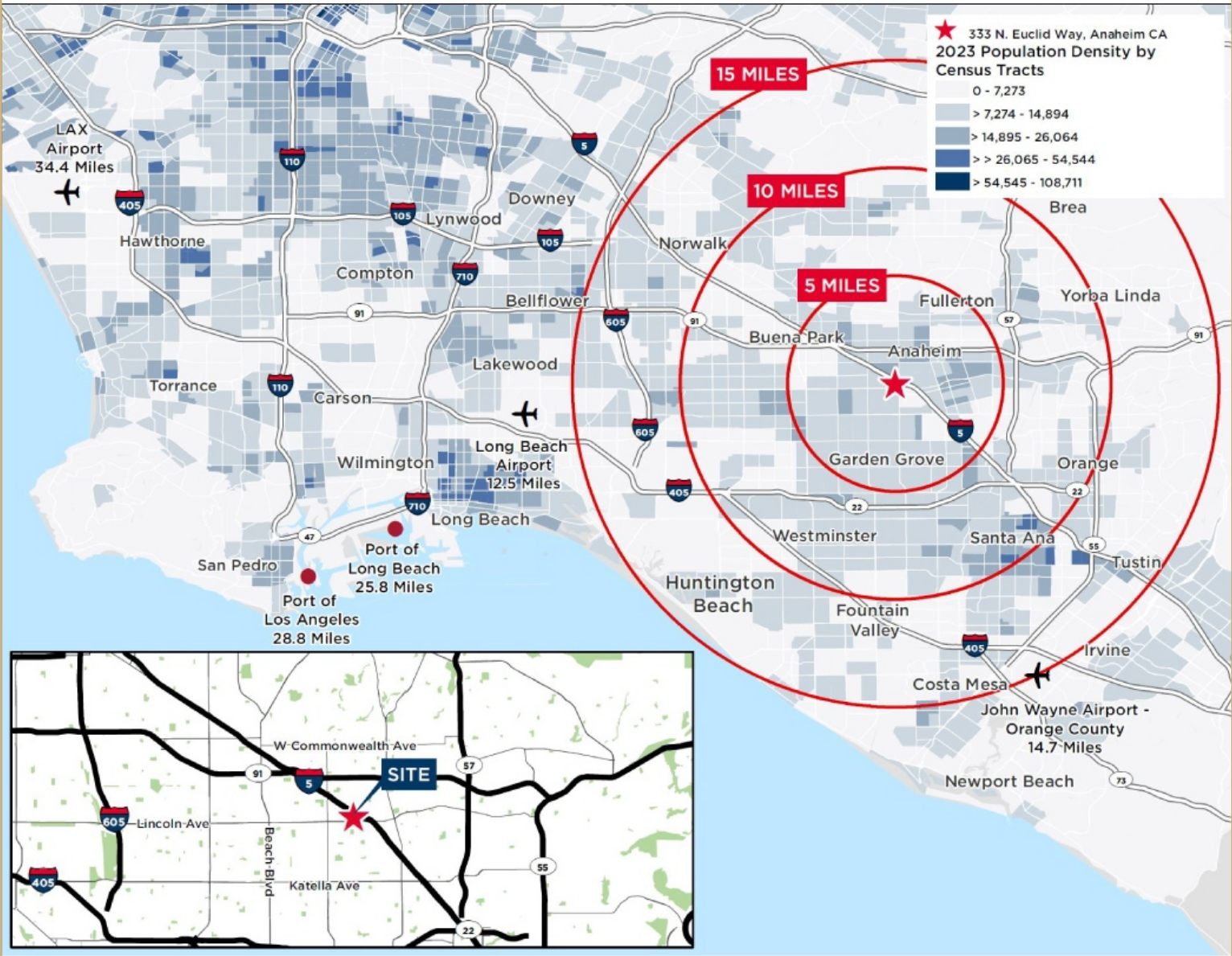

USDA
PRODUCTION
PLANT FOR
LEASE

Available for lease is 333 N. Euclid Way, in Anaheim CA. This building is approximately 60,245 total square feet, with approximately 5,000 sqft of USDA production, 27,000 sqft. of storage (can be converted to refrigeration), 2,500 sqft of storage (can be converted to frozen/cooler), and 10,000 sqft.of office. The prior occupant conformed to USDA and SQF level 2 designations. The refrigeration areas re designed to 38', 4 cooking hoods, grease trap of 1,500 gallons, fully sprinklered, and 6 dock positions (3 enclosed; 3 on exterior covered loading platform. This property is undergoing a major refurbishment and is conveniently located directly adjacent to the 5 freeway.