

# PREMIUM MIDTOWN/UPPER SEABRIGHT LOCATION



1119 SOQUEL AVENUE, SANTA CRUZ

## PROPERTY FEATURES:

- 1000 SF Storefront Space
- High Ceilings
- C-1 Zoning
- Classic two-tenant Art Deco building
- Ideal for Retail, Office or Restaurant
- High Traffic Counts
- Close to other popular shops, restaurants, and the Rio Theatre.

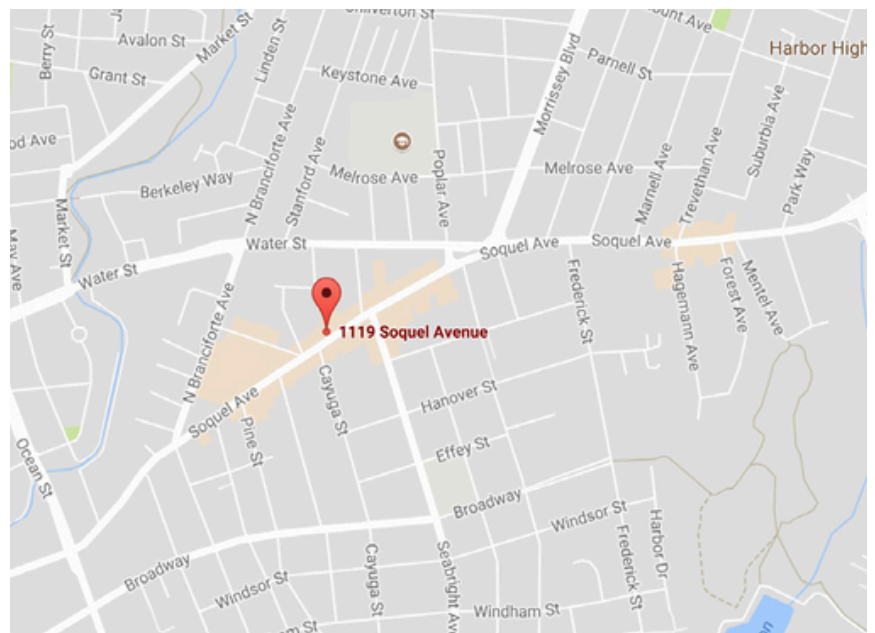

Offered At  
\$ 2750/Month  
(\$2.75/Gross)



**DATTA KHALSA**  
BROKER & OWNER

Cell: 831.818.0181  
Office: 831.462.400 ext. 201  
datta@mainstreetrealtors.com  
DRE # 01161050



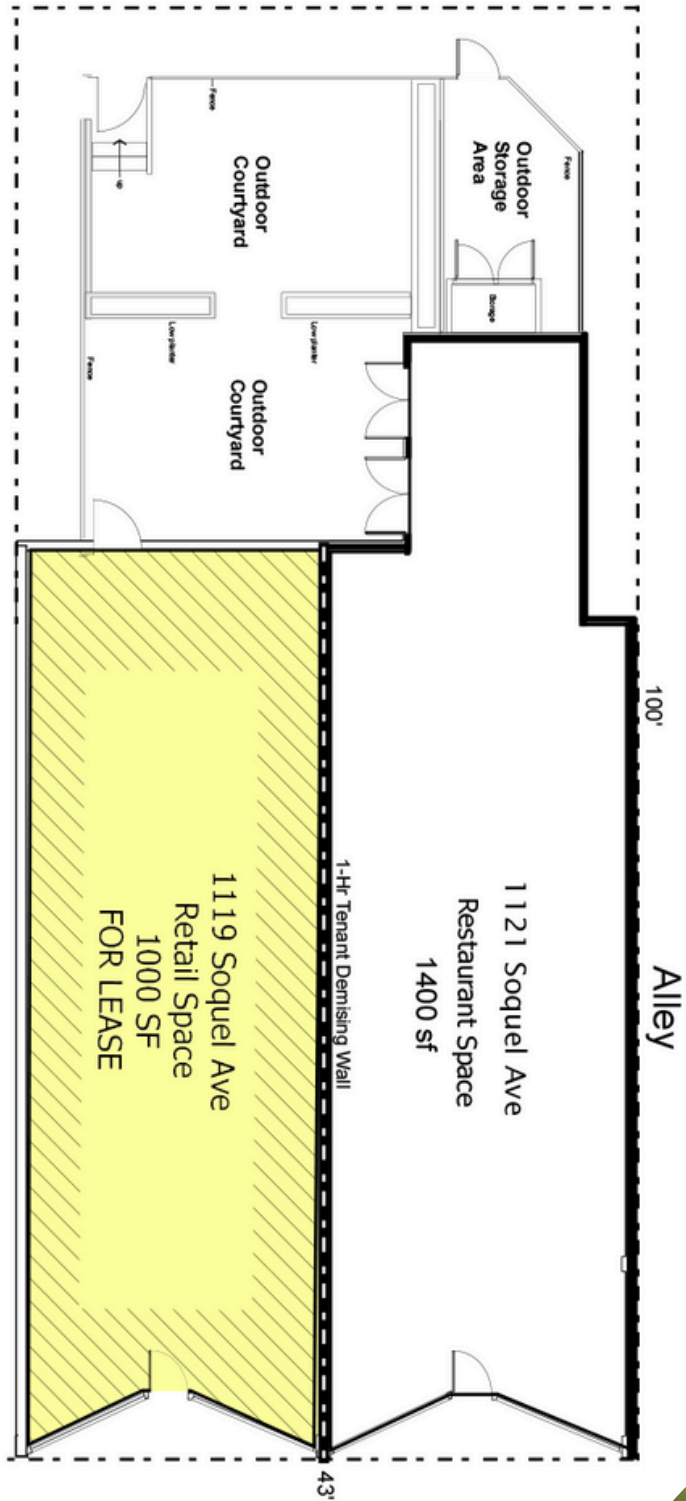

**DATTA KHALSA**  
BROKER & OWNER

Cell: 831.818.0181  
Office: 831.462.400 ext. 201  
datta@mainstrealtors.com  
DRE # 01161050