

INDUSTRIAL SPACE FOR SALE/LEASE NEAR ST. JAMES INDUSTRIAL



1373 SPRUCE STREET

WINNIPEG, MB



CONTACT

ERIC OTT, Associate Vice President, Sales & Leasing
(204) 985-1378
eric.ott@capitalgrp.ca
Services provided by Eric A. Ott Personal Real Estate Corporation

MARIO POSILLIPO, Senior Advisor, Sales & Leasing
(204) 985-1373
mario.posillipo@capitalgrp.ca

PROPERTY DETAILS

BUILDING AREA (+/-)	16,449 sq. ft.
LAND AREA (+/-)	31,806 sq. ft. (0.73 acres)
SALE PRICE	\$2,350,000.00
NET RENTAL RATE	\$9.95 per sq. ft.
PROPERTY TAX	\$1.49 per sq. ft. (\$24,457.29 for 2025)
TITLE NO.	1536828/1
LEGAL DESCRIPTION	LOT 2 PLAN 25864 WLTO IN OTM LOT 50 PARISH OF ST JAMES
LOADING	(1) Dock (8'x8') & (2) Grade Doors (12'x16' and 8'x10')
ZONING	M2 – Manufacturing – General
CLEAR HEIGHT (+/-)	28' clear in back 4,992 sq. ft. section
ELECTRICAL	400 Amp total service, with a 225 Amp transformer for 600V 3-phase
COLUMNS	Clear span construction in back section
YEAR BUILT	1927 (with a 4,992 SF addition in 2005)
ROLL NO.	13010403000

HIGHLIGHTS

- Extensive office buildout
- Fully sprinklered
- Versatile loading options (dock & grade)
- Recent upgrades to the front facade enhance curb appeal



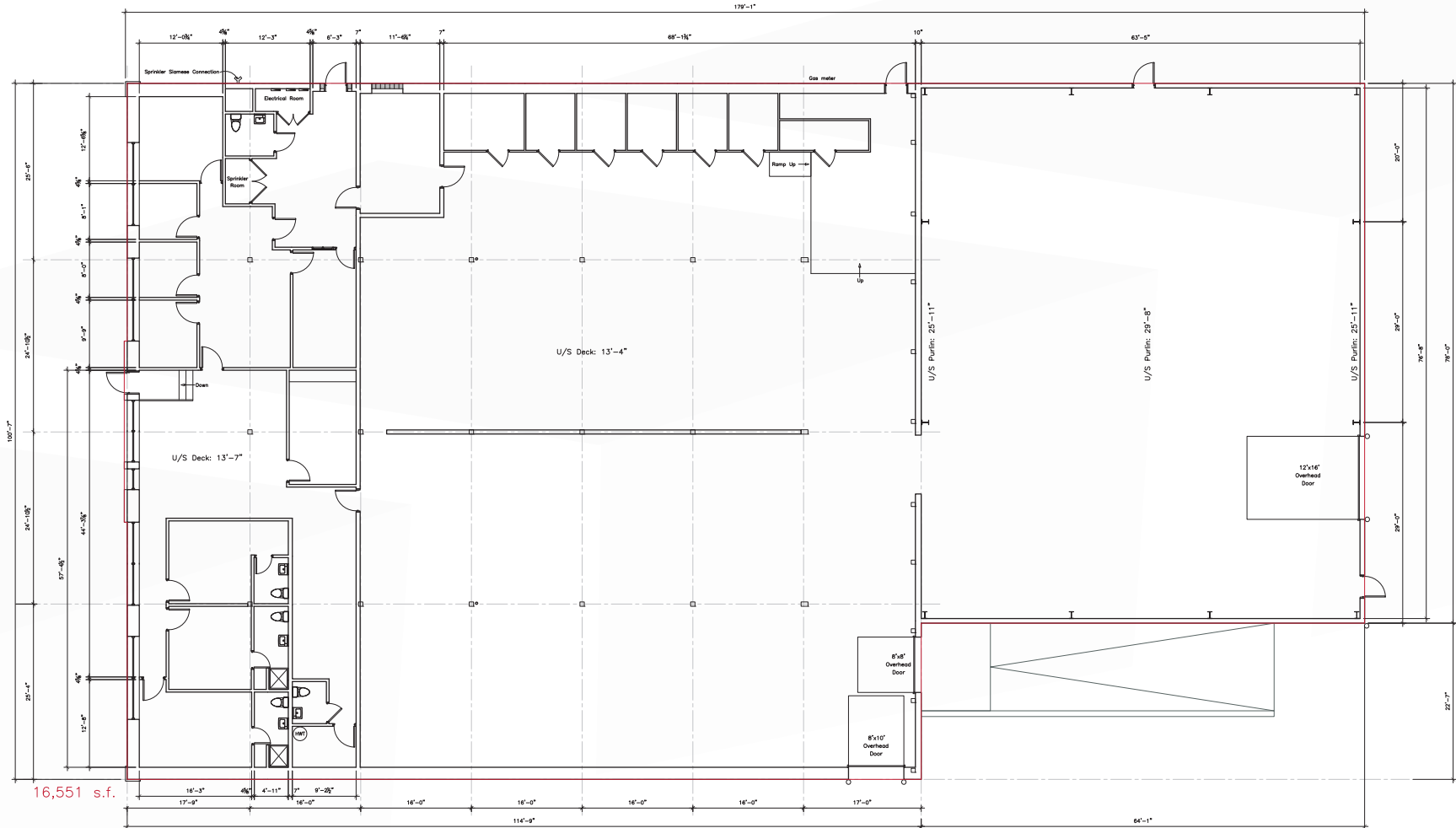

INTERIOR PHOTOS

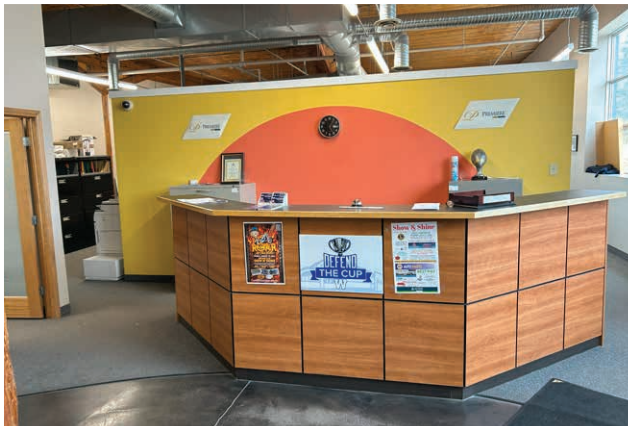

CENTREPORT CANADA

CN RAIL LINE

CP RAIL LINE

Industrial
Manufacturing
&
Logistics

CentrePort
Canada
Rail Park

Strategic
Development

Future
Residential

CP RAIL LINE

MURRAY IND.



WINNIPEG
RICHARDSON
INTERNATIONAL AIRPORT

NORTH INKSTER IND.



INKSBROOK IND. PK.



NORTHWEST BUS. PK.



INKSTER IND. PK.



INKSTER BOULEVARD

OAK POINT IND.



WESTON SHOPS



SITE

OMAND'S CREEK IND.



ST. JAMES IND.



Pp
POLO PARK

DRIVE TIME ANALYSIS



RICHARDSON INT'L AIRPORT

7 minutes



POLO PARK SHOPPING CENTRE

8 minutes



PORTAGE AND MAIN

11 minutes



CENTREPORT CANADA

11 minutes



CONTACT

ERIC OTT, Associate Vice President, Sales & Leasing

(204) 985-1378

eric.ott@capitalgrp.ca

Services provided by Eric A. Ott Personal Real Estate Corporation

MARIO POSILLIPO, Senior Advisor, Sales & Leasing

(204) 985-1373

mario.posillipo@capitalgrp.ca

CAPITAL COMMERCIAL REAL ESTATE SERVICES INC.

300-570 Portage Avenue, Winnipeg, MB R3C 0G4 | T (204) 943-5700 | F (204) 956-2783 | capitalgrp.ca

Disclaimer: Capital Commercial Real Estate Services Inc. ("Capital") does not accept or assume any responsibility or liability, direct or consequential, for the information set out herein, including, without limitation, any projections, images, opinions, assumptions and estimates obtained from third parties. This information has not been verified by Capital, and Capital does not guarantee the accuracy, correctness and completeness of this information. The recipient of this information should take such steps as the recipient may deem necessary to verify the information in this document prior to placing any reliance upon it. The information may change and any property described in this document may be withdrawn from the market at any time without notice or obligation to the recipient from Capital.