

Warehouse FOR Lease

5821 Limmer Loop,
Hutto Texas, 78634

ASKING PRICE: \$1.25/SQFT
ACRES/SQFT: 1 Acre - 6980 SQFT



COMPASS

Lease Package



LEASE SUMMARY

Located at 5821 Limmer Loop, this expansive 1-acre property offers an unbeatable opportunity for businesses seeking a turnkey solution in a rapidly growing area. Best suited for owner-users, the property boasts excellent visibility from Highway 79, with major companies like Samsung nearby, ensuring you're strategically positioned in a thriving business corridor.

The newly built 5,000 sqft warehouse is a versatile space, perfect for a variety of industrial or business uses. Whether you're looking for manufacturing, distribution, or storage capabilities, the expansive layout provides ample room to configure your operations. In addition to the warehouse, a fully renovated 1,980 sqft detached office offers modern, functional workspaces designed to accommodate your growing team. Updated finishes, natural light, and flexible office configurations make this a highly desirable work environment for any business.

The property is fully fenced and gated, offering security and privacy, while the open 1-acre lot provides abundant parking and room for future growth or additional development. With no deed restrictions and no zoning, you have complete freedom to expand your business or explore investment opportunities.

PROPERTY SUMMARY

Offering Price	\$1,400,000
Land/SqFt	1 Acre, 5000sqft Warehouse, 1980sqft Office
Year Built	2024
Zoning Type	None
Restrictions	None



US 79 - TXDOT 27,000VPD

Samsung

Limmer Loop

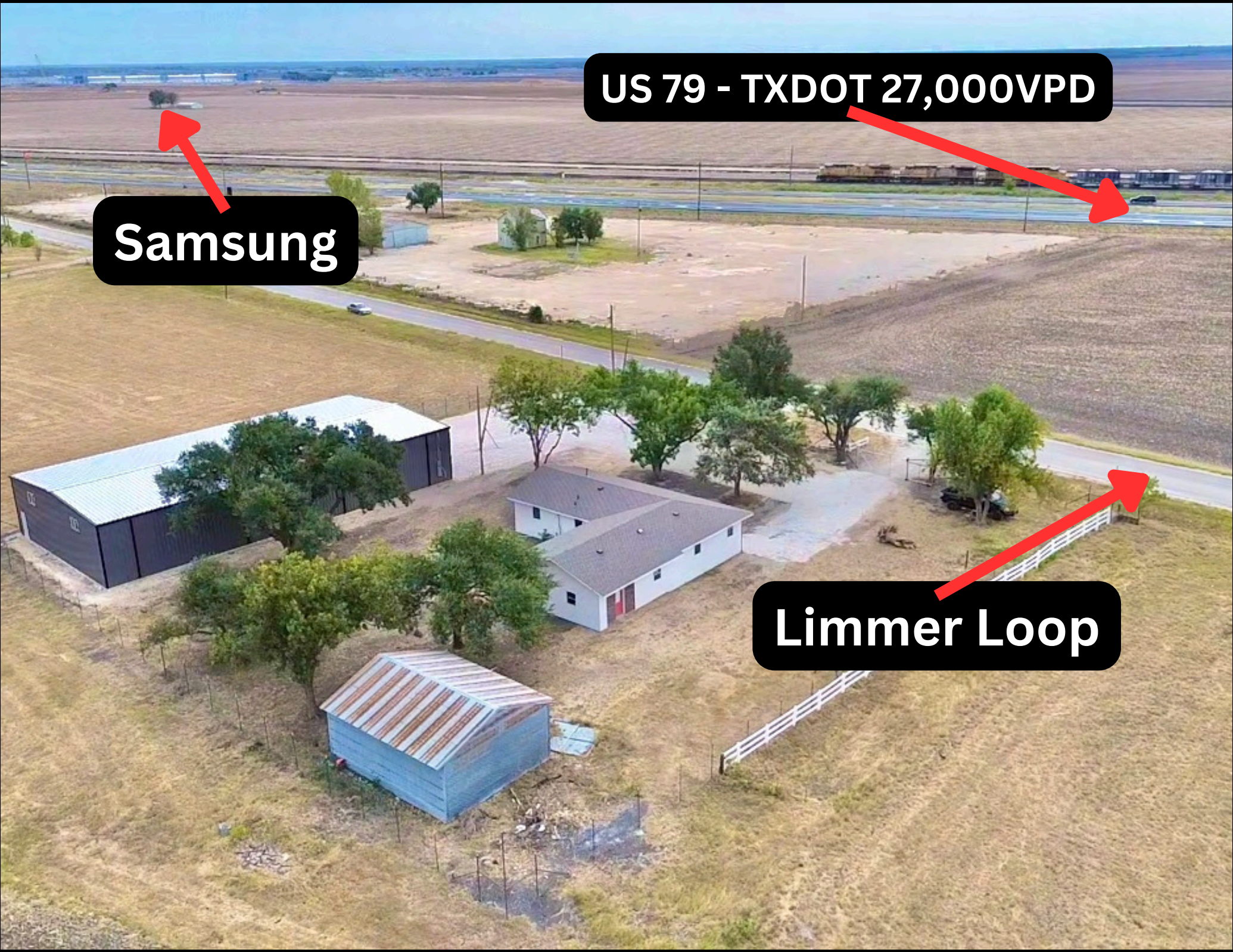







CONFIDENTIALITY STATEMENT

The information contained in the following offering memorandum is proprietary and strictly confidential. It is intended to be reviewed only by the party receiving it from COMPASS and it should not be made available to any other person or entity without the written consent of COMPASS.

By taking possession of and reviewing the information contained herein the recipient agrees to hold and treat all such information in the strictest confidence. The recipient further agrees that recipient will not photocopy or duplicate any part of the offering memorandum. If you have no interest in the subject property, please promptly return this offering memorandum to COMPASS. This offering memorandum has been prepared to provide summary, unverified financial and physical information to prospective purchasers, and to establish only a preliminary level of interest in the subject property. The information contained herein is not a substitute for a thorough due diligence investigation. COMPASS has not made any investigation, and makes no warranty or representation with respect to the income or expenses for the subject property, the future projected financial performance of the property, the size and square footage of the property and improvements, the presence of absence of contaminating substances, PCBs or asbestos, the compliance with local, state and federal regulations, the physical condition of the improvements thereon, or financial condition or business prospects of any tenant, or any tenant's plans or intentions to continue its occupancy of the subject property. The information contained in this offering memorandum has been obtained from sources we believe reliable; however, COMPASS has not verified, and will not verify, any of the information contained herein, nor has COMPASS conducted any investigation regarding these matters and makes no warranty or representation whatsoever regarding the accuracy or completeness of the information provided. All potential buyers must take appropriate measures to verify all of the information set forth herein. Prospective buyers shall be responsible for their costs and expenses of investigating the subject property.

PROPERTY SHOWINGS ARE BY APPOINTMENT ONLY.
PLEASE CONTACT THE COMPASS ADVISOR FOR MORE DETAILS.

EXCLUSIVELY PRESENTED BY:
ANZELL ZAPATERO



Realtor
Mobile: 7374440777
anzell.zapatero@compass.com
License #: 755082

COMPASS

Compass

2500 Bee Cave Rd
Westlake Hills, TX 78746

Office: (512) 575-3644