

# 580 THIRD STREET BUSINESS PARK

580 3RD STREET, LAKE ELSINORE, CALIFORNIA 92530

FOR LEASE

+/- 1,430 SF - +/-1,500 SF  
INDUSTRIAL SPACE

**NEW YEAR PROMO!**

FOR NEW LEASES SIGNED BY 1/31/2025:

\*50% DISCOUNT ON 1ST

6 MONTH'S BASE RENT OAC

\*\*\$1 SF BROKER BONUS

\*\*\*PROMO AVAILABLE ONLY FOR  
APPROVED CREDIT TENANT SIGNING  
A 3 YEAR LEASE TERM\*\*\*



FOR MORE INFORMATION, PLEASE CONTACT:

**CAREY PASTOR** | Senior Vice President

(951) 297-7434 | [cpastor@cbsocalgroup.com](mailto:cpastor@cbsocalgroup.com)

CalDRE License # 01403298



**COLDWELL  
BANKER  
COMMERCIAL  
SC**

# 580 THIRD STREET BUSINESS PARK

580 3RD STREET, LAKE ELSINORE, CALIFORNIA 92530

**FOR LEASE**  
+/- 1,430 SF - +/-1,500 SF  
**INDUSTRIAL SPACE**

## PROPERTY HIGHLIGHTS

- Small industrial space for lease
- Reception area, 1 private office, balance of space is warehouse with front loading roll up door
- M-1 zoning – City of Lake Elsinore
- Close proximity to I-15 free via Central Avenue, on/off ramp
- Located near a number of new retail and restaurants including: Lowe's, The Home Depot, Costco, Chili's Wendy's, Panda Express, Target, Marshalls, Panera, and more



# 580 THIRD STREET BUSINESS PARK

580 3RD STREET, LAKE ELSINORE, CALIFORNIA 92530

**FOR LEASE**  
 +/- 1,430 SF - +/-1,500 SF  
**INDUSTRIAL SPACE**

## AVAILABILITY

UNIT	UNIT SIZE	MONTHLY RENTAL RATE	DESCRIPTION
G	±1,430 SF	\$1,716.00 Base Rent + \$787.00 CAOE Per month*	Reception area, 1 private office, 1 restroom, warehouse with roll up door.
H	±1,500 SF	\$1,800.00 Base Rent + \$825.00 CAOE Per month*	Reception area, 1 restroom, warehouse with roll up door.

\* 2024 Common Area Operating Expenses (CAOE) are estimated and subject to annual reconciliation and adjustment

## SITE PLAN

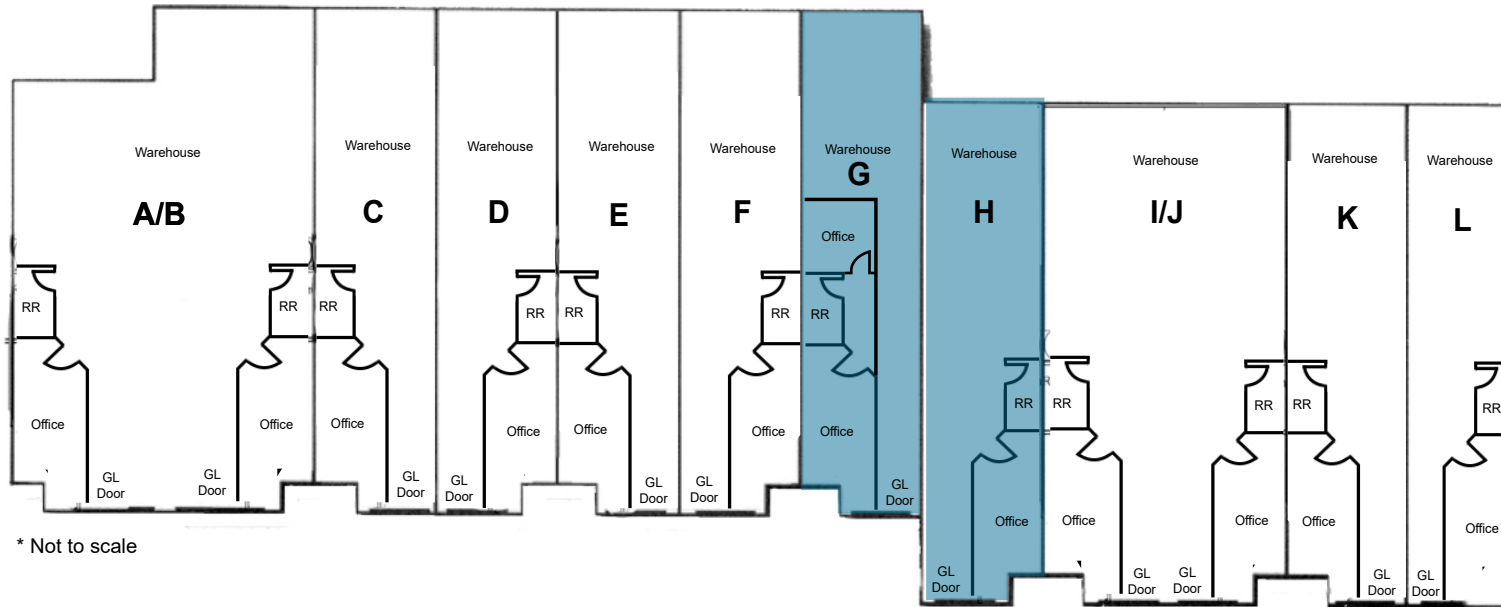

\* Not to scale

## Typical Floor Plan

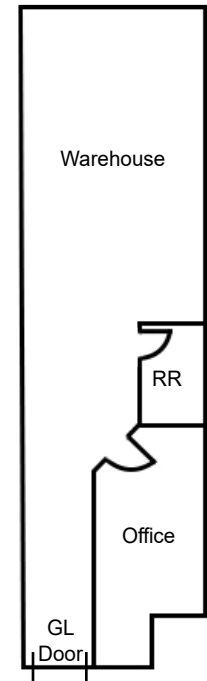

\* Not to scale

# 580 THIRD STREET BUSINESS PARK

580 3RD STREET, LAKE ELSINORE, CALIFORNIA 92530

FOR LEASE  
+/- 1,430 SF - +/-1,500 SF  
INDUSTRIAL SPACE



# 580 THIRD STREET BUSINESS PARK

580 3RD STREET, LAKE ELSINORE, CALIFORNIA 92530

**FOR LEASE**  
+/- 1,430 SF - +/-1,500 SF  
**INDUSTRIAL SPACE**



**FOR MORE INFORMATION, PLEASE CONTACT:**

**CAREY PASTOR**

Senior Vice President

951.297.7434

[cpastor@cbcsocalgroup.com](mailto:cpastor@cbcsocalgroup.com)

CalDRE # 01403298

27368 Via Industria | Suite 102  
Temecula | California | 92590  
t 951.200.7683 | f 951.239.3147  
[cbcsocalgroup.com](http://cbcsocalgroup.com)

