



For Lease: Retail / Office / Flex Space

1230 Congress Street, Portland ME

Property Highlights

- Up to 11,189± SF of office, food & beverage and banquet space
- In close proximity to the Maine Turnpike I-295, Thompon's Point and Downtown Portland
- Private entrance and pylon signage opportunity on Congress St.
- Professionally managed property and hotel

PORTA & CO. | 30 Milk Street, Second Floor | Portland, ME 04101 | (207)-747-1515

www.portacompany.com

Landlord	Olympia Equity Investors I, LP
Lot Size	4.8± Acres
Building Size	91,868± SF
Available Space	Up to 11,189± SF
Year Built	1973
Sprinkler	Full wet system
Zoning	B2
Utilities	Public water and sewer
Parking	Ample on-site
Lease Rate	\$15.00 / SF MG



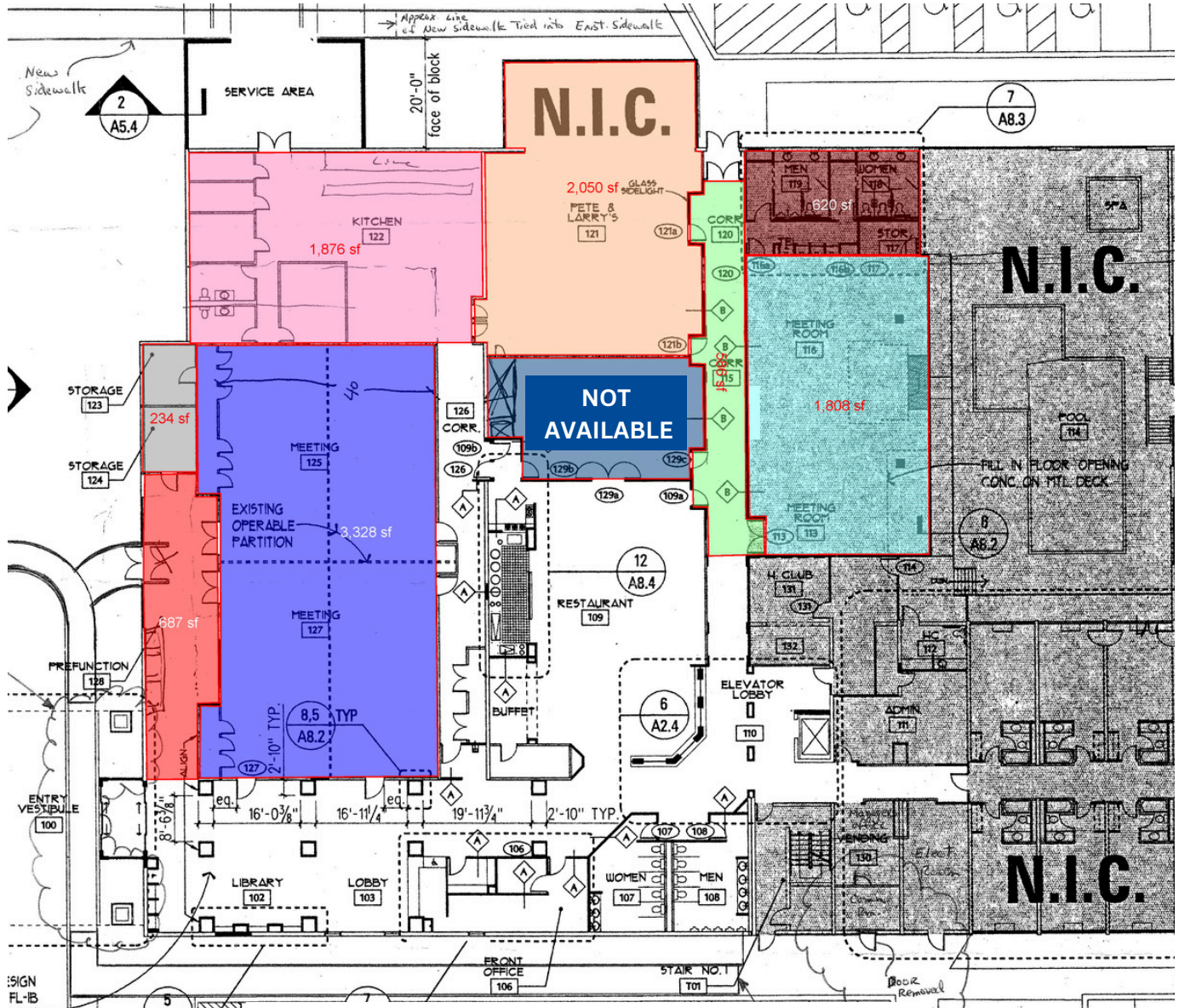

Clarion Ground Floor Measurements (sf)		
Name	Room #	SF
Kitchen	122	1,876
Pete & Larry's	121	2,050
Dining Room	129	820
Large Meeting Room	125, 127	3,328
Meeting Room	113, 116	1,808
Restroom	117, 118, 119	620
Storage	123, 124	234
Prefunction	128	687
Right Corridor	115, 120	586
Total		12,009



CONTACT

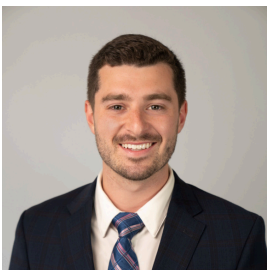

Emmett Peoples

Associate

C: 207-400-4939

O: 207-747-1515

epeoples@portacompany.com

This information has been obtained from sources believed reliable and is intended for informational use only. The information contained herein has not been verified for accuracy or completeness. It is recommended that prospective tenants and buyers conduct their own inspection of the property and verify all information. Any reliance on this information is solely at your own risk. Photos herein are the property of their respective owners. Use of these images without the express written consent of the owner is prohibited.

PORTA & CO.

COMMERCIAL REAL ESTATE

30 Milk Street, Second Floor

Portland, ME 04101

207-747-1515

www.portacompany.com