

FINISH SCHEDULE / LEGEND

NOTE: SEE INTERIOR ELEVATIONS FOR EXTENT OF FINISHES

FLOOR	
F1	CLEAR SEALED CONCRETE
F2	TINTED SEALED EPOXY CONCRETE

BASIS OF DESIGN:

BASE	
B1	4" RUBBER BASE
B2	CONTINUE ADJACENT WALL TILE TO FLOOR. CAULK JOINT.

WALL	
W1	FINISHED PAINT READY GYPSUM BOARD. WORK WITH TENANT FOR FINAL PAINT AND ARTWORK UP TO 15'-0" AND ABOVE TO BE PAINTED EXPOSED BLACK.
W2	PAINTED GYPSUM BOARD - BLACK
W3	CERAMIC 3/8" SUBWAY TILE UP TO 4'-0"
W4	STAINLESS STEEL PANELS, UP TO HOOD
W5	FIBERGLASS REINFORCED PANELS UP TO CEILING, BLACK

BASIS OF DESIGN:

WALL FURNISHINGS LEGEND

NOTE: SEE INTERIOR ELEVATIONS FOR EXTENT OF FINISHES

A	SEE INT. ELEVATIONS	55" TELEVISION
B	---	---

NOTE: COORDINATE FINAL LOCATION WITH OWNER AND ARCHITECT PRIOR TO INSTALLATION

WALL TYPE LEGEND

A		WALL TYPE A FROM EXTERIOR TO INTERIOR 1. 8" GYPSUM BOARD 2. 3/8" METAL STUD, 18" O.C. 3. SOUND ATTENUATION BATTS 4. 5/8" GYPSUM BOARD
B		WALL TYPE B FROM EXTERIOR TO INTERIOR 1. 1/2" STAINLESS STEEL PLATE, 10" TALL
C		WALL TYPE B FROM EXTERIOR TO INTERIOR 1. 1/2" FIBER-REINFORCED PLASTIC, 10" TALL

GENERAL NOTES

- WALL TYPES DO NOT ADDRESS TILE LOCATIONS. SEE INTERIOR ELEVATIONS FOR TILE LOCATIONS. GYPSUM BOARD IN RESTROOMS AND BEHIND ALL TILE SHALL BE 5/8" TYPE X AND RATED AS CODE COMPLIANT TILE BACKER (GERRISIA PACIFIC, DENSIFIELD OR EQUAL).
- ALL COMPONENTS NOTED AS AIR BARRIERS SHALL MEET THE REQUIREMENTS OF ASTM E 2207, ASTM E 3307, ASTM E 107, ASTM E 283 OR E 1880 AND COMPLY WITH SECTION 8.4.3.1.2 ASHRAE 90.1 2013 OR IECC 2015 AS FOLLOWS. THE FOLLOWING AREAS OF THE CONTINUOUS AIR BARRIER IN THE BUILDING ENVELOPE SHALL BE WRAPPED, SEALED, CAULKED, GASKETED, OR TAPPED IN AN APPROVED MANNER TO MINIMIZE AIR LEAKAGE:
 - JOINTS AROUND FENESTRATION AND DOOR FRAMES (BOTH MANUFACTURED AND SITE-BUILT).
 - JUNCTIONS BETWEEN WALLS AND FLOORS, BETWEEN WALLS AT BUILDING CORNERS, BETWEEN WALLS AND ROOFS OR CEILING.
 - PENETRATIONS THROUGH THE AIR BARRIER IN BUILDING ENVELOPE ROOFS, WALLS, AND FLOORS.
 - BUILDING ASSEMBLIES USED AS DUCTS OR PLenums.
- JOINTS, SEAMS, CONNECTIONS BETWEEN PLANES, AND OTHER CHANGES IN AIR BARRIER MATERIALS.
- EXTEND WALLS TO UNDERSIDE OF DECK ABOVE, UNLESS OTHERWISE NOTED. CONTRACTORS OPTION TO FILL METAL DECK VOIDS WITH MINERAL WOOL INSULATION OR FIELD CUT GYP. BOARD INTO FLUTES.
- SEE FURNISHING PLANS FOR EXTENT OF FINISHES.

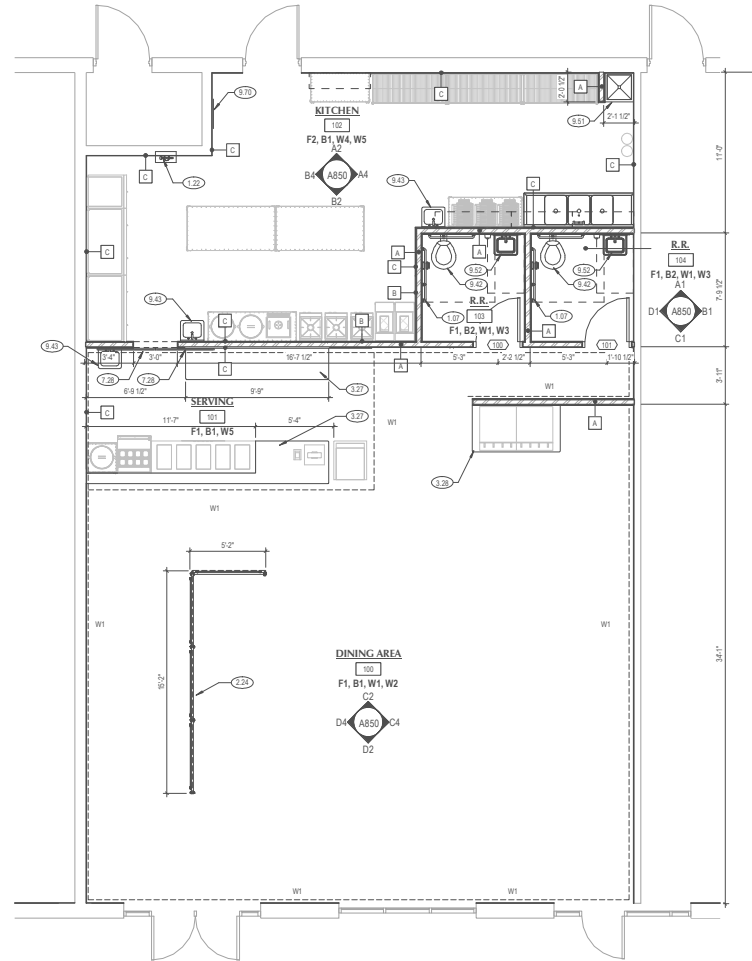

MAIN FLOOR PLAN
A101 | SCALE: 1/4" = 1'-0"

MARK	REVISION	DATE

SHEET NOTES

- ADA COMPLIANT 42" HORIZONTAL, 36" HORIZONTAL, & 18" VERTICAL GRAB BARS AT TOILET. SEE DETAILS.
- 224 42" TALL GALVANIZED PIPE RAILING WITH PERFORATED STEEL PANELS.
- 327 ARCHITECTURAL MILLWORK. SEE FURNISHING PLANS, INTERIOR ELEVATIONS AND SPECIFICATIONS.
- 328 ARCHITECTURAL MILLWORK, BELOW SINK MACHINE. FOR INTERIOR OF CABINET. LINE CUT HOLE WITH STAINLESS STEEL VERIFY CABINET/COUNTER TOP MATERIAL PER HEALTH CODE WITH TENANT.
- 728 50" TELEVISIONS MOUNTED ABOVE OPENING. COORDINATE WITH OWNER.
- 942 TOILET. SEE PLUMBING SHEETS.
- 943 SINK. SEE PLUMBING SHEETS.
- 951 MOP SINK. SEE PLUMBING SHEET.
- 952 SINK WITH 24" X 36" MIRROR. SEE PLUMBING SHEETS.
- 970 ELECTRICAL PANEL. SEE ELECTRICAL.

GENERAL NOTES

- ALL COLOR SELECTIONS, FINISH MATERIALS AND STYLES SHALL BE COORDINATED WITH OWNER.
- MILLWORK SHOWN FOR CLARITY. PROVIDE FLOORING UNDER EQUIPMENT, MILLWORK AND COUNTERTOPS.
- SEE INTERIOR ELEVATIONS & MILLWORK DETAILS FOR FINISHES OF MILLWORK BASES AND COUNTERTOPS.
- SEE ELECTRICAL SHEETS FOR LOCATIONS OF OUTLETS, SWITCHES, DATA, TELEPHONE, TELEVISION, INTERCOMS, CLOCKS, SPEAKERS, HORNS, STROBES, ETC.
- PROVIDE 3" DIAMETER HOLE THRU COUNTER TOP AT ALL POWER AND DATA OUTLETS BELOW CABINET. PROVIDE 3/4" PVC ELBOW AROUND OPENING. COORDINATE WITH ELECTRICAL SHEETS. DRILL OPENING AFTER MILLWORK HAS BEEN INSTALLED FOR ACCURATE LOCATION WITH ELECTRICAL.
- FINAL LOCATION OF ALL RESTROOM EQUIPMENT TO BE COORDINATED WITH OWNER PRIOR TO INSTALLATION.
- CHAMFER ALL EXPOSED CORNERS ON COUNTERTOPS.
- PROVIDE STAINLESS STEEL CORNER GUARDS AT ALL DRYWALL CORNERS PER DETAIL.
- PROVIDE SPLITTER TRIM PIECE ON ALL EXPOSED TILE EDGES AND EXTERIOR CORNERS PER DETAILS.
- ALL ROOMS TO RECEIVE ROOM SIGNS AT EACH ENTRY INTO SPACE. PLAN FOR APPROPRIATE AMOUNT PER ROOM.
- PROVIDE FLOOR TRANSITION STRIPS AT ALL FLOOR MATERIAL TRANSITIONS PER DETAILS.

GENERAL NOTES

- GENERAL CONTRACTOR SHALL VERIFY ALL CONDITIONS AND DIMENSIONS PRIOR TO CONSTRUCTION. REPORT ANY SIGNIFICANT DISCREPANCIES TO THE ARCHITECT.
- COORDINATE INSTALLATIONS OF ALL UTILITY CONTRACT ASSEMBLIES WITH OWNER PRIOR TO CONSTRUCTION OF ADDING OR RELATED STRUCTURES.
- PROVIDE 18" MINIMUM CLEAR FLOOR SPACE AT FULL SIDE OF ALL DOORS. PROVIDE 12" MINIMUM CLEAR FLOOR SPACE AT PUSH SIDE OF ALL DOORS.
- FOR ALL METAL STUD WALLS THAT EXTEND TO BOTTOM OF ROOF DECK & WHERE METAL STUD WALLS CUT PERPENDICULAR THROUGH ROOF TRUSSES, SEE DETAILS.
- WALLS TO EXTEND TO BOTTOM OF ROOF DECK ABOVE UNLESS OTHERWISE NOTED.
- FILL VOIDS BETWEEN SEPARATION WALLS AND ROOF DECK WITH FIBERGLASS SPRAY INSULATION. SEE SPECS.
- FOR CLARITY, ONLY THE MILLWORK WITH PLUMBING FIXTURES IS SHOWN ON FLOOR PLANS. SEE FURNISHINGS AND INTERIOR ELEVATION PLANS FOR FULL EXTENT OF MILLWORK BASES, AND COUNTERTOPS.
- GENERAL CONTRACTOR SHALL REVIEW AND APPROVE ALL APPLIANCES WITH OWNER PRIOR TO PURCHASING EQUIPMENT AND FABRICATING MILLWORK.
- PROVIDE BACKING/BLOCKING FOR WALL MOUNTED ITEMS INCLUDING GRAB BARS, HANDRAILS, SIGNAGE AND EQUIPMENT AS REQUIRED.
- TILE IS TO BE SET OVER CEMENTITIOUS BACKER BOARD UNDERLAYMENT. RECESS SLAB AS IF REQUIRED. VERIFY WITH OWNER.

<p>323 SOUTH PLAZARD DRIVE RENO, NV 89502</p> <p>PHONE: 866.178.3300 info@curtisminer.com</p>	DATE: APRIL 2, 2021 PROJECT #: CMA 20-078 PROJ. MAN.: CLL CHECKED BY: CLL
	PROJECT: CUPBOP TENANT IMPROVEMENT PROJECT ADDRESS: 1100 S. FORT APACHE RD., SUITE 120 LAS VEGAS, NEVADA 89117 OWNER: CUPBOP
SHEET DESCRIPTION: MAIN FLOOR PLAN SHEET: A101	