

NOTE:

- 1.UNAUTHORIZED ALTERATION OR ADDITION TO THIS SURVEY IS A VIOLATION OF SECTION 7209 OF THE NEW YORK STATE EDUCATION LAW.
- 2.COPIES OF THIS SURVEY MAP NOT BEARING THE LAND SURVEYOR'S INKED SEAL OR EMBOSSED SEAL SHALL NOT BE CONSIDERED TO BE A VALID TRUE COPY.
- 3.CERTIFICATION INDICATED HEREON SHALL RUN ONLY TO THE PERSON FOR WHOM THE SURVEY IS PREPARED, AND ON HIS BEHALF TO THE TITLE COMPANY, GOVERNMENTAL, AGENCY AND LENDING INSTITUTION LISTED HEREON AND TO THE ASSIGNEES OF THE LENDING INSTITUTION, **CERTIFICATIONS ARE NOT TRANSFERABLE TO ADDITIONAL INSTITUTIONS OR SUBSEQUENT OWNERS**
- 4.UNDERGROUND IMPROVEMENTS OR ENCROACHMENTS, IF ANY, ARE NOT SHOWN HEREON.

CERTIFIED TO:

1. BAGATELLE ROAD CORP.
2. GOLD STAR ABSTRACT
3. FIRST AMERICAN TITLE INSURANCE COMPANY

**CSE** CONSTRUCTION  
LAND SURVEYING  
61-04 79th STREET  
MIDDLE VILLAGE NY 11379  
TELEPHONE (347) 924-6304  
SUWALAPLS@GMAIL.COM  
WWW.CSESUWALA.COM

MELVILLE  
TOWN OF HUNTINGTON  
COUNTY OF SUFFOLK  
STATE OF NEW YORK  
DISTRICT 0400  
SECTION 273.00  
BLOCK 03.00  
LOT 060.000, 063.000, 064.000

DATE: JANUARY 3, 2023

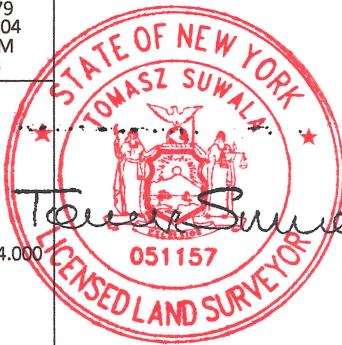

TOMASZ SUWALA, LS NYS #051157