

MENLO BUSINESS PARK



2380

2360

**FRANK COX** 408.982.8422  
frank.cox@nrmk.com CA RE License #00889881

**NEWMARK**

SAN JOSE, CA  
AVAILABILITY SUMMARY  
**±2,531 SF & ±5,651 SF**

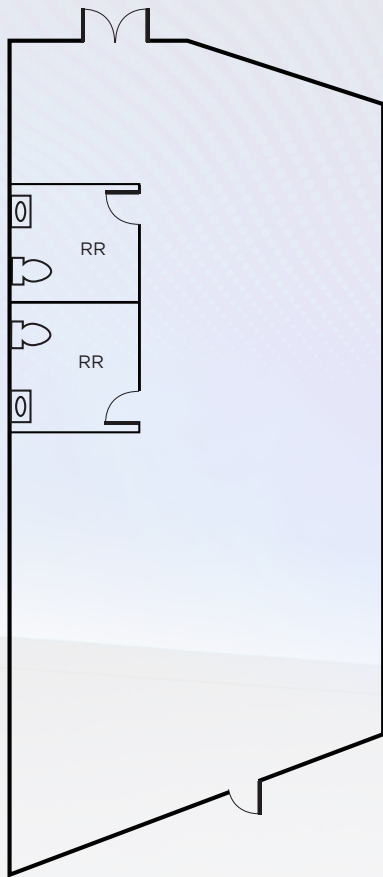

(Floorplan Not to Scale)

2362 QUME DRIVE | SUITE G:  
**±2,531 SQUARE FEET**

- Shell Condition
- 100% Office Area
- Interior to Suit
- Two (2) Restrooms
- Corner Unit with Great Glassline
- Sprinklered
- Call to Tour
- Available Now



2360 QUME DRIVE | SUITE E&F:

**±5,651 SQUARE FEET**

- ±50% Office Area
- ±50% Assembly/Warehouse Area
- 100% HVAC
- Six (6) Private Offices
- Open Office Area
- Conference Room
- Kitchenette
- Two (2) Restrooms
- One (1) Grade Level Truck Door
- Call to Tour
- Available 10/1/2024

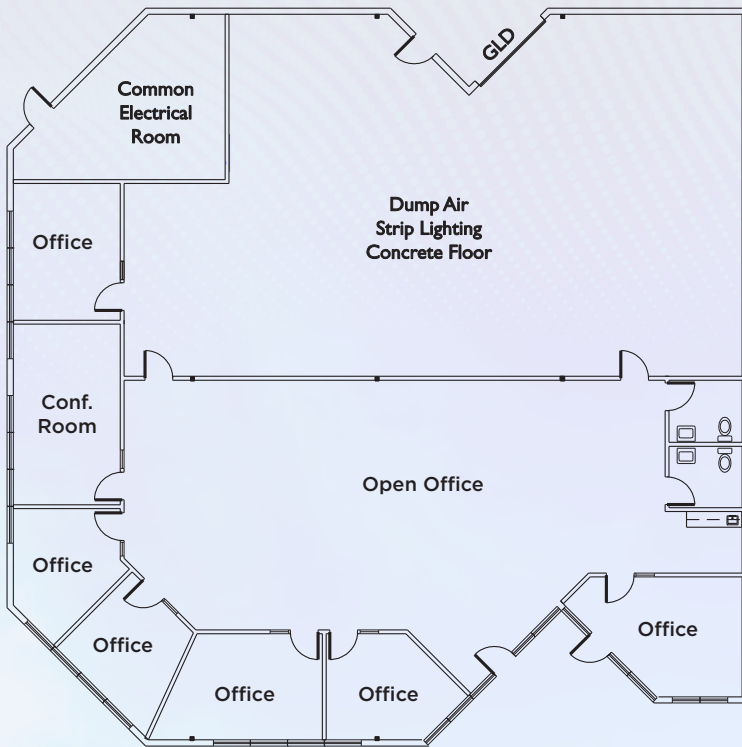

(Floorplan Not to Scale)



# SITE PLAN

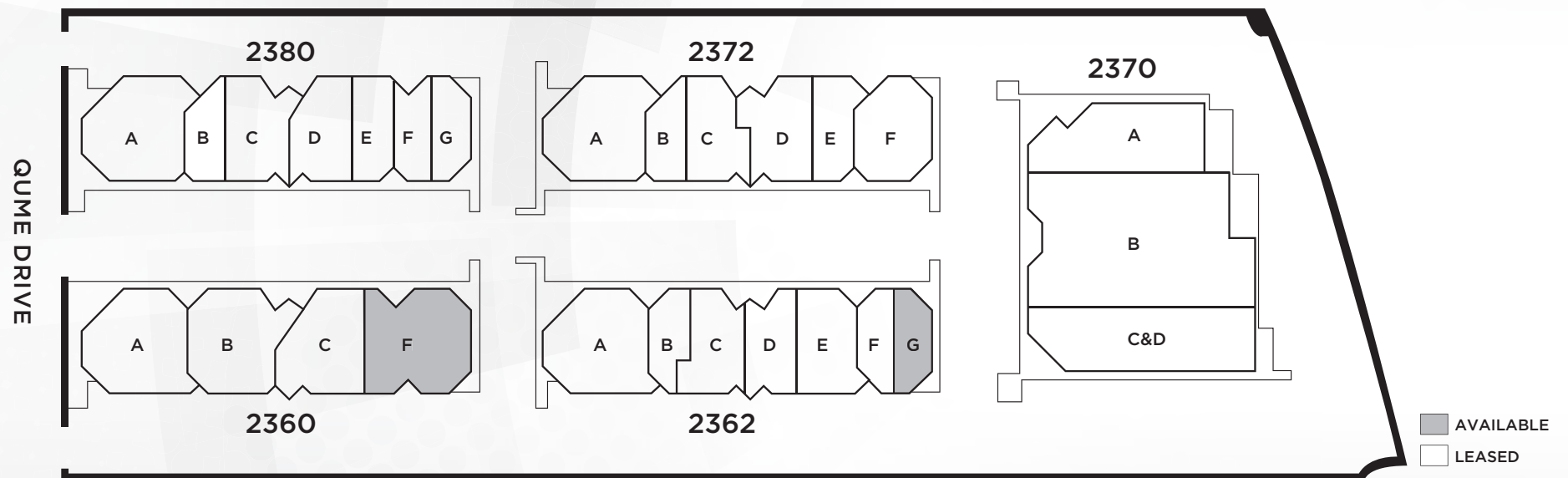

# LOCATION MAP

## MILPITAS

## SANTA CLARA

## SAN JOSE



**MENLO BUSINESS PARK**  
SAN JOSE, CA

**FRANK COX** | 408.982.8422  
frank.cox@nrmk.com | CA RE License #00889881



3055 Olin Avenue, Suite 2200, San Jose, CA 95128

The distributor of this communication is performing acts for which a real estate license is required. The information contained herein has been obtained from sources deemed reliable but has not been verified and no guarantee, warranty or representation, either express or implied, is made with respect to such information. Terms of sale or lease and availability are subject to change or withdrawal without notice. MP-874 • 08/24