



WOODCREST
CAPITAL, LLC

White Pines

1002-1012 E Main St | Cherryville NC

LEASING
(817) 927-0050

Restaurant
Retail
Office
Medical

AVAILABLE

7,500 - 40,120 SF



- 47,620 SF Center
- Gaston County, North Carolina
- Charlotte Metropolitan Area
- Large Parking Field
- Great Visibility & Access

Type	PSF
NNN's	\$ 2.42
Lease Rates	Call for Rates

Traffic Counts	
E Church St	15,239 VPD
E Main St	5,858 VPD



Demographics	1-mile*	3-mile	5-mile	True Trade Area**
Population	1,142	9,367	21,056	111,112
Households	487	3,712	8,132	42,923
Average HH Income	\$62,597	\$62,499	\$64,745	\$67,209

* 1, 3, and 5 mile radius data provided by Placer.ai using the STI: PopStat 2022 dataset

** True Trade Area values reflect the aggregate demographic data of the most prevalent Census Block Groups providing 80% of the actual traffic seen at the center from 3/1/2022-2/28/2023 as calculated by Placer.ai using the STI: PopStats 2022 dataset.

Woodcrest Capital, LLC
3113 South University Drive, Suite 600
Fort Worth, TX 76109

The information contained herein has been given to us by the owner of the property or other sources we deem reliable. We have no reason to doubt its accuracy, but we do not guarantee it. All information should be verified prior to purchase or lease.

(817) 927-0050 | woodcrestcapital.com

White Pines

1002-1012 E Main St | Cherryville NC

Woodcrest Capital, LLC

3113 South University Drive, Suite 600
Fort Worth, TX 76109

WHITE PINES | Cherryville, North Carolina

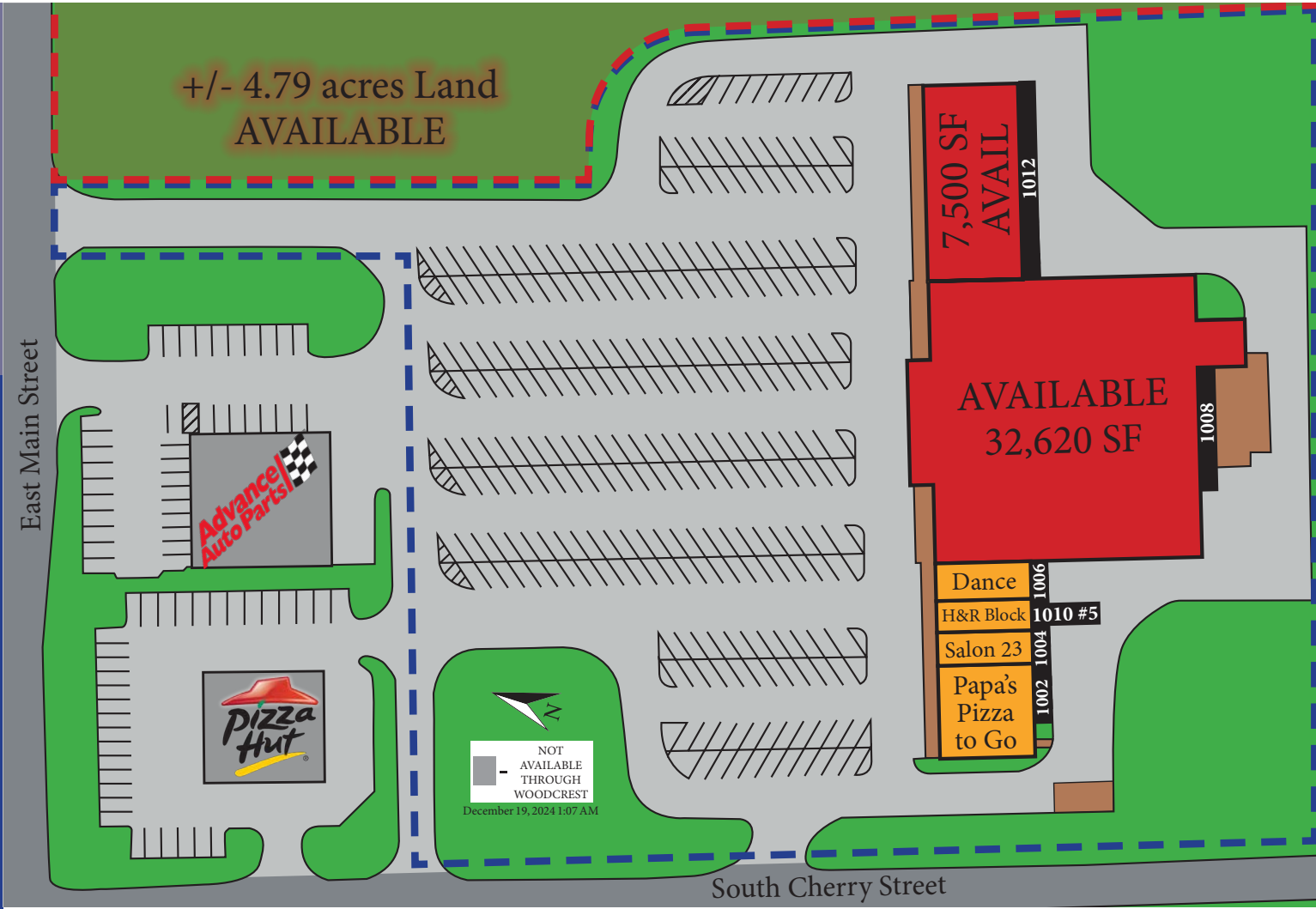

(817) 927-0050 | woodcrestcapital.com