

LEASE

2105-2111 BAYLESS BLVD.

2105 Bayless Blvd. Daytona Beach, FL 32114



Lease Rate	\$8.00 SF/YR
------------	---------------------

OFFERING SUMMARY

Building Size:	86,000 SF
Available SF:	53,700 SF
Lot Size:	7.2 Acres
Year Built:	1975
Renovated:	2010
Zoning:	M-4
Market:	East Central Florida
Submarket:	Daytona Beach

PROPERTY OVERVIEW

Desirable industrial warehouse uses... Heavy power, A/C climate controlled space, 18 ft. ceiling heights with on-grade and dock high doors, with open lay down area available. Well maintained with many upgrades in recent years. Can subdivide into 28,700 SF or 25,000 SF.

LOCATION OVERVIEW

This location has easy access to the Daytona International Airport, the I-95 and I-4 exchange and a multitude of other industrial and office headquarter locations including Amazon, Trader Joe's distribution hubs. The subject neighborhood location is in the growth, stable and revitalization stages of development.

PROPERTY HIGHLIGHTS

- M-4 Zoning - Light Industrial
- 18 Ft High Ceilings
- A/C Climate Controlled
- Distribution / Manufacturing / Showroom
- Outside Lay Down Area Available

PROPERTY WEBSITE

[Click Here](#)

Ed Schwarz
386 672 8530



**COLDWELL BANKER
COMMERCIAL
BENCHMARK**

LEASE

2105-2111 BAYLESS BLVD.
2105 Bayless Blvd. Daytona Beach, FL 32114

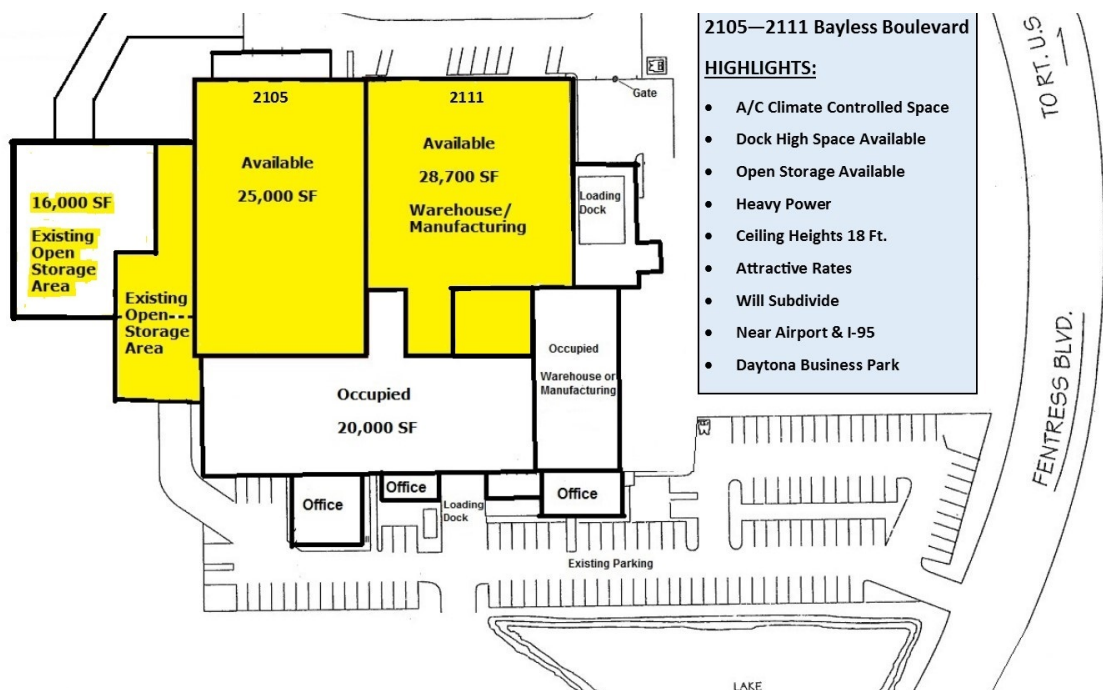

Ed Schwarz
386 672 8530



COLDWELL BANKER
COMMERCIAL
BENCHMARK