

910 GEORGE ST

*±12,148 SF Industrial Warehouse
For Sale in Santa Clara, CA*

TOTAL LAND AREA	±22,913 SF (0.53 acres)
BONUS SPACE	±800 SF bonus mezzanine space
CONSTRUCTION	Concrete tilt-up
POWER	600 A @120/208 V (buyer to verify)
CLEAR HEIGHT	±15.5 - 17.5 ft
LOADING	1 GL and 2 DH
LIGHTING	LED lights throughout
YARD	Secured yard/parking
AMENITIES	5 restrooms, shower & server room
UTILITIES	Low cost Santa Clara electricity
ASKING PRICE	\$4,795,000 (\$395 PSF)

DAVE GEISSBERGER

408.588.2338 | dave.geissberger@kidder.com

LIC N° 01401887

REMINGTON HEATLEY

650.430.1562 | remington.heatley@kidder.com

LIC N° 01907186

KIDDER.COM

This information supplied herein is from sources we deem reliable. It is provided without any representation, warranty, or guarantee, expressed or implied as to its accuracy. Prospective Buyer or Tenant should conduct an independent investigation and verification of all matters deemed to be material, including, but not limited to, statements of income and expenses. Consult your attorney, accountant, or other professional advisor. All Kidder Mathews designs are the sole property of Kidder Mathews. Branded materials and layouts are not authorized for use by any other firm or person.



FOR SALE

FLOOR PLAN

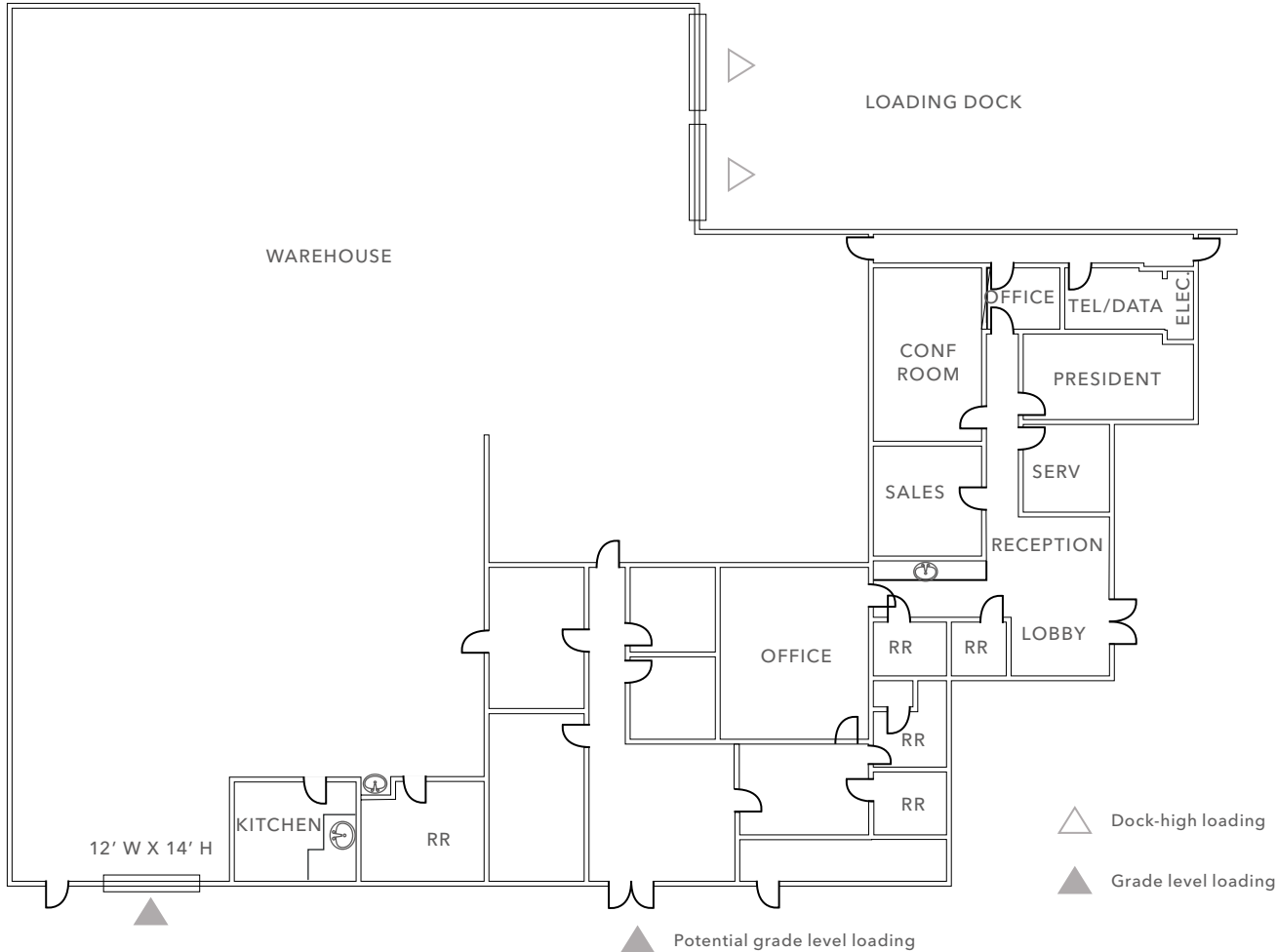

±12,148 SF

AVAILABLE

\$4,795,000

ASKING PRICE

NOW

AVAILABLE

FLOOR PLAN NOT TO SCALE

KIDDER.COM

This information supplied herein is from sources we deem reliable. It is provided without any representation, warranty, or guarantee, expressed or implied as to its accuracy. Prospective Buyer or Tenant should conduct an independent investigation and verification of all matters deemed to be material, including, but not limited to, statements of income and expenses. Consult your attorney, accountant, or other professional advisor. All Kidder Mathews designs are the sole property of Kidder Mathews. Branded materials and layouts are not authorized for use by any other firm or person.



FOR SALE

910 George St benefits from a highly connected locale, with easy access to multiple nearby highways via George St.

Close to public transportation

Conveniently located near major confluences such as Interstate 101

Close to San Jose International Airport

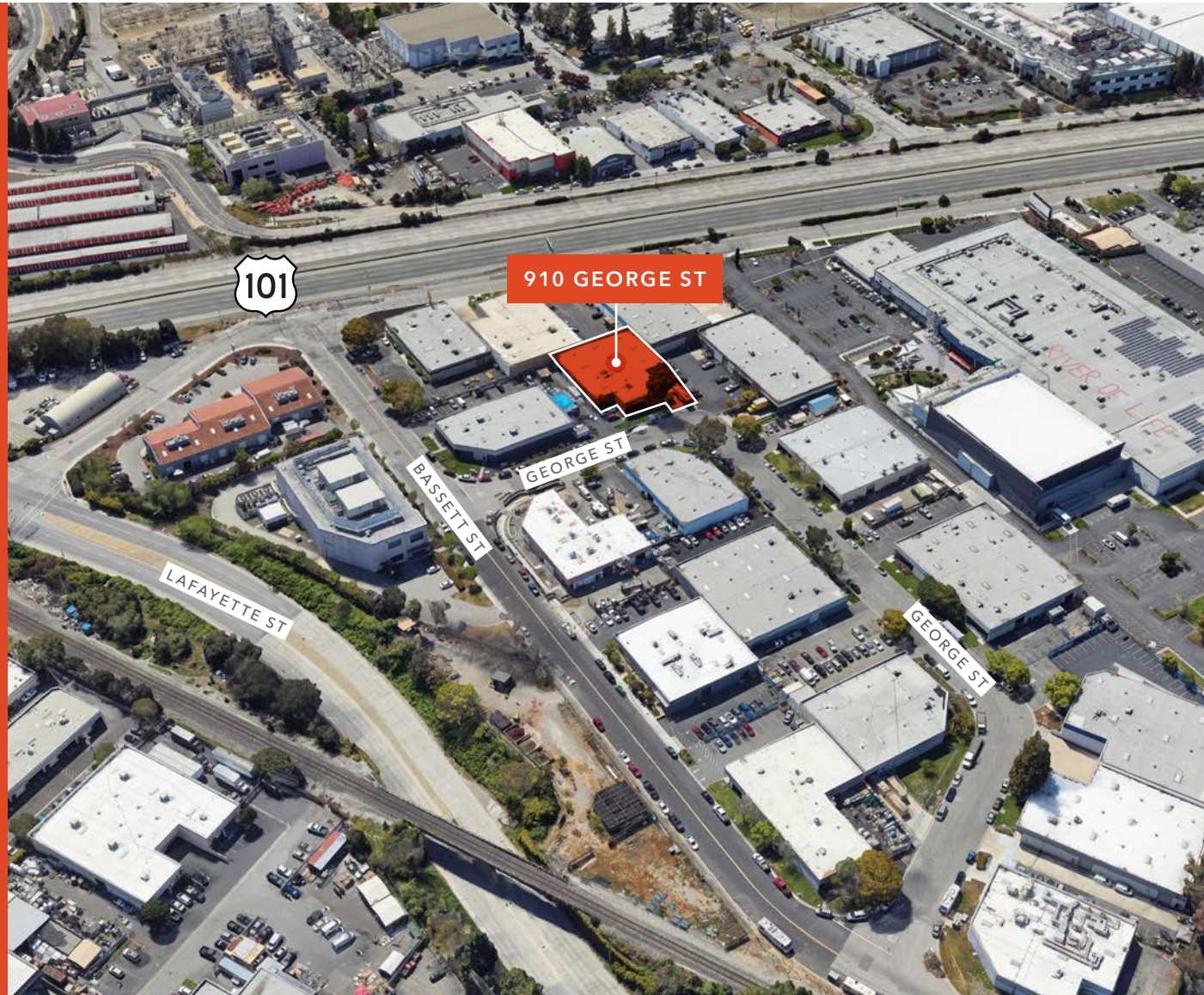

KIDDER.COM

This information supplied herein is from sources we deem reliable. It is provided without any representation, warranty, or guarantee, expressed or implied as to its accuracy. Prospective Buyer or Tenant should conduct an independent investigation and verification of all matters deemed to be material, including, but not limited to, statements of income and expenses. Consult your attorney, accountant, or other professional advisor. All Kidder Mathews designs are the sole property of Kidder Mathews. Branded materials and layouts are not authorized for use by any other firm or person.



FOR SALE



KIDDER.COM

This information supplied herein is from sources we deem reliable. It is provided without any representation, warranty, or guarantee, expressed or implied as to its accuracy. Prospective Buyer or Tenant should conduct an independent investigation and verification of all matters deemed to be material, including, but not limited to, statements of income and expenses. Consult your attorney, accountant, or other professional advisor. All Kidder Mathews designs are the sole property of Kidder Mathews. Branded materials and layouts are not authorized for use by any other firm or person.

 **Kidder
Mathews**



KIDDER.COM

This information supplied herein is from sources we deem reliable. It is provided without any representation, warranty, or guarantee, expressed or implied as to its accuracy. Prospective Buyer or Tenant should conduct an independent investigation and verification of all matters deemed to be material, including, but not limited to, statements of income and expenses. Consult your attorney, accountant, or other professional advisor. All Kidder Mathews designs are the sole property of Kidder Mathews. Branded materials and layouts are not authorized for use by any other firm or person.