

FOR LEASE **AIRWAY SHOPPING CENTER**

4878-4930 Airway Rd & 104-194 Woodman Dr, Dayton, OH 45431



TC Bartoszek
tc@lee-associates.com
D 513.588.1840

Katie Crowl
kcrowl@lee-associates.com
D 513.588.1138

**LEE &
ASSOCIATES**
COMMERCIAL REAL ESTATE SERVICES

All information furnished regarding property for sale, rental or financing is from sources deemed reliable, but no warranty or representation is made to the accuracy thereof and same is submitted to errors, omissions, change of price, rental or other conditions prior to sale, lease or financing or withdrawal without notice. No liability of any kind is to be imposed on the broker herein. The listing agent is also a part owner.

FOR LEASE

AIRWAY SHOPPING CENTER

4878-4930 Airway Rd & 104-194 Woodman Dr, Dayton, OH 45431

AVAILABLE:

Suite 146	9,000 SF	\$14.00 NNN
Suite 164	30,000 SF	\$10.00 NNN
Suite 4912 & 4920	Up to 30,000 SF	\$10.00 NNN

0.52 Acres for Ground Lease

PROPERTY INFORMATION:

- Excellent leasing opportunity in a well-established retail center
- Versatile layout suitable for retail, service, or neighborhood businesses
- High visibility with prominent signage opportunities
- Ample parking and multiple access points for customer convenience
- Flexible space design allows for customization to meet specific business needs
- Steady foot traffic from existing tenants and visitors
- Functional design ideal for a variety of business uses

TRAFFIC COUNTS:

- Airway Road – 16,531 VPD
- Harshman Avenue – 28,515 VPD



SITE PLAN



Airway Shopping Center

26,000 SF FLOOR PLAN – FORMER SALVATION ARMY

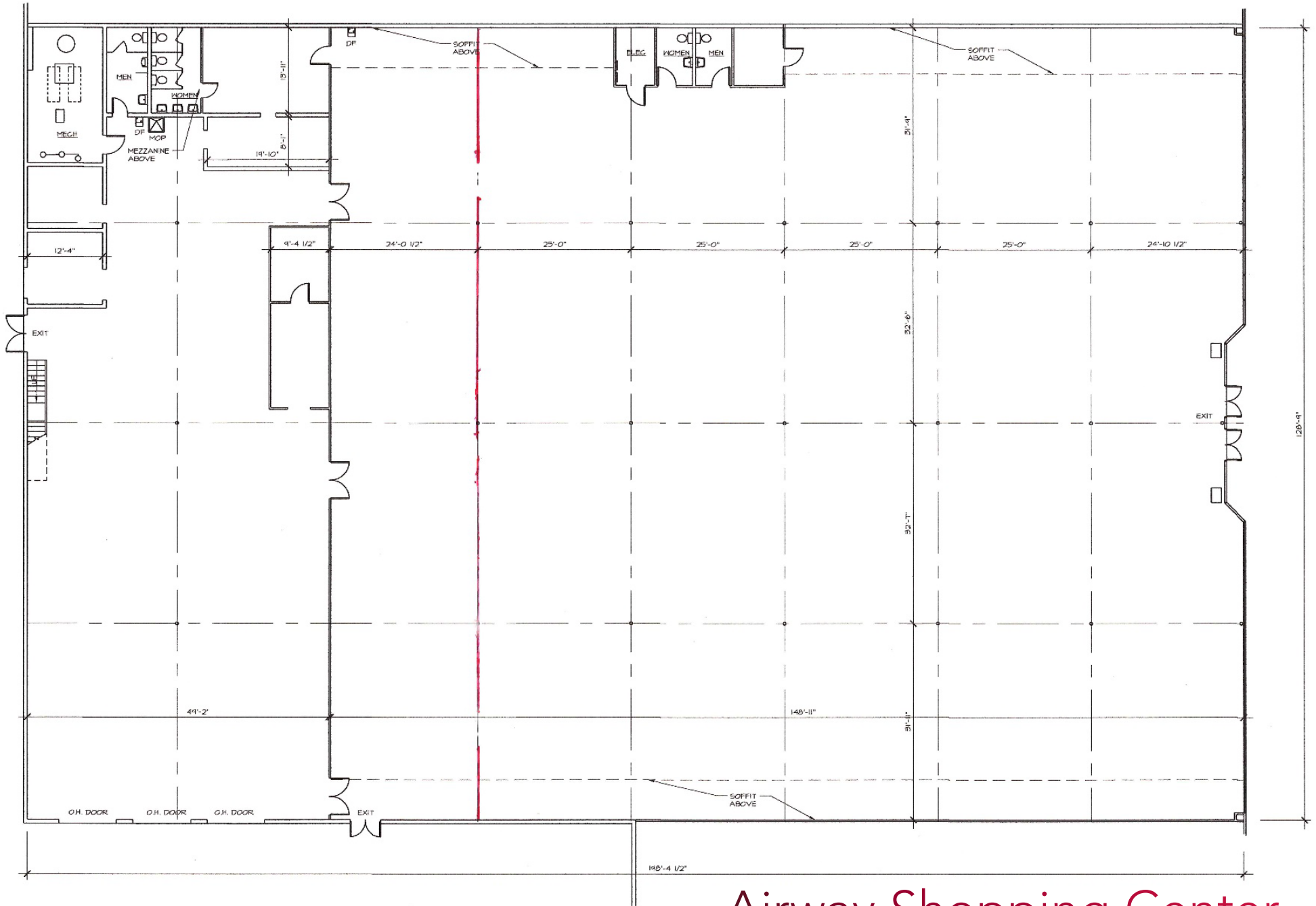

Airway Shopping Center

9,000 SF FLOOR PLAN – FORMER RITE AID

ADJACENT TENANT SPACE



AERIAL PICTURES

AIRWAY SHOPPING CENTER



AERIAL AIRWAY SHOPPING CENTER

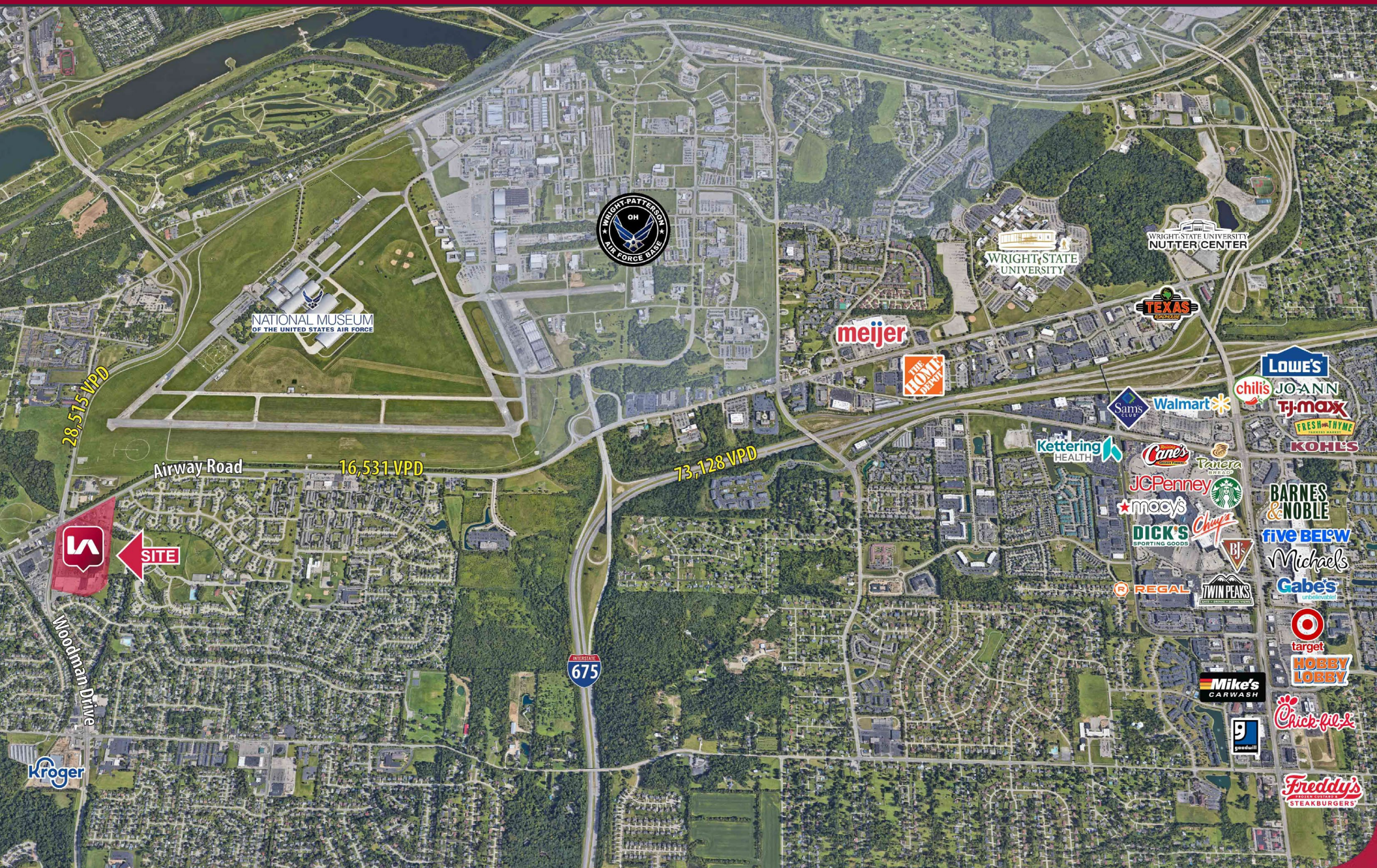

DEMOGRAPHICS

The map displays the Dayton, Ohio area with concentric red circles centered on Riverside, representing 1, 3, and 5-mile radii. Key locations and landmarks include:

- Neighborhoods:** Miami Villa, Northridge, North Riverdale, Kittyhawk, Old North Dayton, McCook Field, Northridge Estates, Northeast Dayton, Pheasant Hill, Forest Ridge, Quail Hollow, Gateway, Wright-Patterson AFB, Wright State University, Wrightview, Eastern Hills, Linden Heights, Shroyer Park, Oakwood, Beavertown, Kettering, Woodbourne-Hyde Park, Zimmerman, Alpha, Fairborn, Pleasant, Chalfant Estates, Park Layne, Med.
- Landmarks:** University of Dayton, Wright State University, Wright-Patterson AFB.
- Highways:** I-75, I-70, I-675, I-4, I-275, I-74, I-76, I-78, I-80, I-90, I-95, I-97, I-99, I-100, I-105, I-110, I-115, I-120, I-125, I-130, I-135, I-140, I-145, I-150, I-155, I-160, I-165, I-170, I-175, I-180, I-185, I-190, I-195, I-200, I-205, I-210, I-215, I-220, I-225, I-230, I-235, I-240, I-245, I-250, I-255, I-260, I-265, I-270, I-275, I-280, I-285, I-290, I-295, I-300, I-305, I-310, I-315, I-320, I-325, I-330, I-335, I-340, I-345, I-350, I-355, I-360, I-365, I-370, I-375, I-380, I-385, I-390, I-395, I-400, I-405, I-410, I-415, I-420, I-425, I-430, I-435, I-440, I-445, I-450, I-455, I-460, I-465, I-470, I-475, I-480, I-485, I-490, I-495, I-500, I-505, I-510, I-515, I-520, I-525, I-530, I-535, I-540, I-545, I-550, I-555, I-560, I-565, I-570, I-575, I-580, I-585, I-590, I-595, I-600, I-605, I-610, I-615, I-620, I-625, I-630, I-635, I-640, I-645, I-650, I-655, I-660, I-665, I-670, I-675, I-680, I-685, I-690, I-695, I-700, I-705, I-710, I-715, I-720, I-725, I-730, I-735, I-740, I-745, I-750, I-755, I-760, I-765, I-770, I-775, I-780, I-785, I-790, I-795, I-800, I-805, I-810, I-815, I-820, I-825, I-830, I-835, I-840, I-845, I-850, I-855, I-860, I-865, I-870, I-875, I-880, I-885, I-890, I-895, I-900, I-905, I-910, I-915, I-920, I-925, I-930, I-935, I-940, I-945, I-950, I-955, I-960, I-965, I-970, I-975, I-980, I-985, I-990, I-995, I-1000, I-1005, I-1010, I-1015, I-1020, I-1025, I-1030, I-1035, I-1040, I-1045, I-1050, I-1055, I-1060, I-1065, I-1070, I-1075, I-1080, I-1085, I-1090, I-1095, I-1100, I-1105, I-1110, I-1115, I-1120, I-1125, I-1130, I-1135, I-1140, I-1145, I-1150, I-1155, I-1160, I-1165, I-1170, I-1175, I-1180, I-1185, I-1190, I-1195, I-1200, I-1205, I-1210, I-1215, I-1220, I-1225, I-1230, I-1235, I-1240, I-1245, I-1250, I-1255, I-1260, I-1265, I-1270, I-1275, I-1280, I-1285, I-1290, I-1295, I-1300, I-1305, I-1310, I-1315, I-1320, I-1325, I-1330, I-1335, I-1340, I-1345, I-1350, I-1355, I-1360, I-1365, I-1370, I-1375, I-1380, I-1385, I-1390, I-1395, I-1400, I-1405, I-1410, I-1415, I-1420, I-1425, I-1430, I-1435, I-1440, I-1445, I-1450, I-1455, I-1460, I-1465, I-1470, I-1475, I-1480, I-1485, I-1490, I-1495, I-1500, I-1505, I-1510, I-1515, I-1520, I-1525, I-1530, I-1535, I-1540, I-1545, I-1550, I-1555, I-1560, I-1565, I-1570, I-1575, I-1580, I-1585, I-1590, I-1595, I-1600, I-1605, I-1610, I-1615, I-1620, I-1625, I-1630, I-1635, I-1640, I-1645, I-1650, I-1655, I-1660, I-1665, I-1670, I-1675, I-1680, I-1685, I-1690, I-1695, I-1700, I-1705, I-1710, I-1715, I-1720, I-1725, I-1730, I-1735, I-1740, I-1745, I-1750, I-1755, I-1760, I-1765, I-1770, I-1775, I-1780, I-1785, I-1790, I-1795, I-1800, I-1805, I-1810, I-1815, I-1820, I-1825, I-1830, I-1835, I-1840, I-1845, I-1850, I-1855, I-1860, I-1865, I-1870, I-1875, I-1880, I-1885, I-1890, I-1895, I-1900, I-1905, I-1910, I-1915, I-1920, I-1925, I-1930, I-1935, I-1940, I-1945, I-1950, I-1955, I-1960, I-1965, I-1970, I-1975, I-1980, I-1985, I-1990, I-1995, I-2000, I-2005, I-2010, I-2015, I-2020, I-2025, I-2030, I-2035, I-2040, I-2045, I-2050, I-2055, I-2060, I-2065, I-2070, I-2075, I-2080, I-2085, I-2090, I-2095, I-2100, I-2105, I-2110, I-2115, I-2120, I-2125, I-2130, I-2135, I-2140, I-2145, I-2150, I-2155, I-2160, I-2165, I-2170, I-2175, I-2180, I-2185, I-2190, I-2195, I-2200, I-2205, I-2210, I-2215, I-2220, I-2225, I-2230, I-2235, I-2240, I-2245, I-2250, I-2255, I-2260, I-2265, I-2270, I-2275, I-2280, I-2285, I-2290, I-2295, I-2300, I-2305, I-2310, I-2315, I-2320, I-2325, I-2330, I-2335, I-2340, I-2345, I-2350, I-2355, I-2360, I-2365, I-2370, I-2375, I-2380, I-2385, I-2390, I-2395, I-2400, I-2405, I-2410, I-2415, I-2420, I-2425, I-2430, I-2435, I-2440, I-2445, I-2450, I-2455, I-2460, I-2465, I-2470, I-2475, I-2480, I-2485, I-2490, I-2495, I-2500, I-2505, I-2510, I-2515, I-2520, I-2525, I-2530, I-2535, I-2540, I-2545, I-2550, I-2555, I-2560, I-2565, I-2570, I-2575, I-2580, I-2585, I-2590, I-2595, I-2600, I-2605, I-2610, I-2615, I-2620, I-2625, I-2630, I-2635, I-2640, I-2645, I-2650, I-2655, I-2660, I-2665, I-2670, I-2675, I-2680, I-2685, I-2690, I-2695, I-2700, I-2705, I-2710, I-2715, I-2720, I-2725, I-2730, I-2735, I-2740, I-2745, I-2750, I-2755, I-2760, I-2765, I-2770, I-2775, I-2780, I-2785, I-2790, I-2795, I-2800, I-2805, I-2810, I-2815, I-2820, I-2825, I-2830, I-2835, I-2840, I-2845, I-2850, I-2855, I-2860, I-2865, I-2870, I-2875, I-2880, I-2885, I-2890, I-2895, I-2900, I-2905, I-2910, I-2915, I-2920, I-

[f](#)
[@](#)
[X](#)
[in](#)