

Property Features

- 600 – 2,420 SF Available Office, Medical Space
- Monument Signage
- Prominent Location off I-30 with Great Visibility
- 17,724 VPD (Motley Dr/I-30)
- 24-Hour Utilities
- Convenient access to I-30, 635, Hwy 80, President George Bush Turnpike, within minutes from Downtown Dallas, restaurants, hotels, and retail

For Lease

3224 I-30 E

MESQUITE, TX 75150



Available

Leased

3224 I-30 E MESQUITE, TX 75150

Suite 141 632 RSF
Suite 139 600 RSF

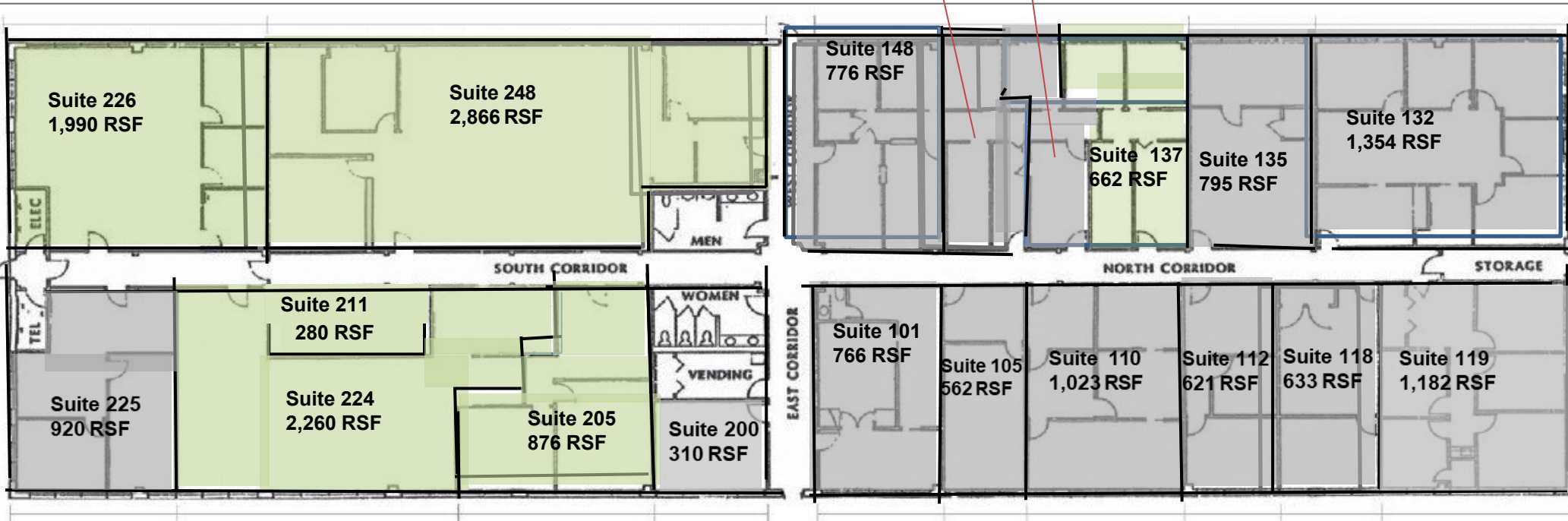

F O R L E A S I N G I N F O R M A T I O N , P L E A S E C O N T A C T

NOREEN MEHDI
noreen.mehdi@cbre.com
+1 214 7288434

17,724 VPD

Motley Dr/ I - 30

AREA AMENITIES



3224 I-30 E
MESQUITE, TX 75150

Property Features

600 – 2,420 SF AVAILABLE OFFICE, MEDICAL SPACE

- **Monument Signage**
- **Prominent Location off I-30 Great Visibility**
- **24-Hour Utilities**
- **Convenient access to I-30, 635, Hwy 80, President George Bush Turnpike Within Minutes from Downtown Dallas, restaurants, hotels and retail**

Area Amenities

- **Town East Mall**
- **The Market Place**
- **Markey East I**
- **Mesquite Town Centre Plaza**
- **Courtyard Hotel**
- **Days Inn**
- **Executive Inn & Suites**
- **Fairfield Inn Grand**
- **Hyatt Delux Inn**
- **Applebee's**
- **Buffalo Wild Wings**
- **Chili's**
- **Chick-Fil-A**
- **Dickey's Barbecue Pit**
- **Five Guys Burgers & Fries**
- **Jason's Deli**
- **Olive Garden**
- **Panera Bread**