

WAREHOUSE/MANUFACTURING FACILITY

1010 N FOURTH ST
MIAMISBURG, OH 45342



Property Highlights:

Square Feet: 63,000 SF

Selling Price: \$1,185,000

Lease Rate: \$3.00 NNN SF/YR

Drive-In Doors: Three

- ✓ 6.93 Acres
- ✓ Income Producing
- ✓ Outside Storage Lot
- ✓ 3 Miles to I-75
- ✓ Two Docks



Tim Echemann

Principal Broker

C: 937.658.4403

P: 937.492.4423

techemann@ipbindustrial.com

www.ipbindustrial.com



Conrad Echemann

Sales Associate

C: 937.658.4282

P: 937.492.4423

conrad@ipbindustrial.com

www.ipbindustrial.com

WAREHOUSE/MANUFACTURING FACILITY



1010 N FOURTH ST
MIAMISBURG, OH 45342

Sale Price: \$1,185,000

Lease Rate: \$3.00 SF/YR

Location Information

Street Address: 1010 N Fourth Ave
City, State, Zip: Miamisburg, OH 45342
County: Montgomery
Township: Miami
Side of the Street: East
Signal Intersection: No
Road Typed: Paved
Nearest Highway: I-75
Nearest Airport: Dayton

Building Information

Building Size: 63,000 SF
Ceiling Height: 12'-15'
Office Space: 3,000 SF
Number of Floors: 1
Construction Status: Existing
Roof Type: Rubber/Metal
Free Standing: Yes
Construction Type: Block/Metal
Drive-In Doors: 12'x14', 10'x10', & 8'x10'

Property Information

Property Type: Industrial
Property Subtype: Warehouse
Zoning: I-1; Light Industrial
Lot Size: 6.93 Acres
Parcel #'s: K46 00102 0029
Lot Frontage: 567'
Corner Property: Yes
Traffic Count: 10,704 Cars/Day
Traffic Count St: E Central Ave
Power: 230 Volts; 600 Amps; III Phase
Rail Access: No

Parking & Transportation

Parking Type: Gravel

Utilities & Amenities

Sprinkler System: Partially
Floor: Concrete 6" Thick
HVAC System: Forced Air Gas
Bathrooms: 6
Outside Security Lighting: Yes



Tim Echemann

Principal Broker

C: 937.658.4403

P: 937.492.4423

techemann@ipbindustrial.com

www.ipbindustrial.com



Conrad Echemann

Sales Associate

C: 937.658.4282

P: 937.492.4423

conrad@ipbindustrial.com

www.ipbindustrial.com

WAREHOUSE/MANUFACTURING FACILITY



1010 N FOURTH ST
MIAMISBURG, OH 45342



Tim Echemann

Principal Broker

C: 937.658.4403

P: 937.492.4423

techemann@ipbindustrial.com

www.ipbindustrial.com



Conrad Echemann

Sales Associate

C: 937.658.4282

P: 937.492.4423

conrad@ipbindustrial.com

www.ipbindustrial.com

ALL INFORMATION FURNISHED IS FROM SOURCES BELIEVED TO BE RELIABLE, AND IS SUBJECT TO ERROR, OMISSIONS, CHANGE OF TERMS AND CONDITIONS PRIOR TO SALE, LEASE, OR FINANCING, OR WITHDRAWAL

WAREHOUSE/MANUFACTURING FACILITY



1010 N FOURTH ST
MIAMISBURG, OH 45342

Tuck Point Brick Around G Roof

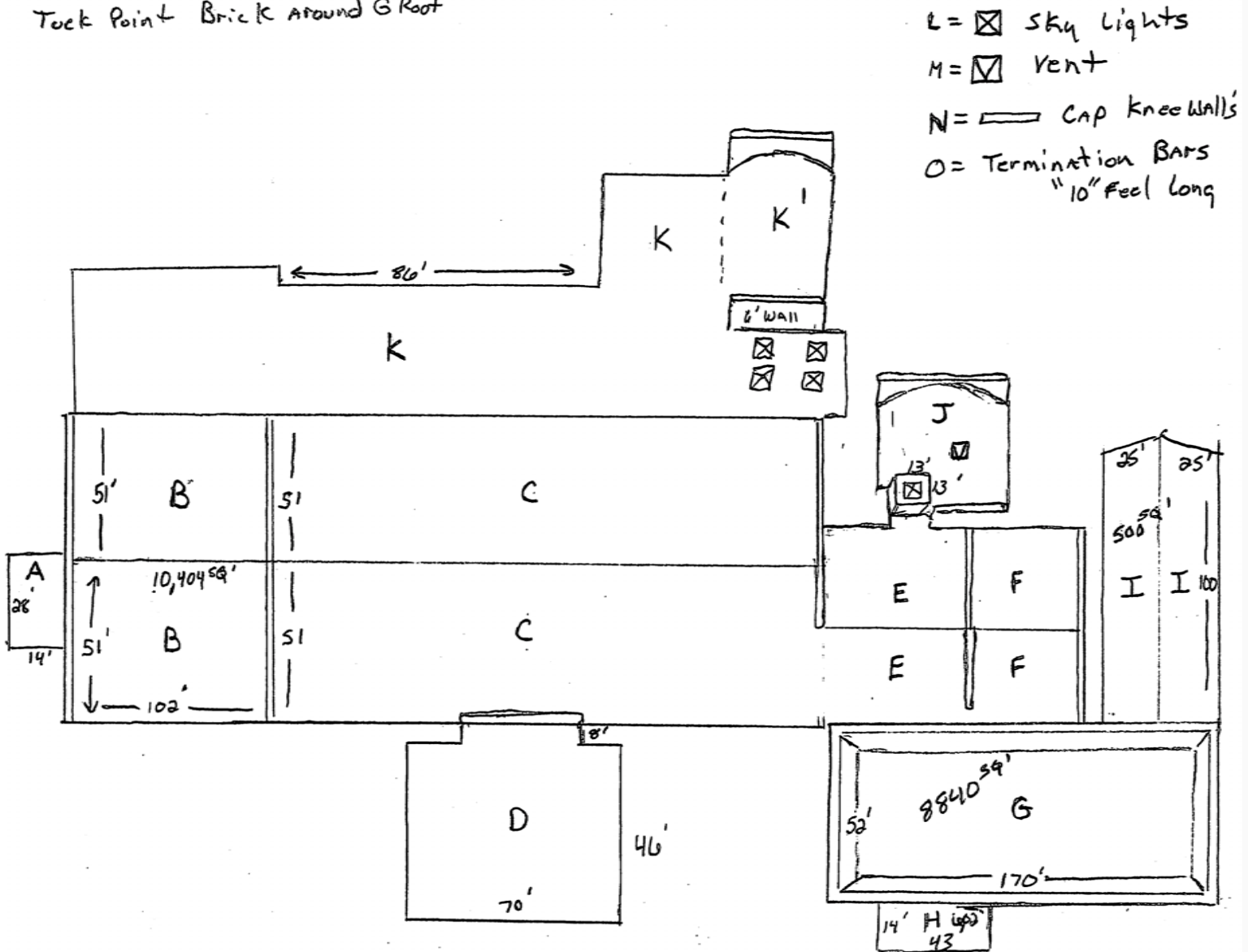

Tim Echemann

Principal Broker

C: 937.658.4403

P: 937.492.4423

techemann@ipbindustrial.com

www.ipbindustrial.com



Conrad Echemann

Sales Associate

C: 937.658.4282

P: 937.492.4423

conrad@ipbindustrial.com

www.ipbindustrial.com