



# Rideback Ranch

Up to 9,311 SF Available for Lease  
Los Angeles, CA 90026



**PROPERTY VIDEO**

## Highly Designed Creative Office Campus on the Eastside

Rare opportunity in the heart of Historic Filipinotown. Low-rise campus features improvements by Boto Design Architects for a variety of media / post-production uses.

- Total of 9,311 SF in two buildings
- Divisible to multiple sizes
- Courtyards, personal balconies, key card access, secured parking lot, bow-truss, high ceilings, light-filled, operable windows



Address	Square Footage
1660 Beverly Blvd.	4,500 SF
1670 Beverly – Ground Floor	4,811 SF
<b>TOTAL</b>	<b>9,311 SF</b>



# Campus Overview

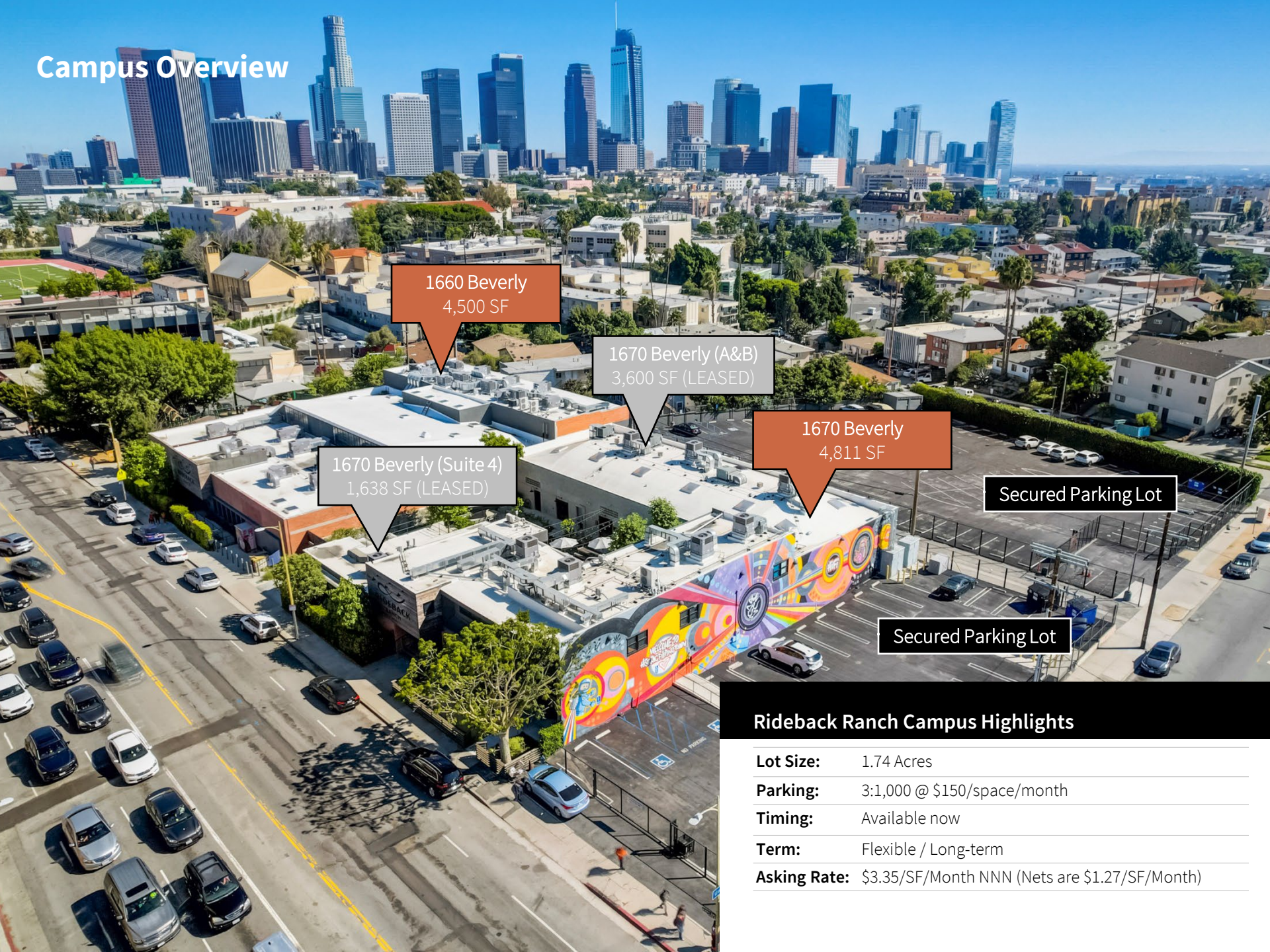

1660 Beverly  
4,500 SF

1670 Beverly (A&B)  
3,600 SF (LEASED)

1670 Beverly (Suite 4)  
1,638 SF (LEASED)

1670 Beverly  
4,811 SF

Secured Parking Lot

Secured Parking Lot

## Rideback Ranch Campus Highlights

<b>Lot Size:</b>	1.74 Acres
<b>Parking:</b>	3:1,000 @ \$150/space/month
<b>Timing:</b>	Available now
<b>Term:</b>	Flexible / Long-term
<b>Asking Rate:</b>	\$3.35/SF/Month NNN (Nets are \$1.27/SF/Month)



# 1660 Beverly Blvd.



## Property Highlights

**Address:** 1660 Beverly Blvd.

**Size:** 4,500 SF

**Features:** Designed by Boto Architects. Polished concrete floors, large chef's kitchen with Viking stove, additional upstairs kitchenette, multiple conference rooms, lobby entrance with highly designed bar, post-production offices, edit bays, operable windows, high ceilings, bow-truss building, bullpen area, and entrance to courtyard.





# 1660 Beverly Blvd.

Additional Photos



# 1660 Beverly Blvd.

## 1st Floor Plan

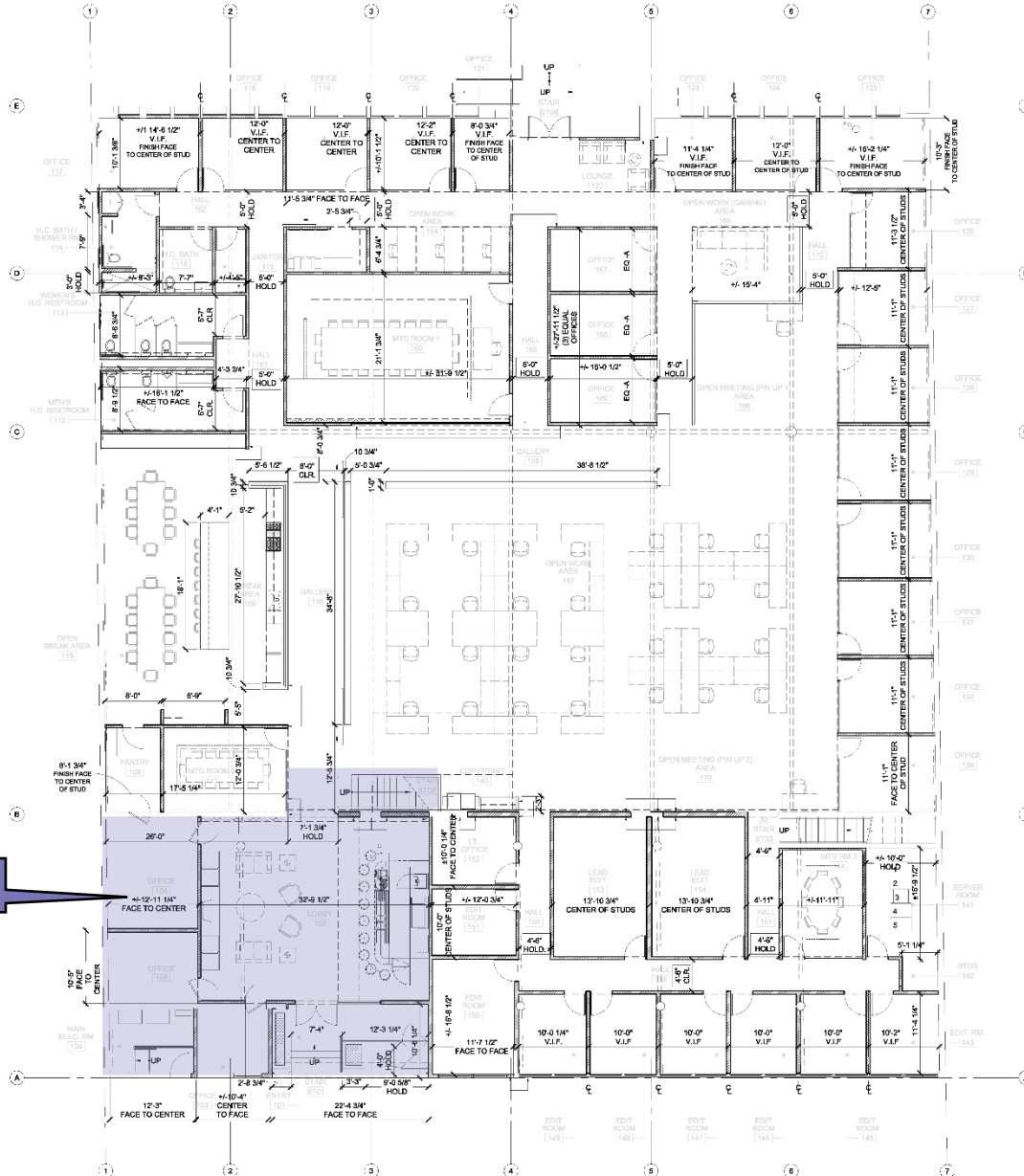





# 1670 Beverly



## Property Highlights

---

**Address:** 1670 Beverly

---

**Size:** 4,811 SF (divisible to 1,000 SF & 3,811 SF) on ground floor

---

**Features:** Private outdoor patios, highly built out creative office space with bow-truss ceilings, skylights, kitchenette, editing rooms and private restrooms.

---





# 1670 Beverly

## Ground Floor





# 1670 Beverly

## Floor Plan

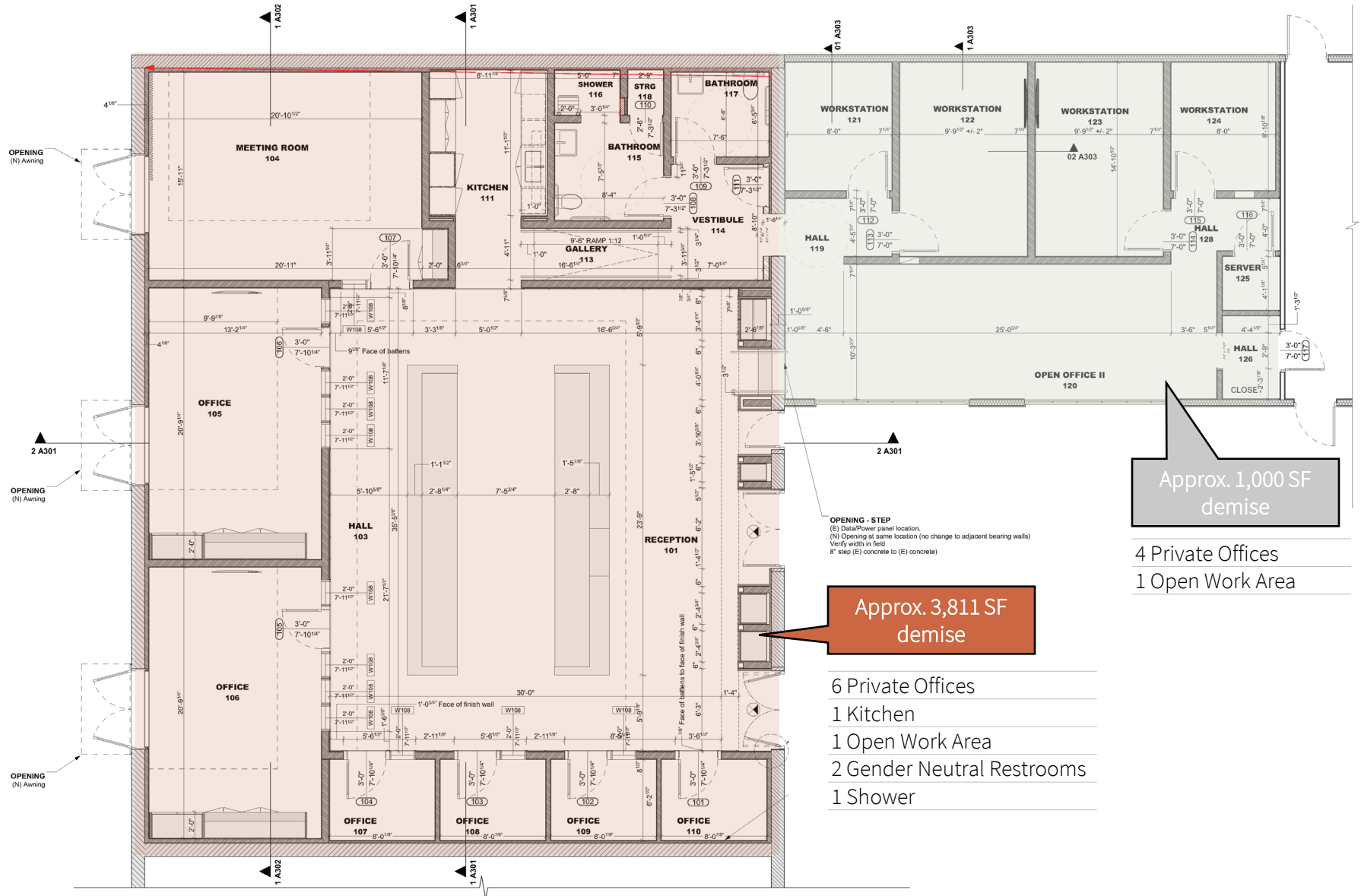

**Approx. 3,811 SF  
demise**

**Approx. 1,000 SF  
demise**

4 Private Offices  
1 Open Work Area

6 Private Offices  
1 Kitchen  
1 Open Work Area  
2 Gender Neutral Restrooms  
1 Shower



# Nearby Amenities

Melrose Hill

Silver Lake

Elysian Park

- Alfred Coffee
- Night + Market Song
- Dayglow
- Los Globos
- Cafe Tropical
- Silverlake Ramen
- Osen Izakaya
- WOOD
- Moon Juice

- Melody Sqirl
- Cafecito Organico

- Freedman's
- Andante Coffee
- Mohawk Bend
- Brite Spot
- Pharo's
- Pizza Buona
- The Semi-Tropic
- Masa
- Lassen's
- Ostrich Farm
- Little Joy
- Short Stop
- Konbi

- Los Molcajetes
- Valerie Confections
- Ragtop Fern BBQ

HiFi (Historic Filipino Town)

Echo Park

- Doubting Thomas
- Bahay Kuho
- Gigi's Cafe Cubano
- The Park
- Button Mash
- Ototo
- Tsubaki
- Eightfold Coffee
- Guisado
- Bar Henry

Wilshire Center

Crawfords

BLUMHOUSE PRODUCTIONS

- Luck Thai Cuisine
- Starbucks

- Brooklyn Bagel Bakery
- Bootleg Theater
- El Burrito Panzon
- Subway
- Boba Guys
- Tribal Cafe
- 1642 Bar
- Clark Street Bread
- Laveta
- K Bakery
- Goodfight
- HiFi Kitchen

ARRAY

RIDEBACK RANCH

MacArthur Park

Westlake

Downtown Los Angeles



# Rideback Ranch Campus





# Rideback Ranch | Los Angeles, CA 90026



## Contact

Nicole Mihalka  
Managing Director  
CA License #01322414  
+1 213 239 6076  
nicole.mihalka@jll.com

Cal Ross  
Vice President  
CA License #01892435  
+1 213 239 6339  
cal.ross@jll.com



Although information has been obtained from sources deemed reliable, neither Owner nor JLL makes any guarantees, warranties or representations, express or implied, as to the completeness or accuracy as to the information contained herein. Any projections, opinions, assumptions or estimates used are for example only. There may be differences between projected and actual results, and those differences may be material. The Property may be withdrawn without notice. Neither Owner nor JLL accepts any liability for any loss or damage suffered by any party resulting from reliance on this information. If the recipient of this information has signed a confidentiality agreement regarding this matter, this information is subject to the terms of that agreement. © 2023 Jones Lang LaSalle IP, Inc. All rights reserved.