



**CUSHMAN &
WAKEFIELD**

FOR SUBLEASE

34947 Flyover Ct., Suite B

Bakersfield, CA

AVAILABLE NOW



19,840 SF Industrial Office/Warehouse
Lease Rate: \$1.10psf/month, NNN

Property Highlights

Total Available:	±19,840 SF	Office:	2,500 SF
Site Size:	1.34 Acres	Clear Height:	24'
Fire Sprinklers:	ESFR		
Loading:	(2) 9' x 10' Dock Doors (1) 12' x 14' Ground-Level Door		
Zoning:	M2 PD, County of Kern		
Utilities:	Pacific Gas & Electric The Gas Company North of the River Sanitation District		

Master Lease expires November 30, 2028

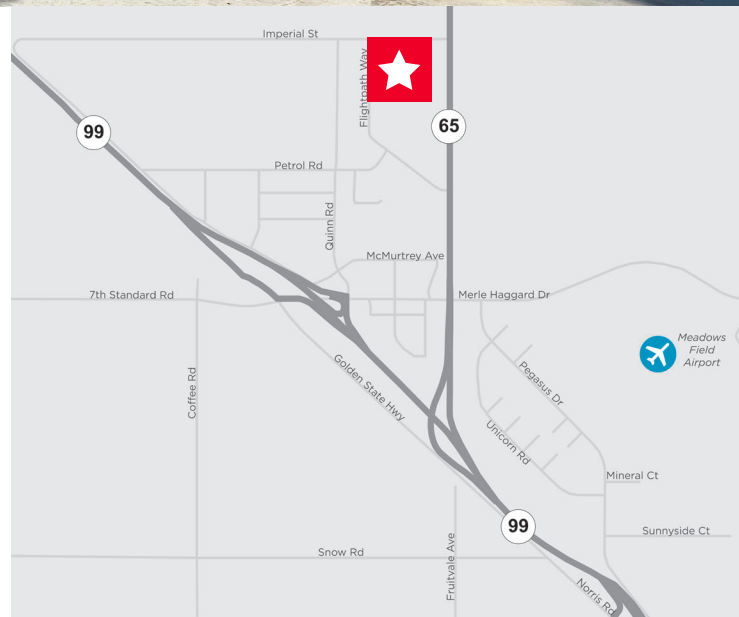

Wayne Kress, SIOR
Executive Director
+1 661 633 3819
wayne.kress@cushwake.com
LIC #00834680

Coby Vance
Senior Director
+1 661 633 3807
coby.vance@cushwake.com
LIC #01449929

Scott Reynolds
Director
+1 661 633 3825
scott.reynolds@cushwake.com
LIC #01382493

5060 California Ave., Suite 1000
Bakersfield, CA 93309
Main +1 661 327 2263
Fax +1 661 633 3801
LIC #01880493
cushmanwakefield.com

Floor Plan

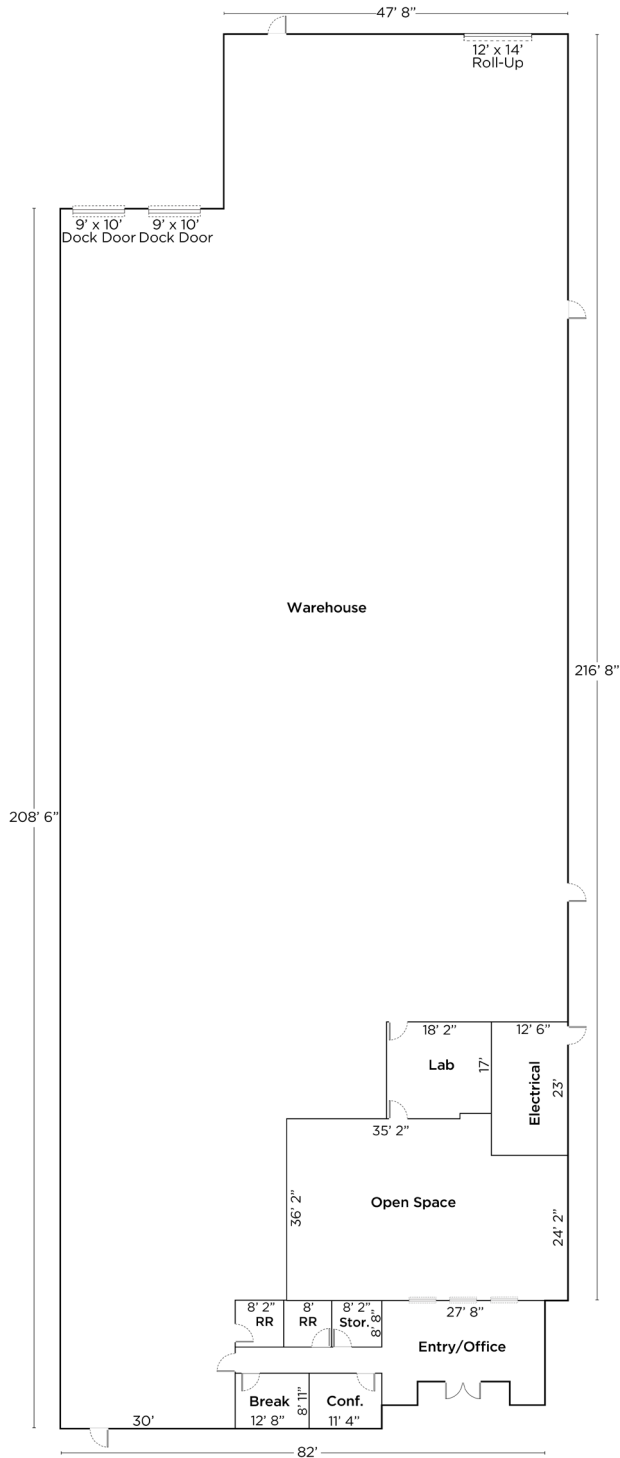

Not to Scale



FOR SUBLEASE

34947 Flyover Ct., Suite B
Bakersfield, CA



Front Entry



Shop Floor



Shop Floor



Lab



Warehouse Floor



Warehouse Floor



One grade-level door. Two dock doors



Grade-Level Door

Bakersfield Airport Area - Bakersfield's most active industrial submarket



Available space shares building with Mission Foods

