

Special Teaser Rate: \$1.85 psf per month

**3 MONTHS**

Available For Qualified Applicants  
Per Landlord's Discretion

SMILE  
YOU'RE ON  
CAMERA

**AUTOMOTIVE  
RETAIL  
SPACE  
FOR LEASE**



*Exclusive listing by Mike Tolj  
Tolj Commercial Real Estate  
DRE NO: 01373646*

**6043** South Western Avenue, Los Angeles, CA 90047



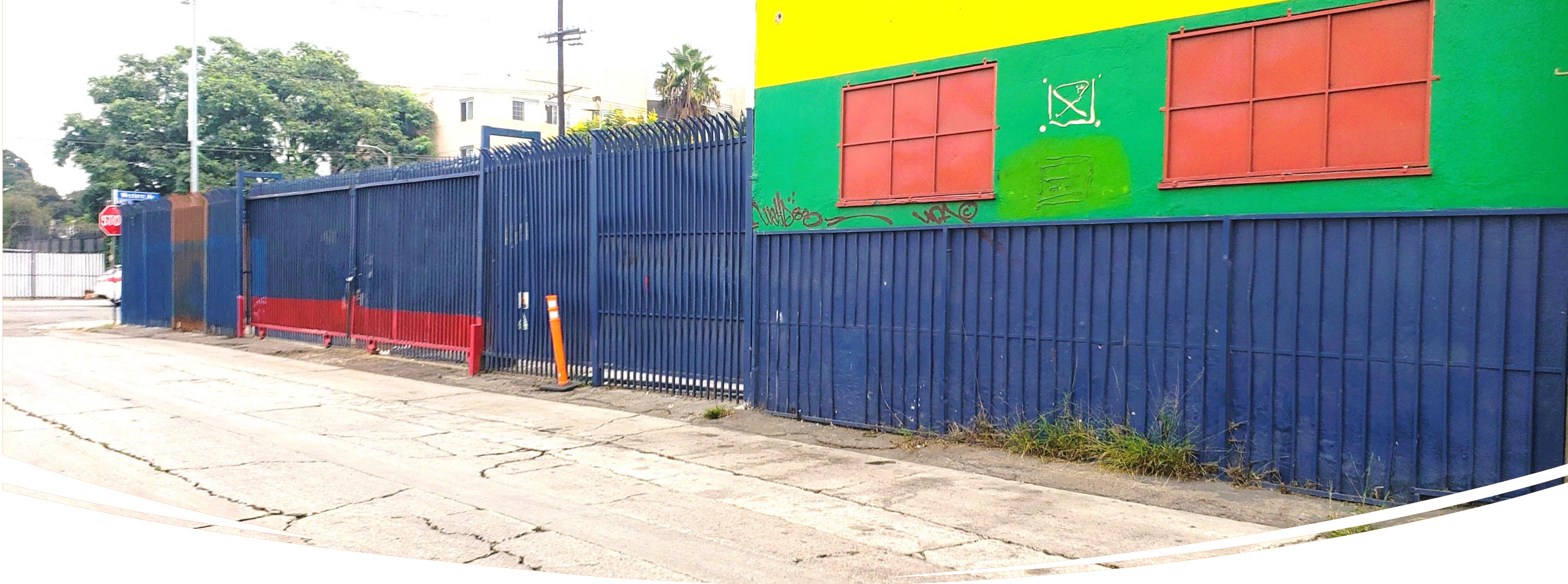

# PROPERTY HIGHLIGHTS

- *Two Auto Bays, Office, Bathroom, & Ample Storage Room*
- *Secure Gated Property*
- *High Street Frontage Visibility*
- *Conveniently near the 110 & 10 Freeways*
- *Minutes to Downtown Los Angeles*

**6043** South Western Avenue, Los Angeles, CA 90047





# LEASE TERMS

Located in the South-Central area of Los Angeles County, this **automotive repair service property** is ideal for a mechanical automotive repair shop. Compliance with Los Angeles zoning codes and use requirements is necessary.

<b>Square Footage:</b>	Approx. 1,200
<b>Lot Size:</b>	Approx. 5,503
<b>Rental Rate:</b>	\$2.00 per sf per month
<b>Term:</b>	1-5 Years + (Modified Gross)
<b>Number of Bays:</b>	Approx. 2
<b>Utilities:</b>	Separately metered
<b>Zone:</b>	CM-2D-CPIO
<b>Parking:</b>	Approx. 5 stalls

Limited-time teaser rate of \$1.85 per sq. ft. per month for the first three months, available to qualified applicants, at the landlord's discretion. Terms and conditions apply. Rates and qualifications may change without notice.

**6043** South Western Avenue, Los Angeles, CA 90047

# FLOOR PLAN

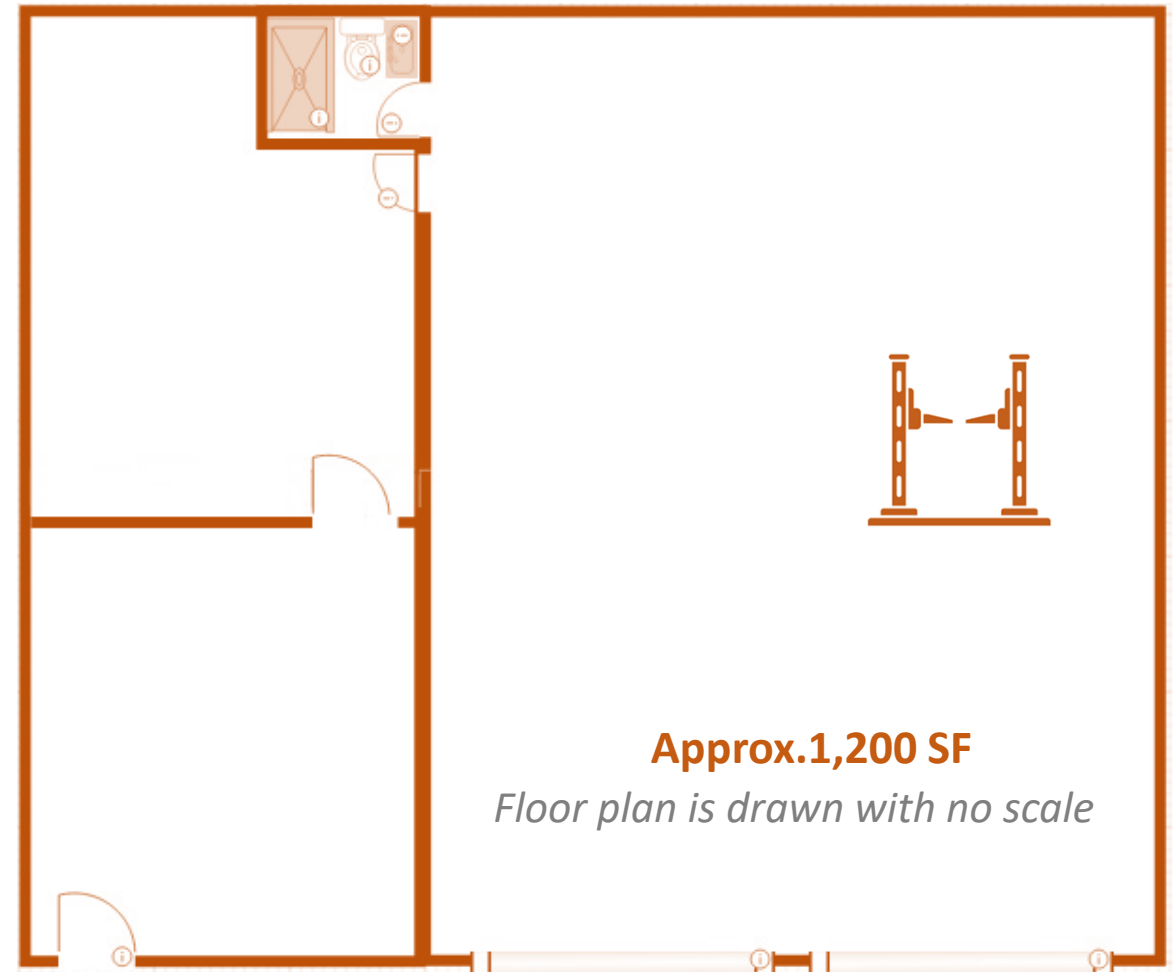

**6043** South Western Avenue, Los Angeles, CA 90047



# SITE MAP

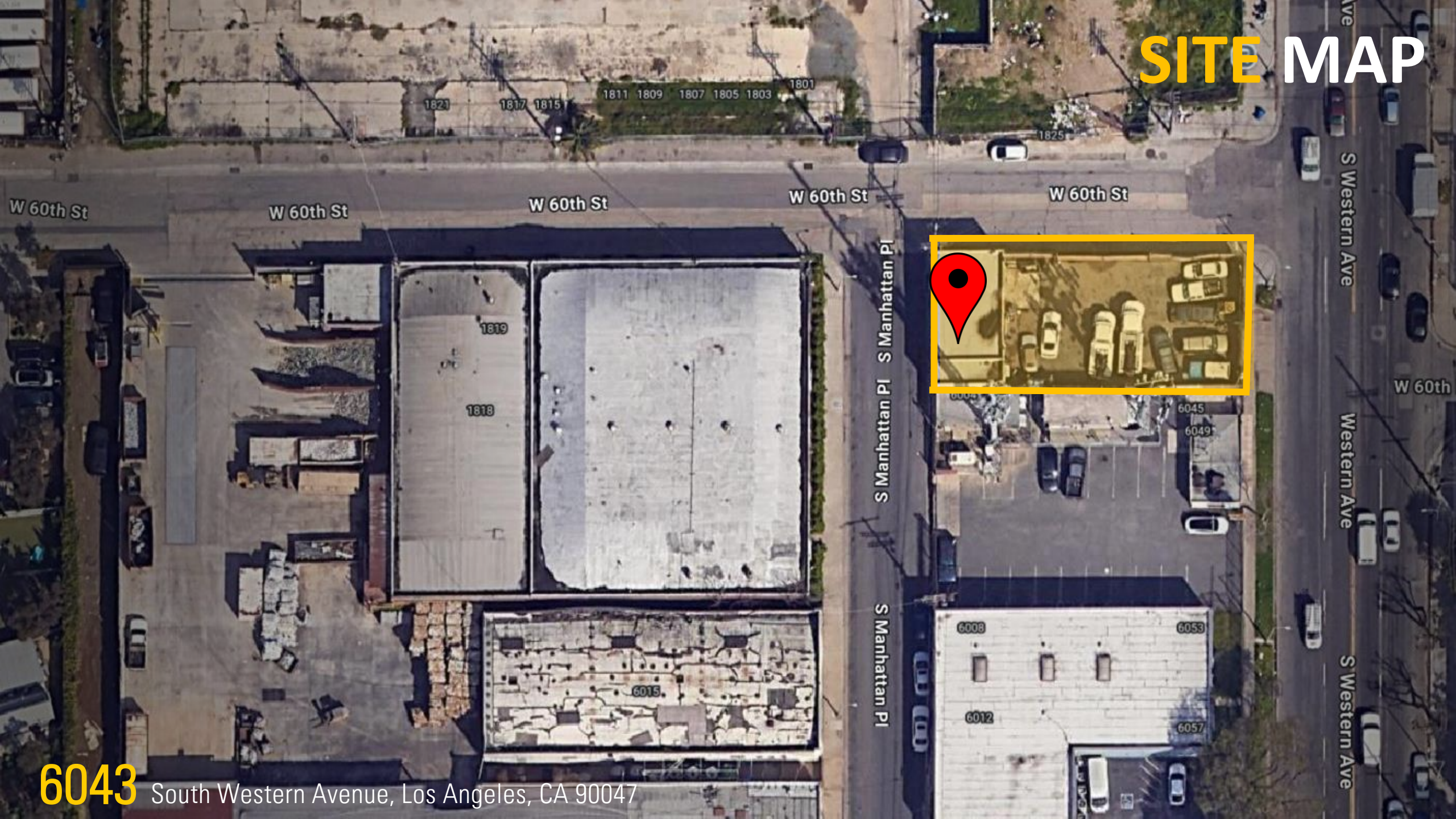

**6043** South Western Avenue, Los Angeles, CA 90047



# INTERIOR PHOTOS



**6043** South Western Avenue, Los Angeles, CA 90047





# INTERIOR PHOTOS





# PROPERTY & GATED YARD



**6043** South Western Avenue, Los Angeles, CA 90047



## Disclaimer and Information Notice

The information provided in this brochure is for general reference only and is not guaranteed to be accurate or complete. Prospective businesses and tenants should conduct their own independent verification and due diligence. No warranties or representations, either expressed or implied, are made as to the accuracy of the information contained herein. This information is submitted subject to errors, omissions, change of price, rental, or other conditions, withdrawal without notice, and is subject to any special listing conditions imposed by our principals. Cooperating brokers, buyers, tenants, and other parties who receive this document should not rely on it but should use it as a starting point for analysis. They should independently confirm the accuracy of the information through a due diligence review of books, records, files, and documents that constitute reliable sources. Logos are for identification purposes only and may be trademarks of their respective companies. Tolj Commercial Real Estate, RE Lic. #0137646



**6043** South Western Avenue, Los Angeles, CA 90047

SMILE  
YOU'RE ON  
CAMERA

**BROKER CONTACT INFORMATION**



Mike Tolj, MBA  
*Commercial Broker*  
DRE No. 01373646  
Work: 323.258.4946  
Cell: 323.317.2561  
mike@toljcommercial.com

*Image sources: Unsplash.com - Nick Wright, Flowers, Pexels.com - Vlada Karpovich,  
Green Palm Tree, Unsplash.com - Mike Von, Bridge & Unsplash.com - Levi Meir Clancy,  
River Under Bridge, Anthony Bautista and Vectorstock*

**930 Colorado Boulevard, Suite 1, Los Angeles, CA 90041**



[www.toljcommercial.com](http://www.toljcommercial.com)