

WESTPORT RETAIL

2148 North Redwood Road | Saratoga Springs, UT 84045

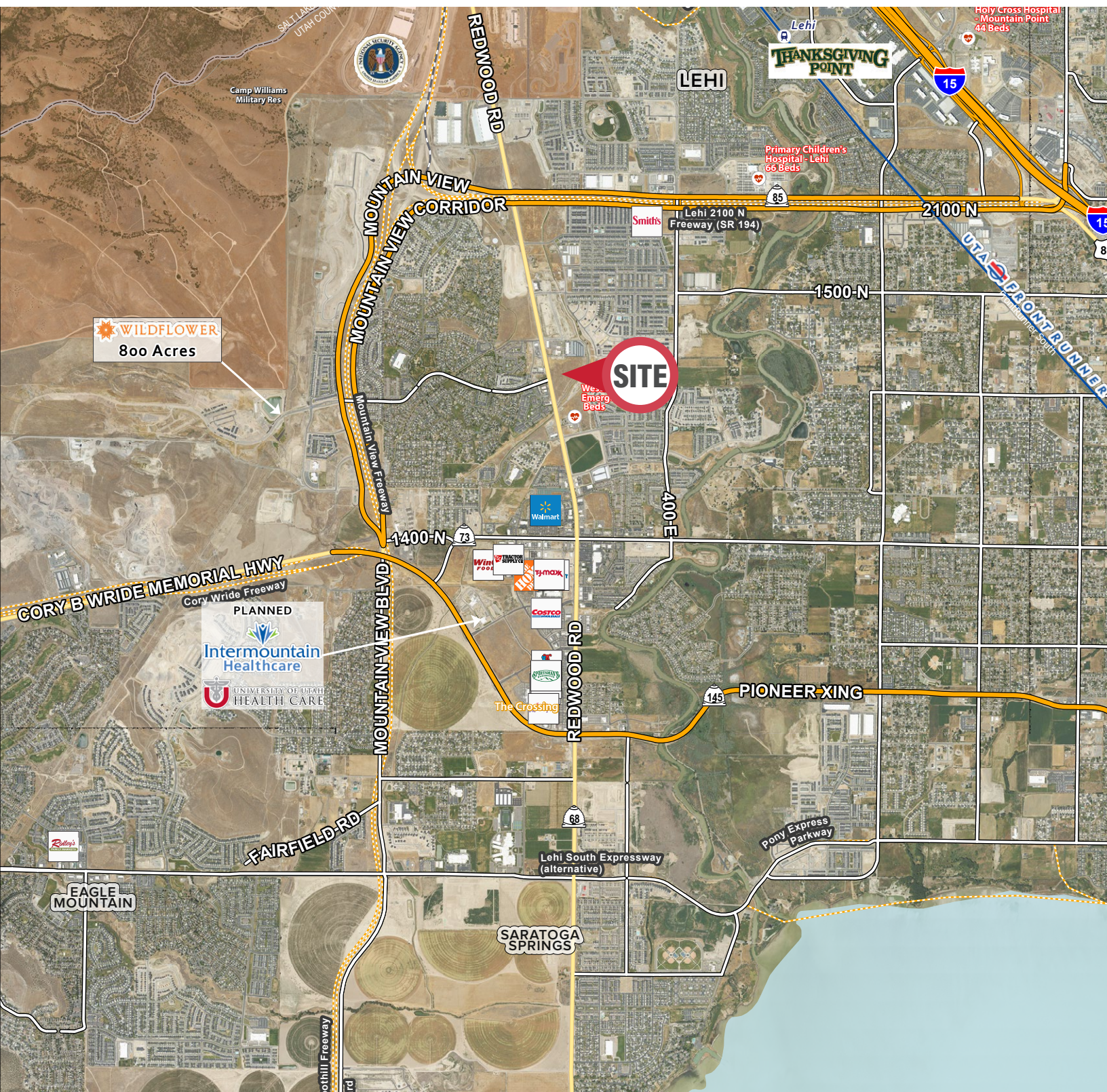

PROPERTY HIGHLIGHTS

- Zoning: Flex
- Lit Intersection
- 24,000 ADT on Redwood

Building 1

- Up to 4,040 SF
- Two Drive Thru Spaces Available
- \$42 PSF NNN End Cap
- \$50 PSF NNN Drive Thru

Lot 1

- For Sale or Lease
- Will Subdivide Lot
- 3.76 AC Available
- Contact Agent for Pricing

DEMOGRAPHICS	1 MILE	3 MILE	5 MILE
2024 EST. POPULATION	14,827	73,748	169,714
2029 PROJECTED POPULATION	16,419	90,658	196,224
2024 EST. DAYTIME POPULATION	12,188	75,857	154,687
2024 EST. AVG HH INCOME	\$151,097	\$152,392	\$151,393
2024 EST. HOUSEHOLDS	4,512	19,943	45,243
2024 EST. BUSINESSES	185	1,254	2,470

Contact

SKYLER PETERSON, SIOR
Executive Vice President
m 801.656.7354
speterson@legendcommercial.com

TRE BOURDEAUX, SIOR
Vice President
m 801.824.0397
tbourdeaux@legendcommercial.com

CONNOR DEBRY
Associate
m 801.557.9119
cdebry@legendcommercial.com



Contact

SKYLER PETERSON, SIOR
Executive Vice President
m 801.656.7354
speterson@legendcommercial.com

TRE BOURDEAUX, SIOR
Vice President
m 801.824.0397
tbourdeaux@legendcommercial.com

CONNOR DEBRY
Associate
m 801.557.9119
cdebry@legendcommercial.com



WESTPORT RETAIL

2148 North Redwood Road | Saratoga Springs, UT 84045

BUILDING 1

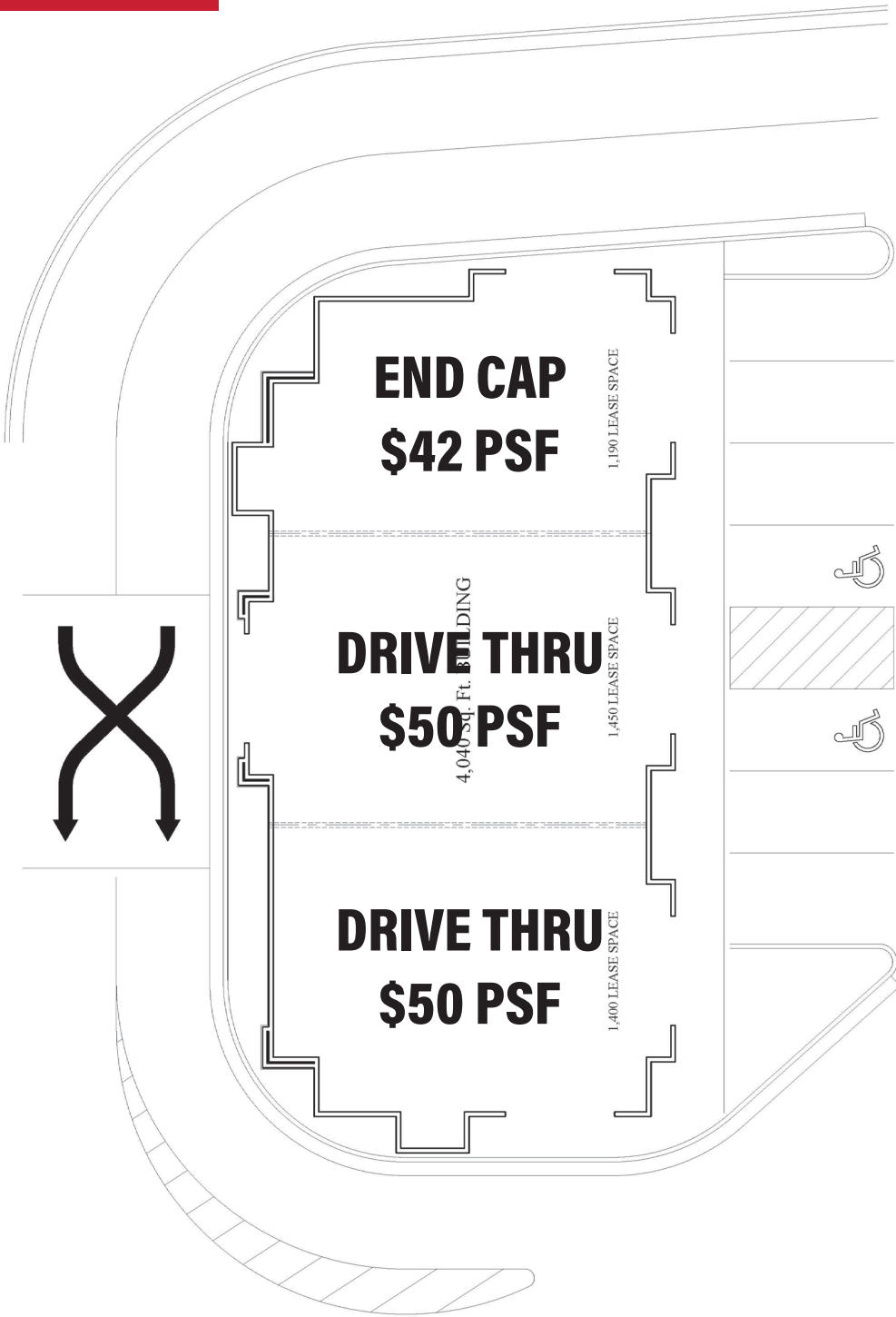

LOT 1

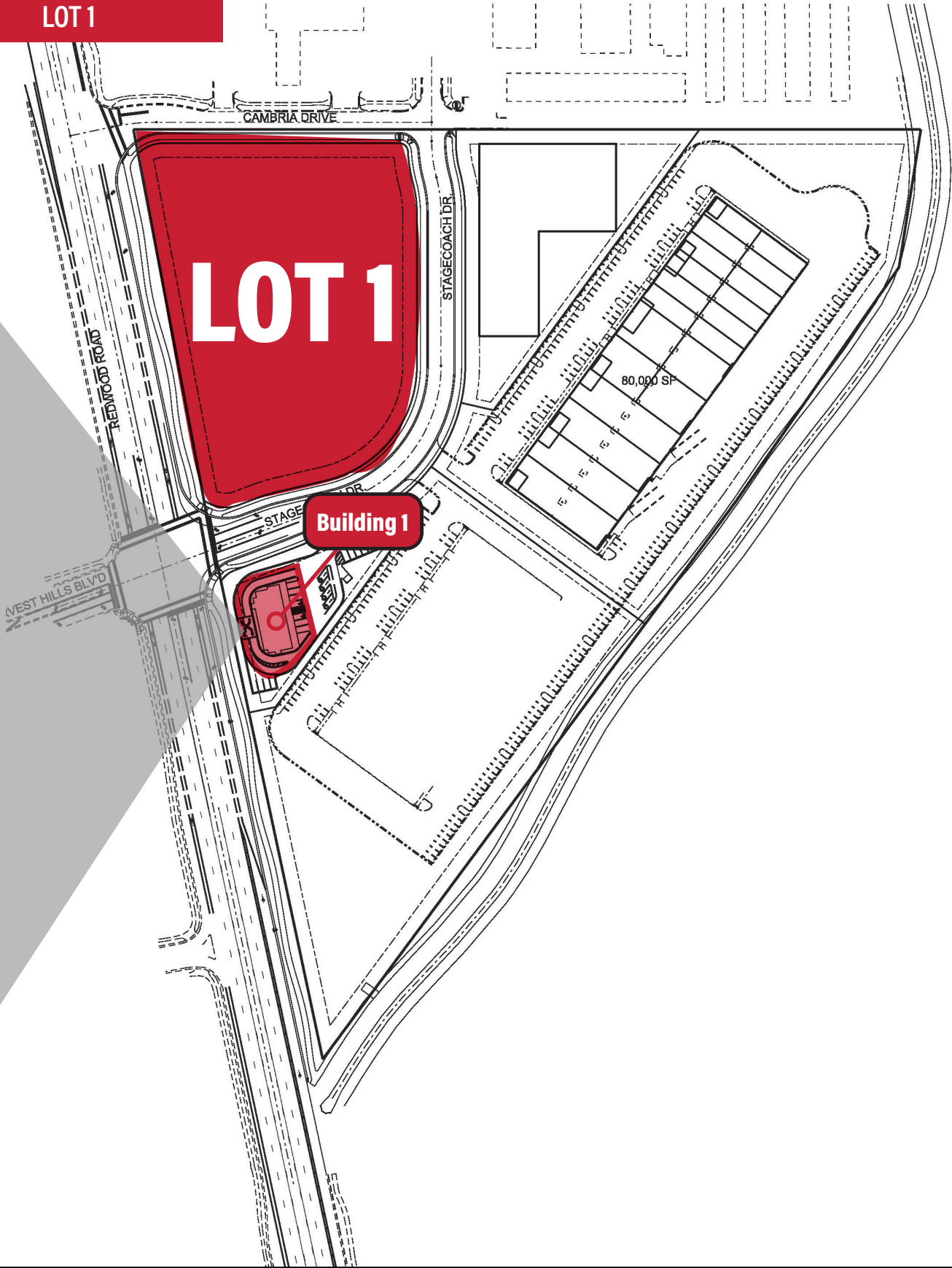

Contact

SKYLER PETERSON, SIOR
Executive Vice President
m 801.656.7354
speterson@legendcommercial.com

TRE BOURDEAUX, SIOR
Vice President
m 801.824.0397
tbourdeaux@legendcommercial.com

CONNOR DEBRY
Associate
m 801.557.9119
cdebry@legendcommercial.com

**LEGEND
COMMERCIAL**
801.930.6750 | www.legendllp.com
2180 S 1300 E, Suite 240 | Salt Lake City, UT 84106

Contact

SKYLER PETERSON, SIOR
Executive Vice President
m 801.656.7354
speterson@legendcommercial.com

TRE BOURDEAUX, SIOR
Vice President
m 801.824.0397
tbourdeaux@legendcommercial.com

CONNOR DEBRY
Associate
m 801.557.9119
cdebry@legendcommercial.com

**LEGEND
COMMERCIAL**
801.930.6750 | www.legendllp.com
2180 S 1300 E, Suite 240 | Salt Lake City, UT 84106