

MEDICAL OFFICE FOR SUBLEASE

MIDWAY MEDICAL PLAZA

3434 Midway Drive # 2001 San Diego , CA 92110



- **5,567 SF Available in a Class A, Two Story Medical Building with Expansive Glass and Steel Facade**
- **Centrally Located at the Intersection of I-5 and I-8 Fwys, Across the Street from Kaiser Permanent Medical Center. 4 Miles from San Diego International Airport.**
- **Potential Synergy with a Modern Surgery Center on the Premises**
- **Building Has Been Recently Renovated: New HVAC, LED Lights, Monument Signage, Interior Upgrades.**
- **Ample Patients and Staff Parking**



PER DIEM OPPORTUNITY



DAILY RATE

\$150 / EXAM ROOM - ENTIRE FLOOR / NEGOTIABLE

- ✓ **7 Exam Rooms - Entire Top Floor**
- ✓ **Reception and Waiting Area**
- ✓ **Modern Renovated Office Space**
- ✓ **Nurse Station and Private Offices**
- ✓ **Available: Individual Exam Rooms M - F; Entire Office on Mondays**

Steve Body, Ph.D, MBA, MSF, MA

www.MDRECapital.com

818-852-9255

Steve@mdrecapital.com

CA BRE # 01927373

KW Commercial CA BRE # 01428774

Pelin Sen, MBA

www.passmedmanagement.com

310-382-7539

Pelin@passmedmgmt.com

CA BRE # 02210768

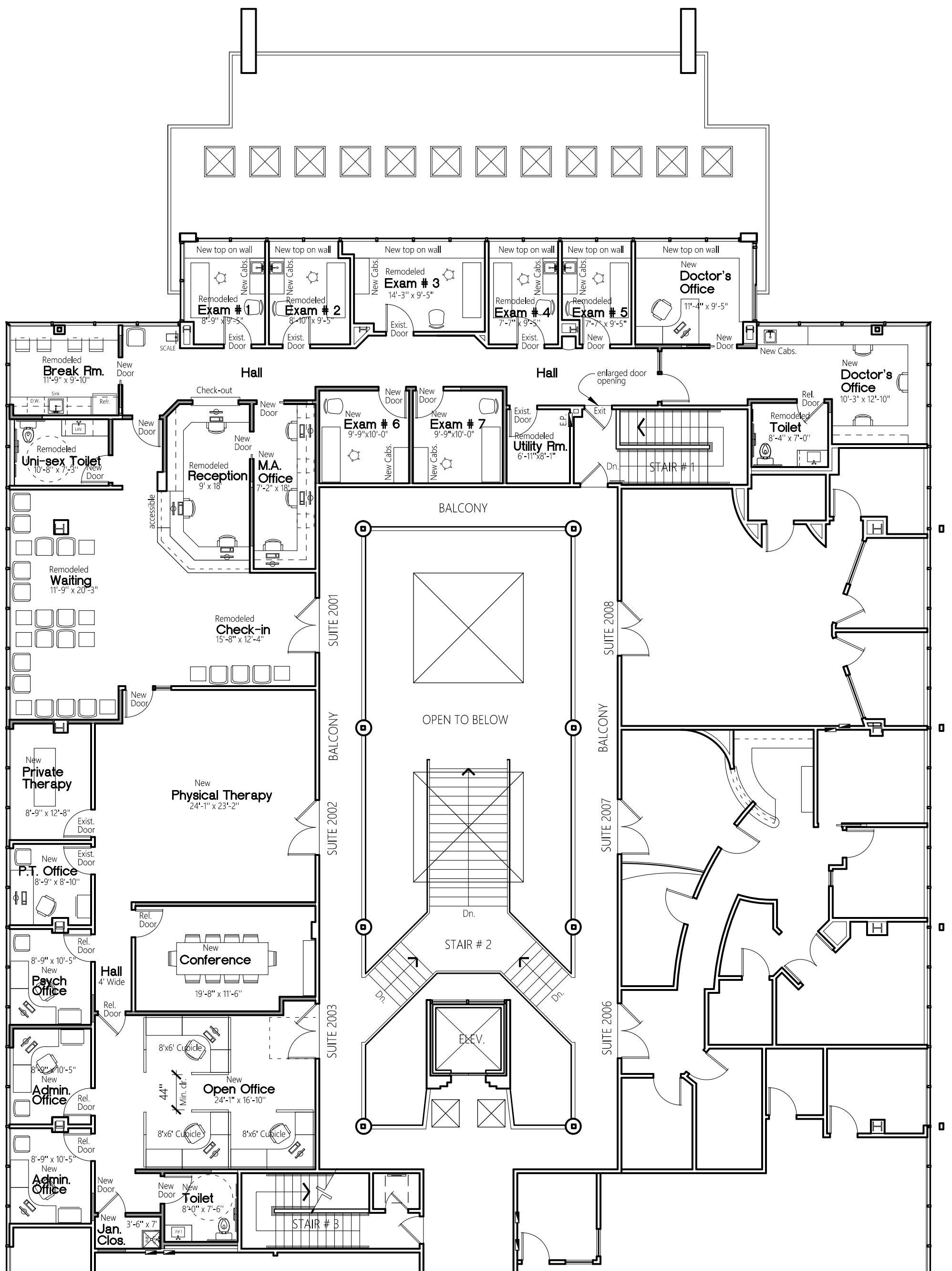

Suite 2001 2,918 U.S.F.
3,356 R.S.F.

Suite 2002 1,159 U.S.F.
1,333 R.S.F.

Suite 2003 764 U.S.F.
878 R.S.F.

Alternate Proposed Plan
Suites 2001, 2002 and 2003

3434 MIDWAY DRIVE, SAN DIEGO CALIFORNIA

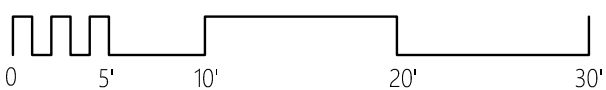

1" = 10'-0"

03-08-2021

