

32000 PLYMOUTH ROAD  
LIVONIA, MICHIGAN

INDUSTRIAL FOR SALE  
18,700 Square Feet Available



**SIGNATURE  
ASSOCIATES**  
KNOW SIGNATURE | KNOW RESULTS

**EDWARDS GLASS**

**PRICED REDUCED**



## PROPERTY FEATURES

- 18,700 square feet available
- 5,010 square feet office
- 16' – 24' clear height
- (5) 12' x 14', 12' x 16' grade level doors
- (1) 3-ton crane
- Main road frontage near I-96 access
- Attractive façade, nice interior office
- Ample parking
- Well-maintained facility
- Sale Price: \$1,850,000 (\$98.93/sq. ft.)



For more information, please contact:

**CHRISTOPHER CALVANO**  
(248) 359 0610

[ccalvano@signatureassociates.com](mailto:ccalvano@signatureassociates.com)

**PETER VANDERKAAY**  
(248) 359 3837

[pvanderkaay@signatureassociates.com](mailto:pvanderkaay@signatureassociates.com)

**SIGNATURE ASSOCIATES**  
One Towne Square, Suite 1200  
Southfield, MI 48076  
[www.signatureassociates.com](http://www.signatureassociates.com)

18,700  
Square Feet  
AVAILABLE

The site plan illustrates the layout of the property at 32000 Plymouth Road. The main building is a large, yellow-shaded rectangular structure. The central portion of the building is labeled "32000 PLYMOUTH ROAD". The building's interior is divided into several rooms, including a large central area, a "SHOW ROOM" at the bottom right, a "STOCK ROOM" at the bottom center, and a series of smaller rooms labeled "OFFICE 1" through "OFFICE 10". Other rooms include a "CONFERENCE" room, a "KITCHEN", a "RESTROOM", and a "RECEPTION AREA". The building is surrounded by a parking lot with numerous parking spaces. A "SIDEWALK" runs along the bottom edge of the property. The property is bounded by "PLYMOUTH ROAD" on the bottom and "32030 PLYMOUTH ROAD" on the left. A "SIGN" is indicated in the parking lot near the bottom right corner. The plan also shows landscaping elements like trees and shrubs along the top and bottom edges of the property.

[www.signatureassociates.com](http://www.signatureassociates.com)

Information is subject to verification and no liability for errors or omissions is assumed. Price is subject to change and listing withdrawal.

# 32000 Plymouth Road – Livonia, Michigan

## Industrial For Sale

18,700  
Square Feet  
AVAILABLE

### Floor Plan

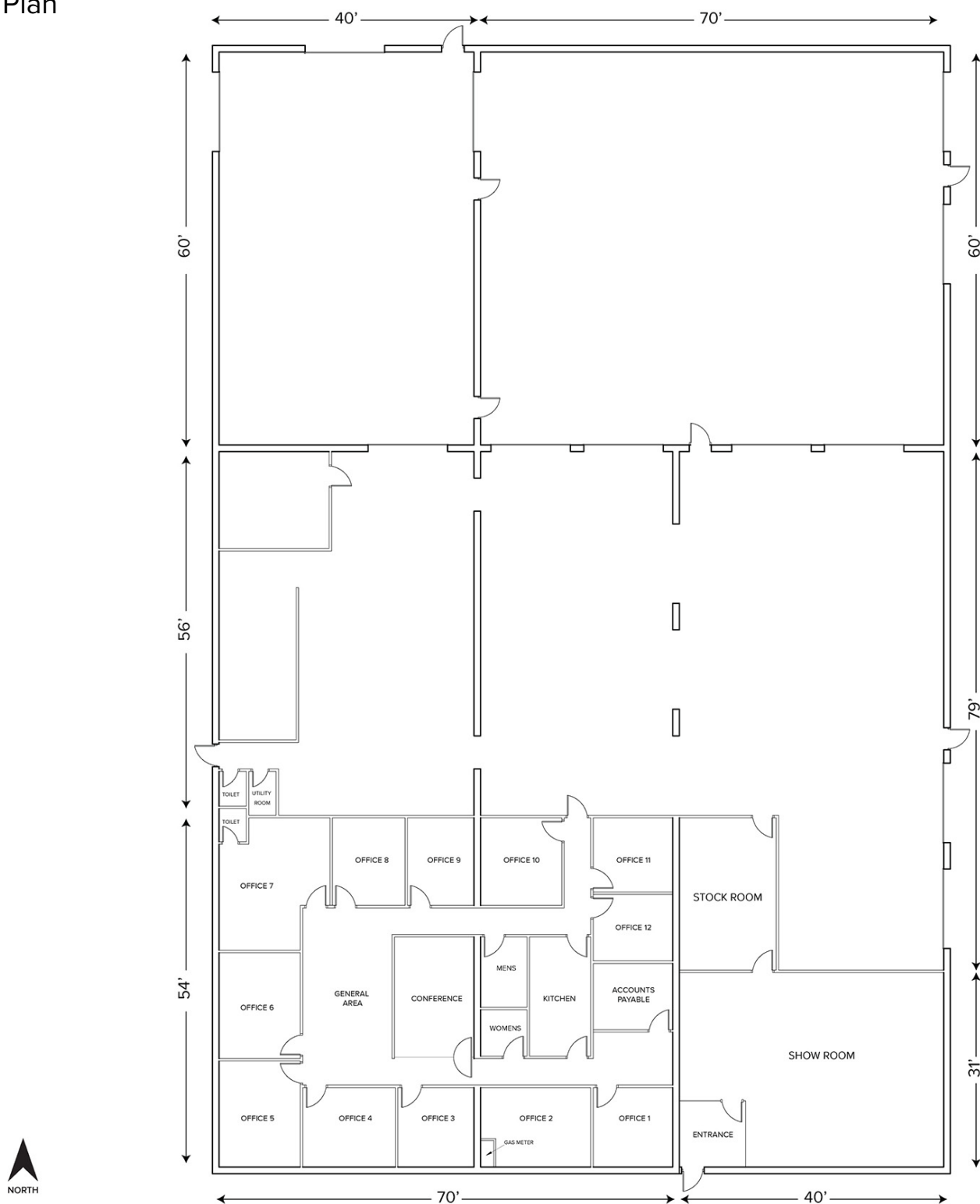

For more information, please contact:

**CHRISTOPHER CALVANO**

(248) 359 0610

[ccalvano@signatureassociates.com](mailto:ccalvano@signatureassociates.com)

**PETER VANDERKAAY**

(248) 359 3837

[pvanderkaay@signatureassociates.com](mailto:pvanderkaay@signatureassociates.com)

**SIGNATURE ASSOCIATES**

One Towne Square, Suite 1200

Southfield, MI 48076

[www.signatureassociates.com](http://www.signatureassociates.com)



# 32000 Plymouth Road – Livonia, Michigan

## Industrial For Sale

18,700  
Square Feet  
AVAILABLE

Aerial



For more information, please contact:

**CHRISTOPHER CALVANO**

(248) 359 0610

[ccalvano@signatureassociates.com](mailto:ccalvano@signatureassociates.com)

**PETER VANDERKAAY**

(248) 359 3837

[pvanderkaay@signatureassociates.com](mailto:pvanderkaay@signatureassociates.com)

**SIGNATURE ASSOCIATES**

One Towne Square, Suite 1200

Southfield, MI 48076

[www.signatureassociates.com](http://www.signatureassociates.com)

Information is subject to verification and no liability for errors or omissions is assumed. Price is subject to change and listing withdrawal.