

FOR SALE OR LEASE

1111 N. DuPage Avenue

Lombard, IL

Property Specifications

- Building Size: 59,830 SF
- Site Size: 2.21 AC
- Office: 4,100 SF
- Ceiling Height: 24' Clear
- Loading: 4 Exterior Docks
3 Interior Docks
3 Drive-In Doors
- Car Parking: 48 spaces
- Power: 1600 Amps @ 120/240 Volts & 800 Amps @ 120/240 Volt
- Sprinkler: Wet System
- Real Estate Taxes: \$1.09 PSF (2022, payable 2023)
- Great Central DuPage location with immediate access to I-355 via North Avenue full interchange
- Potential user/investor opportunity
- Sale Price: Subject to Offer
- Lease Rate: Subject to Offer

CONTACT US

John D'Orazio

+1 847 384 2823

john.dorazio@colliers.com

Reed Adler

+1 847 384 2810

reed.adler@colliers.com

Colliers

6250 N. River Rd. | Suite 11-100
Rosemont, IL 60018

+1 847 698 8444

www.colliers.com/chicago

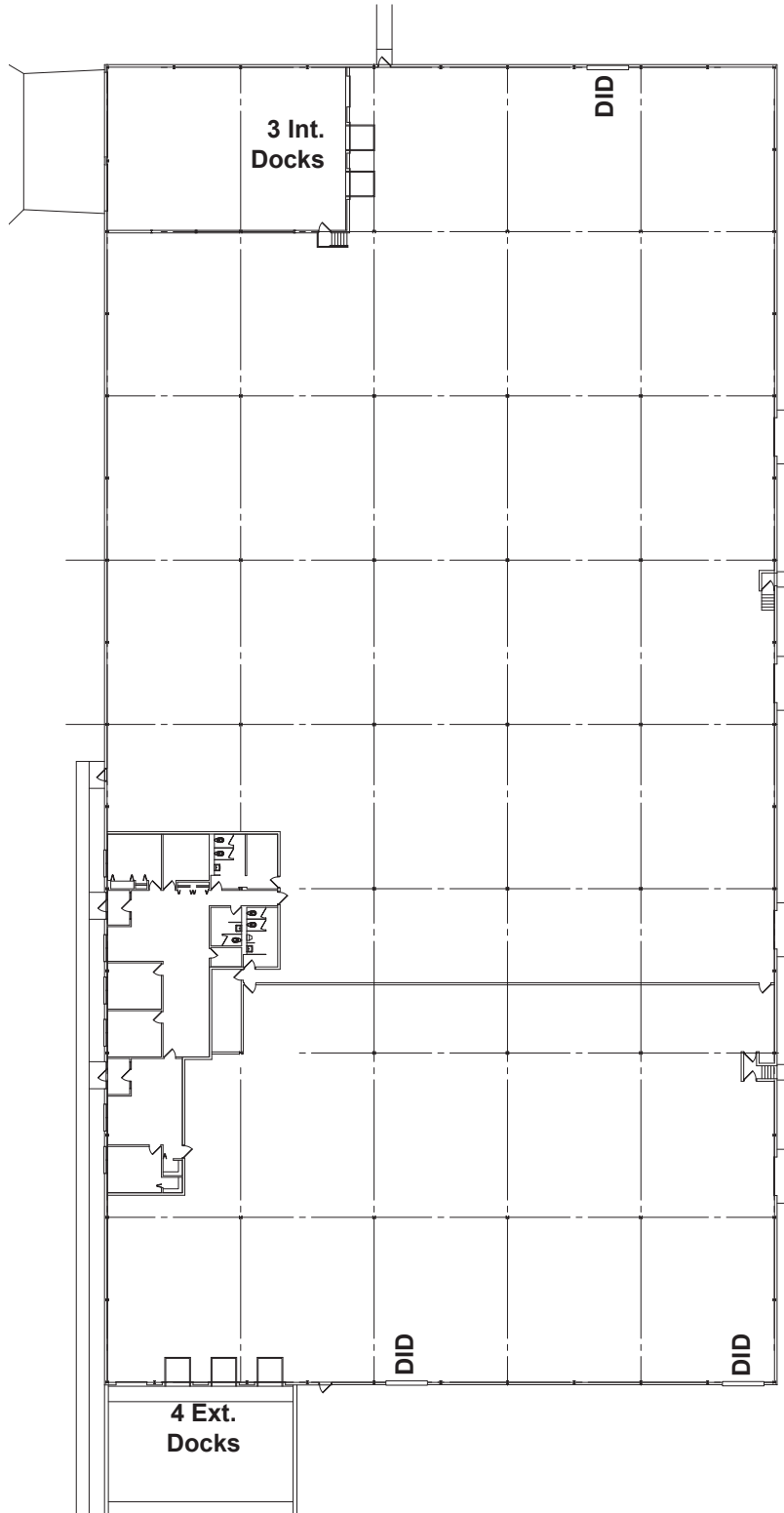

CONTACT US

John D’Orazio
+1 847 384 2823
john.dorazio@colliers.com

Reed Adler
+1 847 384 2810
reed.adler@colliers.com



Colliers
6250 N. River Rd. | Suite 11-100
Rosemont, IL 60018
+1 847 698 8444
www.colliers.com/chicago

FOR SALE OR LEASE

1111 N. DuPage Avenue, Lombard, IL

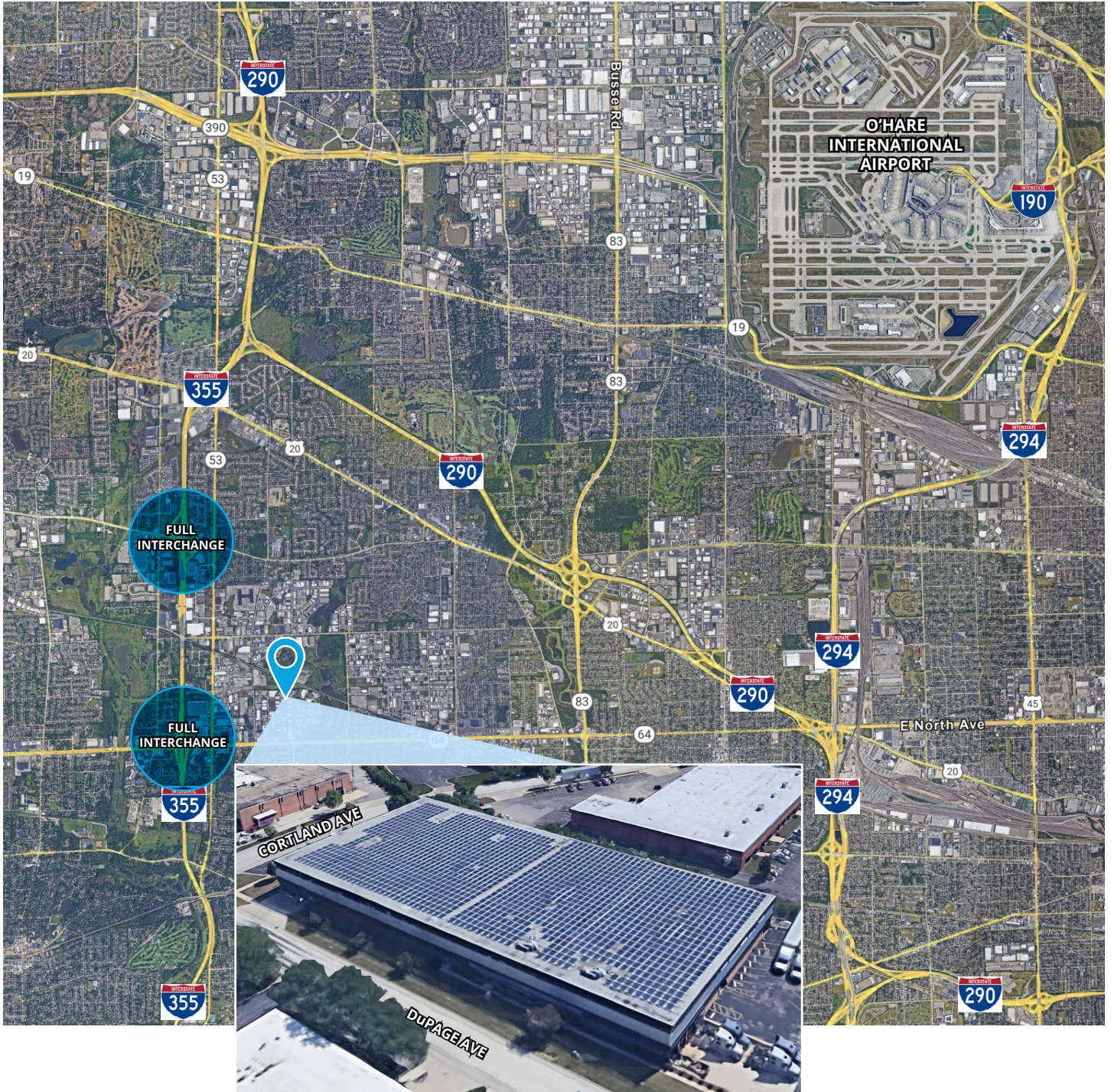

CONTACT US

John D'Orazio
+1 847 384 2823
john.dorazio@colliers.com

Reed Adler
+1 847 384 2810
reed.adler@colliers.com



Colliers
6250 N. River Rd. | Suite 11-100
Rosemont, IL 60018
+1 847 698 8444
www.colliers.com/chicago