

FOR LEASE

TROY TECHNOLOGY PARK - BLDG A



1960 TECHNOLOGY DRIVE

TROY, MI 48083

PROPERTY HIGHLIGHTS:

- 3-story office Building located in the front of Troy Technology Park
- Large, open floor plates with expansive window lines
- Suites ranging from +/- 2,000 SF up to a full floor for +/- 28,000 SF of office space
- Recently renovated lobbies and common areas throughout the building
- 10' ceiling heights with abundant window lines
- Competitive leasing terms and incentives for qualified tenants in Troy Technology Park
- Prominent building façade and monument signage along John R or Industrial Drive
- Dedicated property management team committed to providing responsive service and maintaining high standards
- Fiber-optic internet connectivity and infrastructure in place
- Ample parking and easy access for employees and visitors
- Major automotive and technology companies located within the Park including Magna Powertrain, LG Energy, LG Electronics, LabCorp Group, Rousch Industries, and many more
- Troy Technology Park is situated just North of the Oakland Mall and within proximity of several restaurants and entertainment venues

The information provided herein along with any attachment(s) was obtained from sources believed to be reliable, however, Friedman Real Estate makes no guarantees, warranties, or representations as to the completeness or accuracy of such information and legal counsel is advised. All information provided is subject to verification and no liability for reliance on such information or errors or omissions is assumed. The presentation of this property is submitted subject to errors, omissions, change of price or conditions, prior sale or lease, or withdrawal without notice. Copyright © 2025 Friedman Real Estate. All rights reserved.

FOR MORE INFORMATION PLEASE CONTACT:



ROBERT GAGNIUK

Director, Commercial Portfolio Leasing
robert.gagniuk@freg.com



JARED FRIEDMAN

Executive Vice President
jared.friedman@freg.com

248.324.2000

eCODE 390

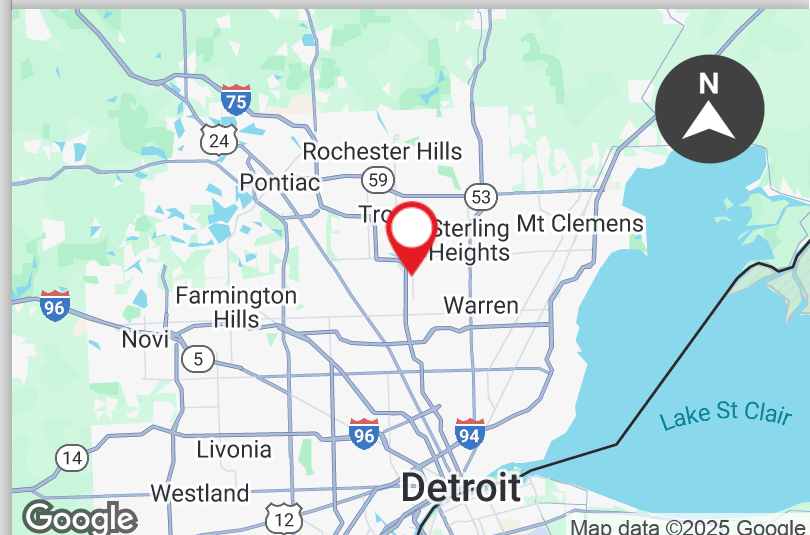

TROY TECHNOLOGY PARK - BLDG A

PROPERTY **AVAILABILITY**

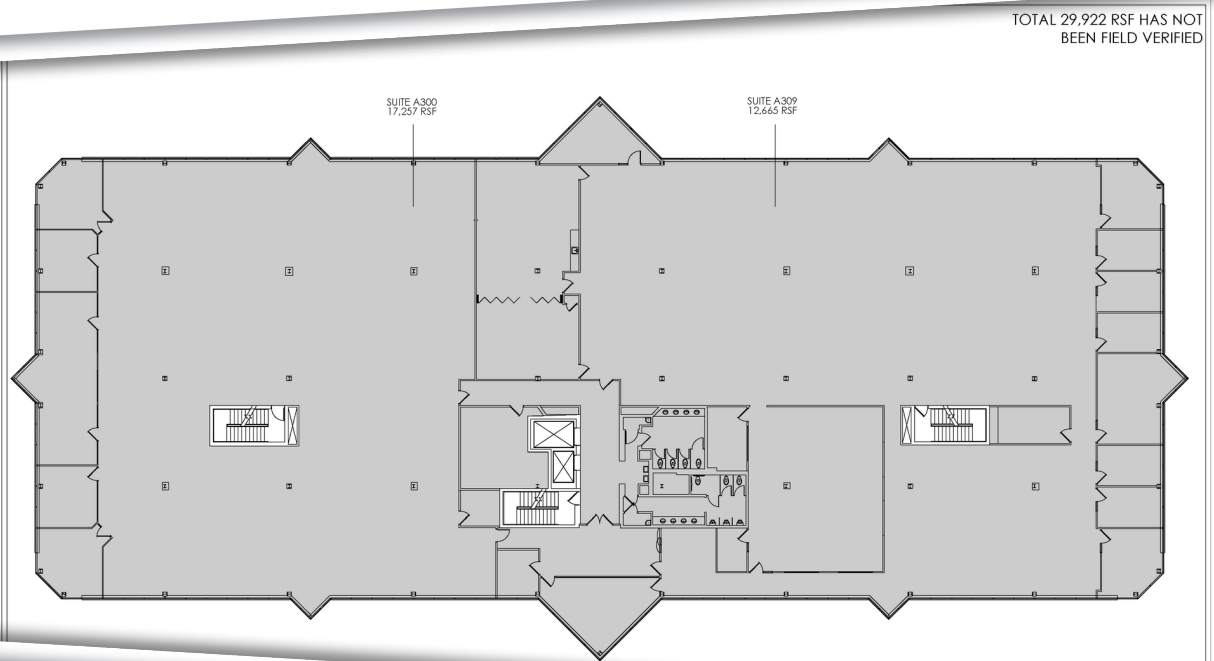

AVAILABLE SUITES

SPACE	SPACE USE	LEASE RATE	LEASE TYPE	SIZE (SF)
Suite A130	Office	\$16.95 SF/yr	Modified Gross + Electric	1,807 SF
Suite A300	Office	\$16.95 SF/yr	Modified Gross + Electric	17,257 SF
Suite A309	Office	\$16.95 SF/yr	Modified Gross + Electric	12,665 SF
Third Floor - (A300+A309)	Office	\$16.95 SF/yr	Modified Gross + Electric	29,922 SF

TROY TECHNOLOGY PARK - BLDG A ADDITIONAL **PHOTOS**

