

F O R L E A S E



CBRE

1544 Eureka Road

R O S E V I L L E , C A

PROPERTY HIGHLIGHTS

SPACE AVAILABLE:

Suite 100 | ±2,103 RSF

Suite 120 | ±1,976 RSF

Suite 125 | ±5,693 RSF

Suite 200 | ±5,386 RSF | Available February 1, 2026

Suite 260 | ±1,599 RSF

LEASE RATE: \$2.25 PSF, Full Service Gross

- Prestigious Eureka Corporate Plaza address
- Amazing natural lighting
- First floor restrooms have lockers and showers

NEARBY AMENITIES

Walk to some of Roseville's most popular Restaurants:

Fat's, Paul Martin's, Blue Nami, Sienna, Mikuni's Sushi, Bennett's Kitchen Bar
Market, My Thai Kitchen, Beach Hut Deli, Panda Express

Local to Boutique and Regional Shopping and Services:

Stone Point Retail Center, Creekside Town Center, The Fountains Lifestyle
Center, The Westfield Galleria Mall

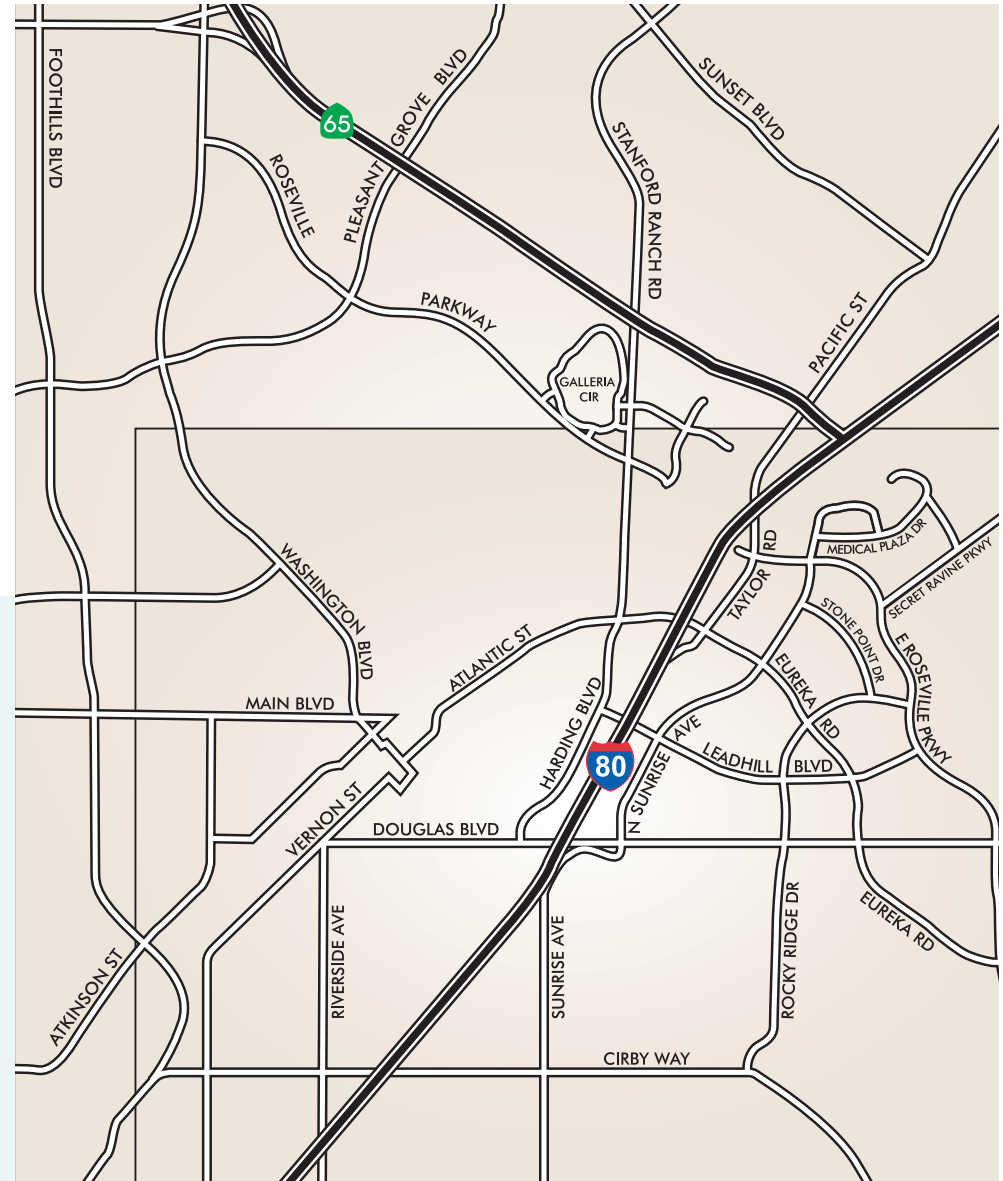

FLOOR PLAN

First Floor

\$2.25 PSF/Month, FSG



FLOOR PLAN

Second Floor

\$2.25 PSF/Month, FSG

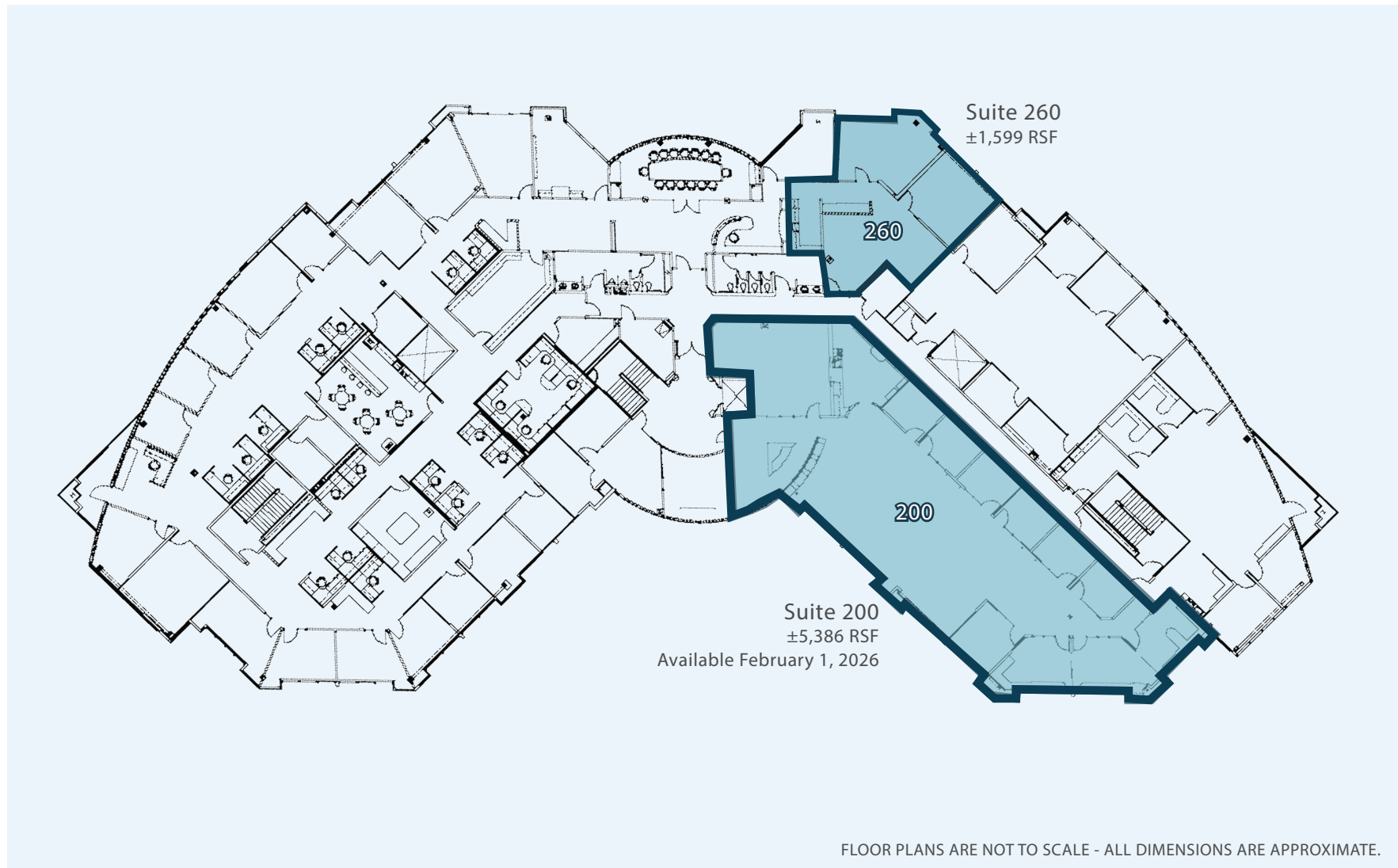

A E R I A L V I E W



1544
Eureka Road



FOR MORE INFORMATION,
CONTACT:

KEVIN LARSCHEID
Executive Vice President
+1 916 781 4818
kevin.larscheid@cbre.com
Lic. 00816790

SCOTT RUSH
First Vice President
+1 916 781 4802
scott.rush@cbre.com
Lic. 01228479

© 2025 CBRE, Inc. All rights reserved. This information has been obtained from sources believed reliable but has not been verified for accuracy or completeness. You should conduct a careful, independent investigation of the property and verify all information. Any reliance on this information is solely at your own risk. CBRE and the CBRE logo are service marks of CBRE, Inc. All other marks displayed on this document are the property of their respective owners, and the use of such logos does not imply any affiliation with or endorsement of CBRE. Photos herein are the property of their respective owners. Use of these images without the express written consent of the owner is prohibited. CMPM Eureka Rd, 1544 Final 12/17/25

CBRE