

FOR SALE: INTELLIFLEX 1,536 SF FLEX CONDOMINIUM

12811 Commerce Lakes Dr., Unit 11, Ft. Myers, FL 33913



**HUGE
PRICE
DROP!!!**

FOR SALE: Unit 11
UNIT SIZE: 1,536 SF
SALE PRICE: \$375,000.00
SALE PRICE (PSF): \$244.00/SF

PROPERTY FEATURES

- Zoning: PUD (Planned unit Development)
- 1 Office - 18' x 20'
- 1 -10' x 12' Overhead door
- Warehouse clearance 18'
- Concrete tilt up construction
- Hurricane Impact Glass
- Abundant parking
- Extensive exterior lighting
- Unit 11 can be sold with Units 12 thru 17

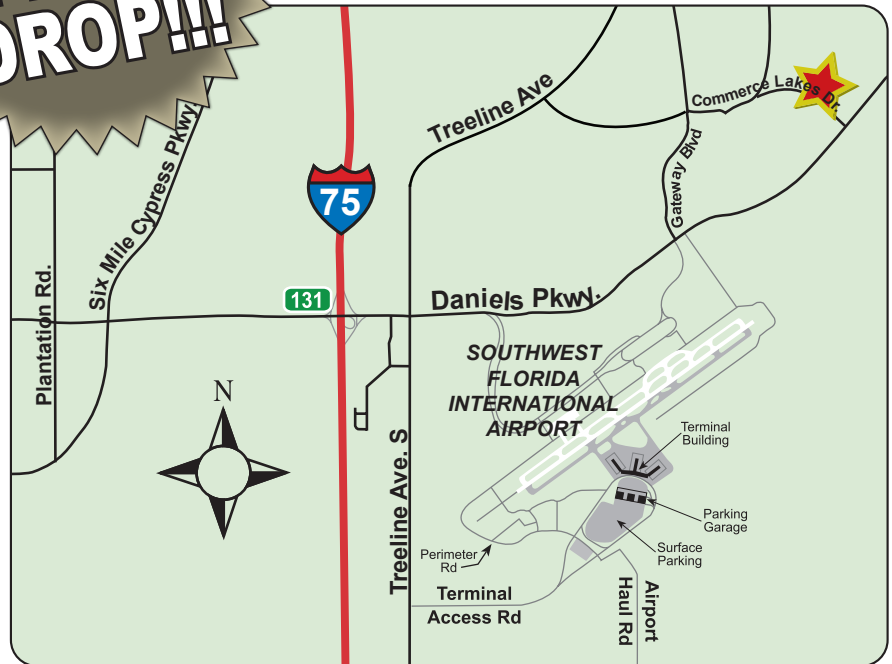

LOCATION

- Central location off Daniels Parkway in Gateway community
- Minutes from I-75 and Southwest Florida International Airport



For more information
please contact:

Rodney Fidler, CCIM
Principal
Direct 239.470.2317
Rodney@FidlerRealEstate.com

The information contained herein was obtained from sources believed reliable, however, Fidler Real Estate Services makes no guarantees, warranties or representations as to the completeness or accuracy thereof. The presentation of this property is submitted subject to errors, omissions, change of price or conditions prior to sale or lease or withdrawal without notice.

FOR SALE: INTELLIFLEX

1,536 SF FLEX CONDOMINIUM

12811 Commerce Lakes Dr., Unit 11, Ft. Myers, FL 33913



Units 12 thru 17 are also available for sale, and if interested please ask us for details...

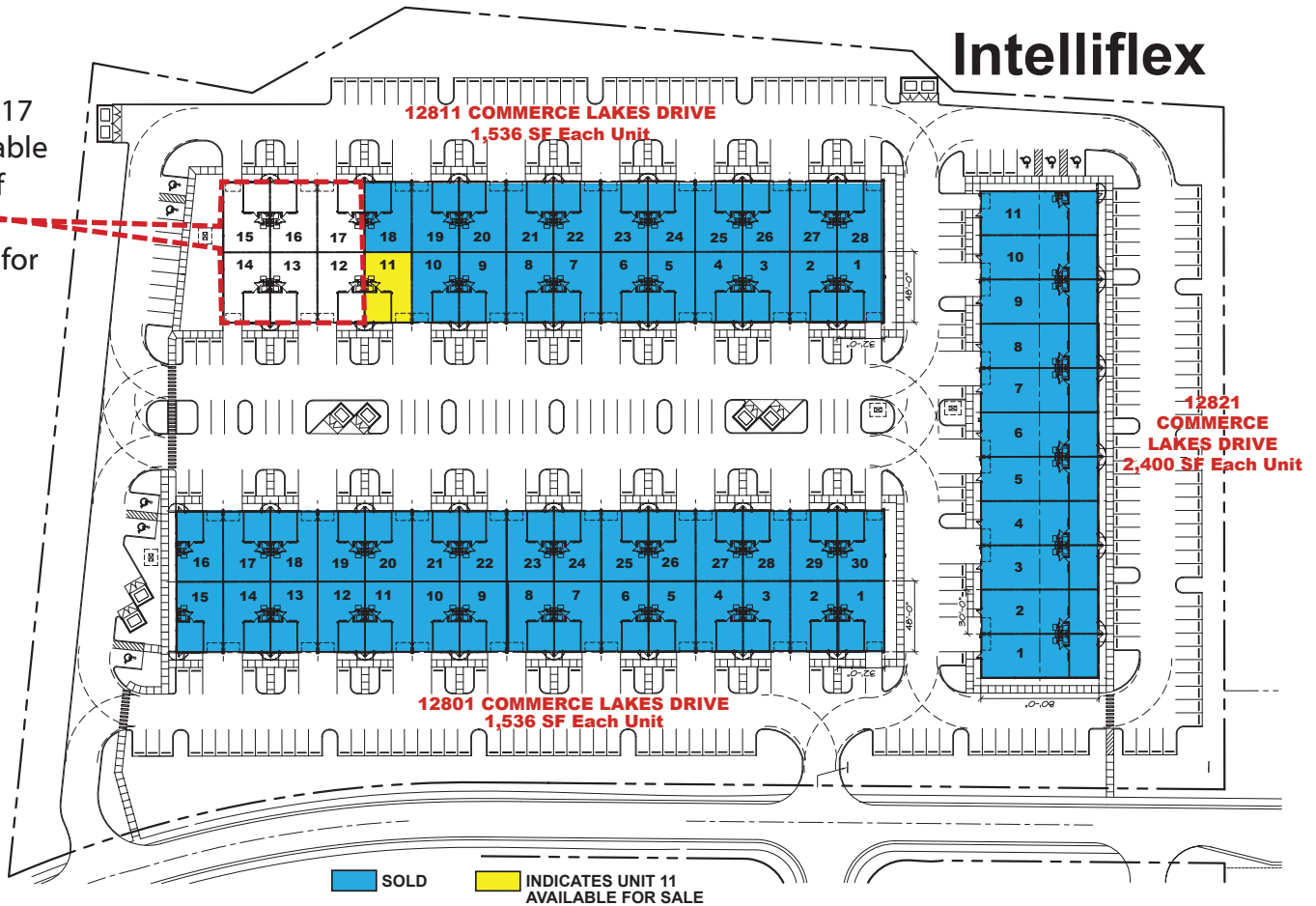

Intelliflex



* Photos represent typical unit



Rodney Fidler, CCIM
Principal
Direct 239.470.2317
Rodney@FidlerRealEstate.com

FOR SALE: INTELLIFLEX 1,536 SF FLEX CONDOMINIUM

12811 Commerce Lakes Dr., Unit 11, Ft. Myers, FL 33913



FLOOR PLAN

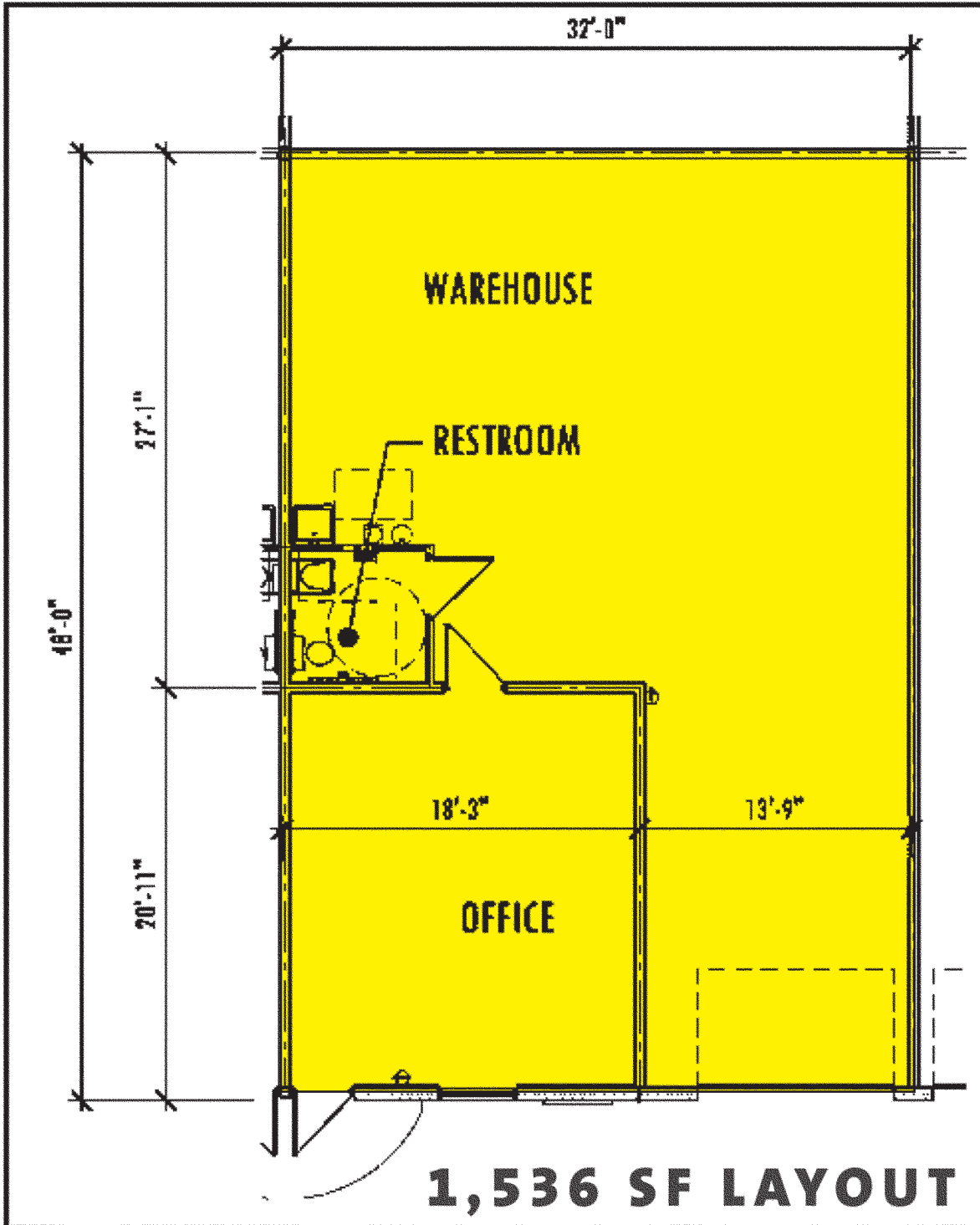

Rodney Fidler, CCIM
Principal
Direct 239.470.2317
Rodney@FidlerRealEstate.com