

200 Gary Avenue

Roselle, IL

Key Facts

Property type	Industrial space
---------------	------------------

Building size	483,873 SF
---------------	------------

Space available	483,873 SF
-----------------	------------



Contact Us

Learn more about this property or schedule a tour by reaching out to our local investment and leasing officer.

John Quinnelly

+1 (251) 550-1001

john.quinnelly@eqtpartners.com

Jason DeFilippis

+1 (847) 867-4937

jason.defilippis@eqtpartners.com

200 Gary Avenue

Roselle, IL

Building Specifications

Industrial space available	Docks: 40 docks (38 exterior + 2 interior)
483,873 SF total building size	Drive in Doors: 2) 12'x14'
483,873 SF available size	Bay Size: 48' x 40'
First Floor Office: 29,534 SF	Parking: 273 Stalls (expandable)
Second Floor Office: 28,981 SF	Power: 3000 Amp, 480 / 277 Volt
Clear Height: 24'-6"	Sprinkler System: ESFR

Location

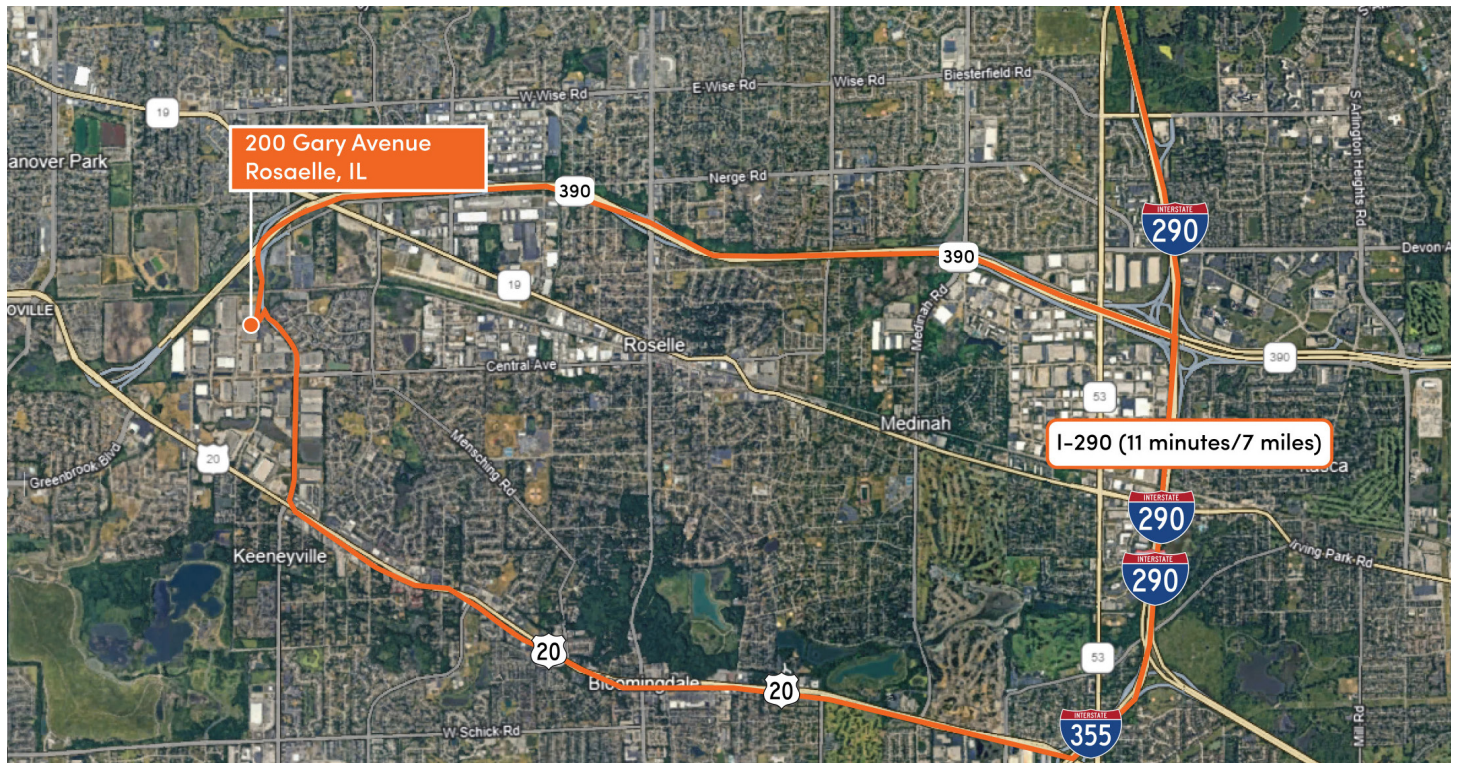

Contact Us

Learn more about this property or schedule a tour by reaching out to our local investment and leasing officer.

John Quinnelly

+1 (251) 550-1001

john.quinnelly@eqtpartners.com

Jason DeFilippis

+1 (847) 867-4937

jason.defilippis@eqtpartners.com

200 Gary Avenue

Roselle, IL



Contact Us

Learn more about this property or schedule a tour by reaching out to our local investment and leasing officer.

John Quinnelly

+1 (251) 550-1001

john.quinnelly@eqtpartners.com

Jason DeFilippis

+1 (847) 867-4937

jason.defilippis@eqtpartners.com

200 Gary Avenue

Roselle, IL

Demising Option 174k-281k

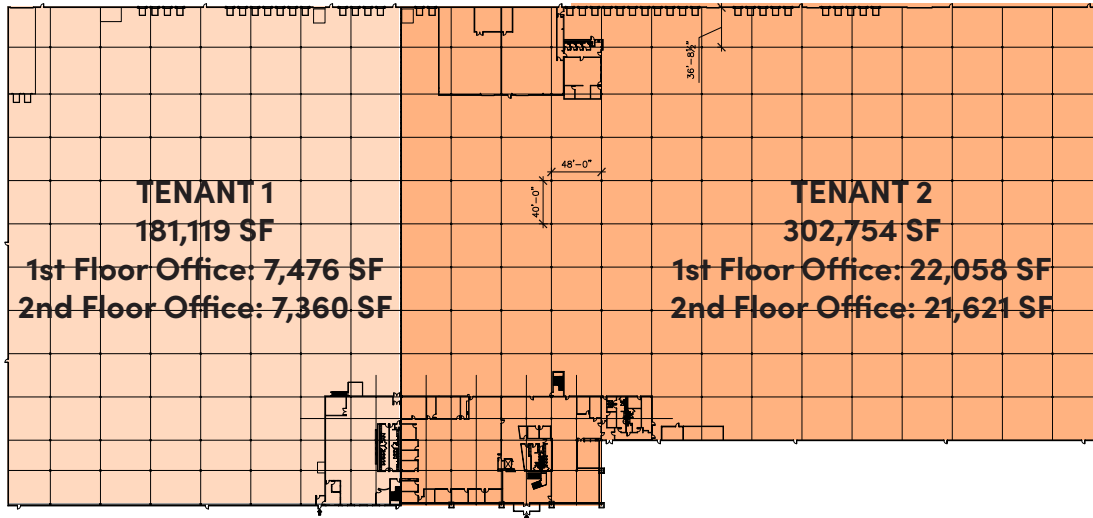

Demising Option 218k-237k

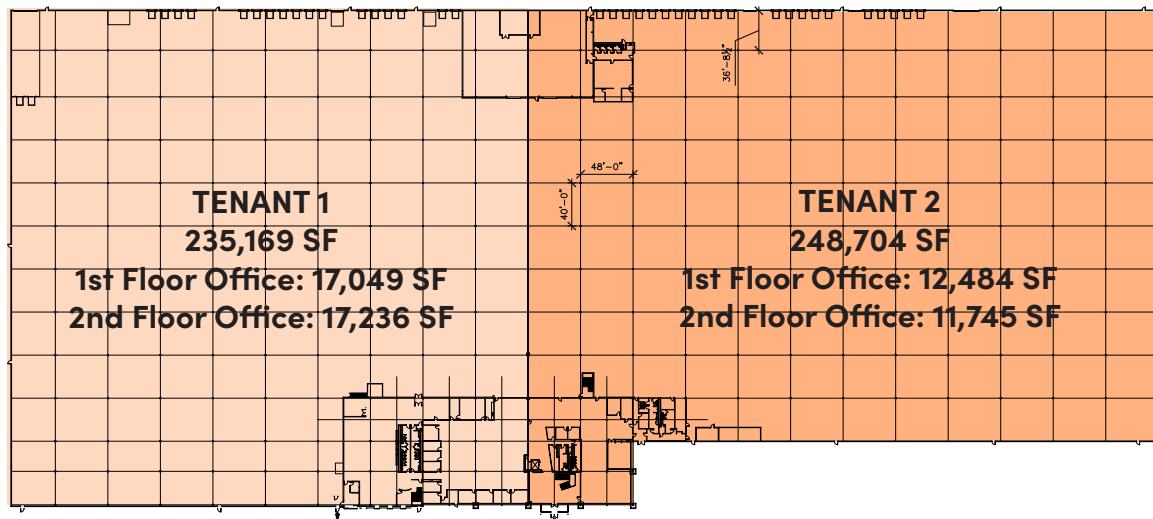

Contact Us

Learn more about this property or schedule a tour by reaching out to our local investment and leasing officer.

John Quinnelly

+1 (251) 550-1001

john.quinnelly@eqtpartners.com

Jason DeFilippis

+1 (847) 867-4937

jason.defilippis@eqtpartners.com