

320 BIRCH STREET

FOR SALE: 2.54 INDUSTRIAL ACRES

MILTON, WA 98354

INDUSTRIAL PROPERTY FOR SALE / PRIME I-5 VISIBILITY



SALE INFORMATION

SEPA Approval 95% Complete
Expect Final MDNS January 2025

Land Size:	±2.54 AC
Zoning:	M-1 Light Mftg (City of Milton)
Building Size:	SEPA for ±45,713 SF
Office Size:	Build-to-suit
Loading:	1 GL & 16 DH Doors
Flexibility:	Buyer can design alternative building
Sale Price (Land):	Call broker for details

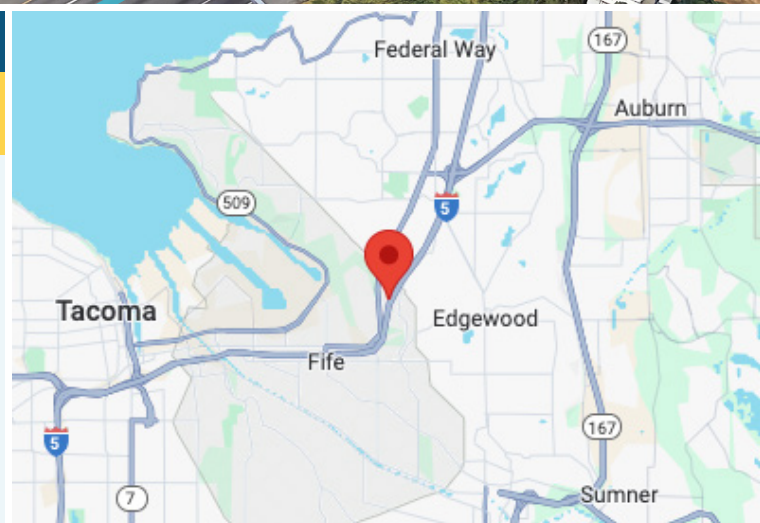

SCOTT PRICE
253.779.2419

sprice@neilwalter.com

SAM HIGHSMITH
253.779.2434

shighsmith@neilwalter.com

All information references in this document are approximate. The information contained herein is contained from sources deemed reliable. It is provided without representation, warranty, or guarantee, expressed or implied as to accuracy. Prospective buyer or tenant should conduct its own independent investigation relating to the property, government codes and regulations, allowed uses, and all other matters, regardless of whether they are referred to or contained in this document.

320 BIRCH STREET

MILTON, WA 98354



Building Size	Office Size	Dock High Doors	Grade Level Doors
± 45,713 SF	Build-to-suit	16	1

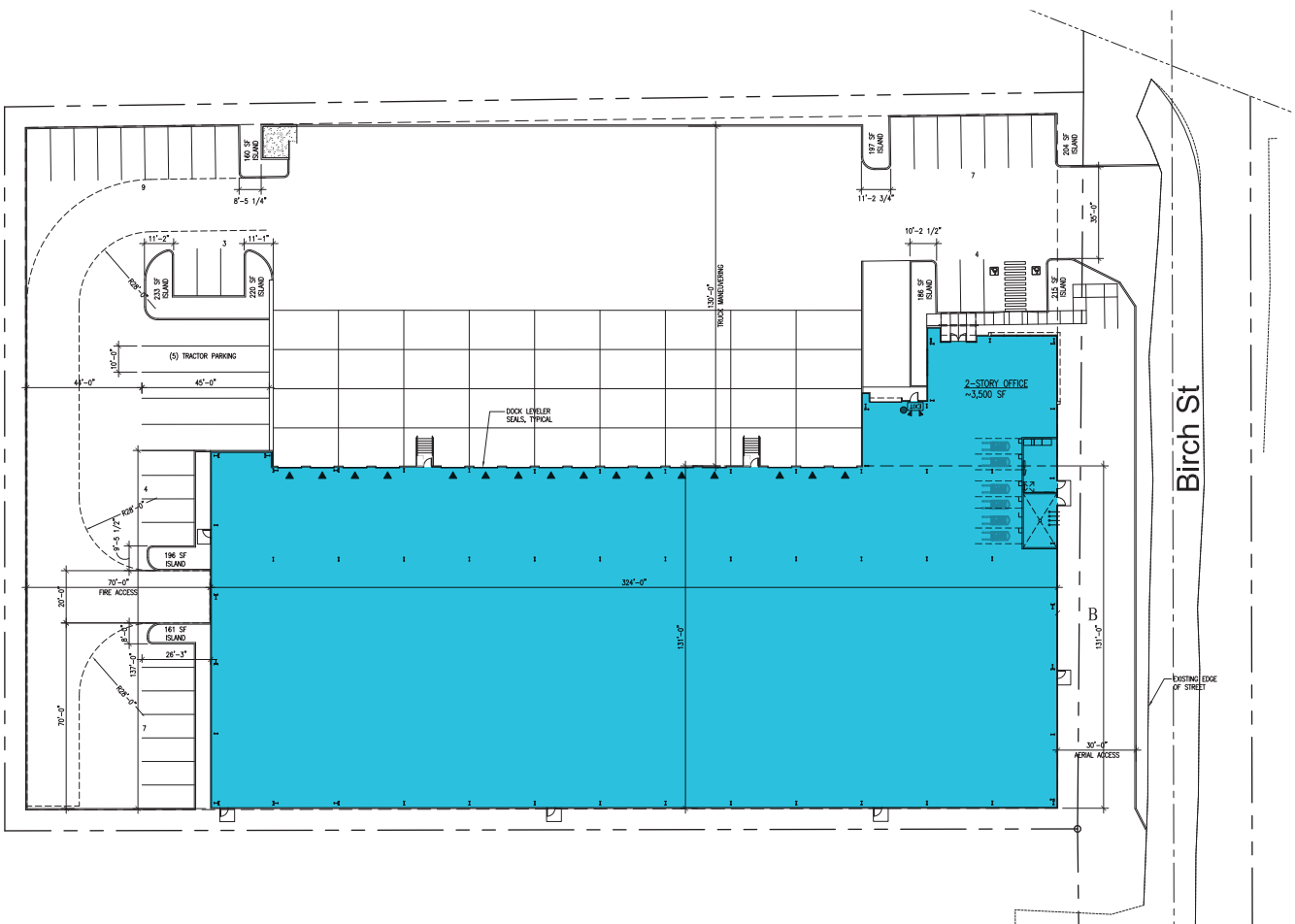

SCOTT PRICE
 253.279.3710
 sprice@neilwalter.com

SAM HIGHSMITH
 253.779.2434
 shighsmith@neilwalter.com

550 S Michigan St
 Seattle, WA 98108
 206.787.1800
 www.neilwalter.com

All information references in this document are approximate. The information contained herein is contained from sources deemed reliable. It is provided without representation, warranty, or guarantee, expressed or implied as to accuracy. Prospective buyer or tenant should conduct its own independent investigation relating to the property, government codes and regulations, allowed uses, and all other matters, regardless of whether they are referred to or contained in this document.