

# FOR LEASE ±13,569 SF

## FREE STANDING INDUSTRIAL BUILDING

# 13201

Barton Circle  
Santa Fe Springs | CA

**\$1.24 NNN**

*Extremely Low NNN Fees,  
Available Now!*

### Property Highlights

- Freestanding Industrial Building
- ±3,600 Sq. Ft. of Deluxe Office Space (Portion can be removed)
- One (1) Oversized Ground Level Loading Door 12' H x 18' W
- Fire Spinklers
- ±16' Ceiling Height
- Well Distributed Heavy Power, 800 Amps, 277/480V
- Great Corner Location
- Excellent Access to the Santa Ana (5), San Gabriel (605) and Century (105) Freeways
- NNN Operating Expenses Estimated at \$0.1563 PSF.

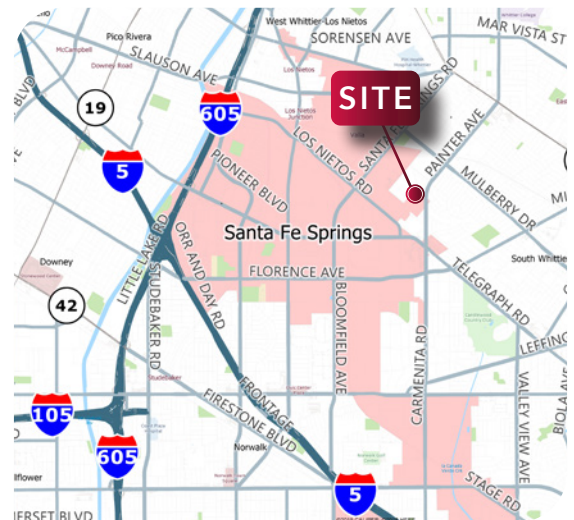

FOR MORE INFORMATION PLEASE CONTACT:

#### Phillip DeRousse

Principal | Lee & Associates

D: 714.564.7141

pderousse@lee-associates.com

DRE# 01933061

#### Joel Hutak

Principal | Lee & Associates

D: 714.564.7169

jhutak@lee-associates.com

DRE# 01411356

#### Bart McNulty

Agent | Lee & Associates

D: 714.564.7121

bmcnulty@lee-associates.com

DRE# 02153750



All information contained herein has been provided by Seller/Lessor and/or third parties, but has not been independently verified by Lee & Associates or its agent(s). Buyer/Lessee and interested parties should independently verify all information communicated by these sources.

# **FOR LEASE** ±13,569 SF

## **FREE STANDING INDUSTRIAL BUILDING**

# 13201

Barton Circle  
Santa Fe Springs | CA

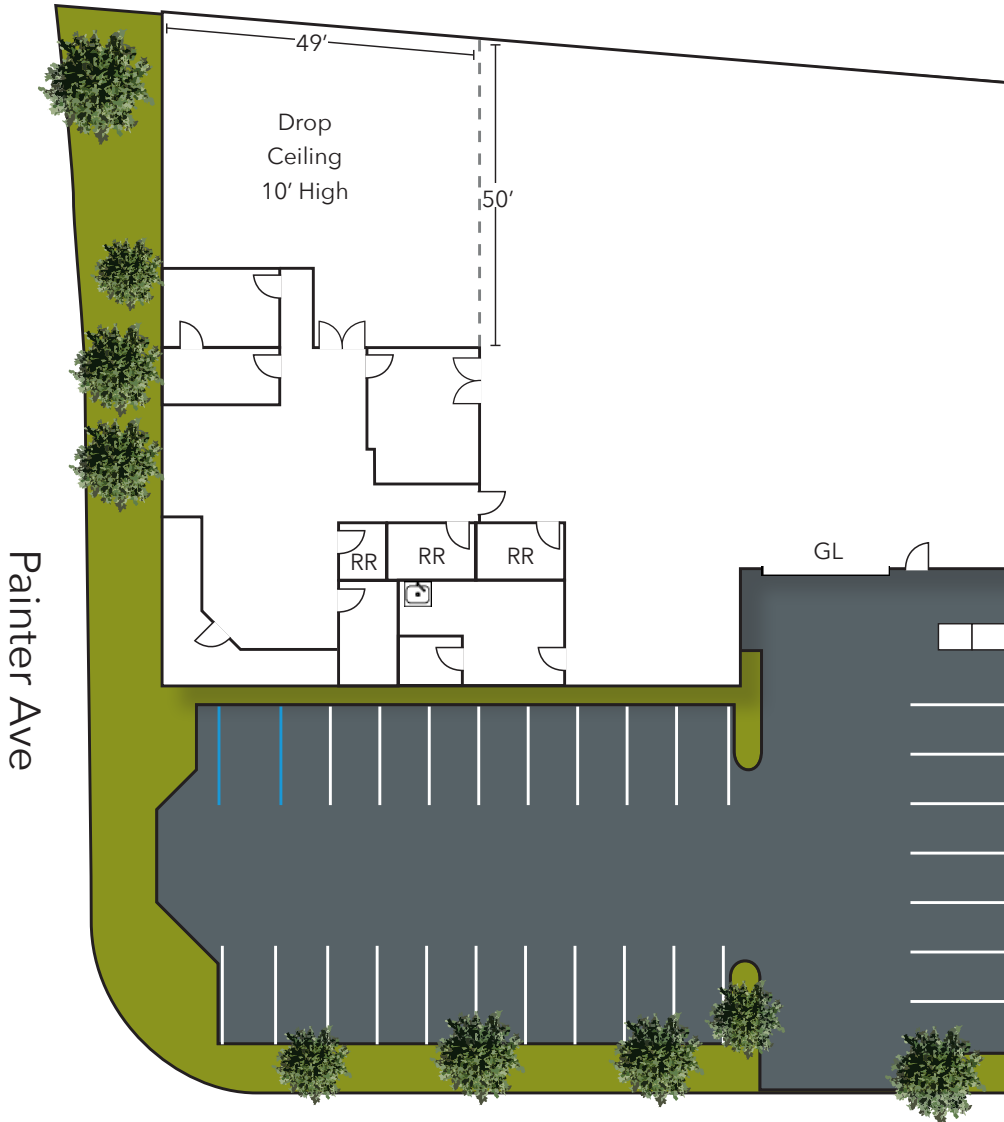

Barton Cir

Not to Scale

**FOR MORE INFORMATION PLEASE CONTACT:**

### **Phillip DeRousse**

Principal | Lee & Associates

**D: 714.564.7141**

[pderousse@lee-associates.com](mailto:pderousse@lee-associates.com)

DRE# 01933061

### **Joel Hutak**

Principal | Lee & Associates

**D: 714.564.7169**

[jhutak@lee-associates.com](mailto:jhutak@lee-associates.com)

DRE# 01411356

### **Bart McNulty**

Agent | Lee & Associates

**D: 714.564.7121**

[bmcnulty@lee-associates.com](mailto:bmcnulty@lee-associates.com)

DRE# 02153750



All information contained herein has been provided by Seller/Lessor and/or third parties, but has not been independently verified by Lee & Associates or its agent(s). Buyer/Lessee and interested parties should independently verify all information communicated by these sources.