

2500 SOUTH 3850 WEST

WEST VALLEY CITY, UT 84120



OFFICE, OFFICE/WAREHOUSE OR FLEX/R&D LEASE
AVAILABLE IMMEDIATELY

2,554 - ~30,000 RSF

BUILDING INFORMATION

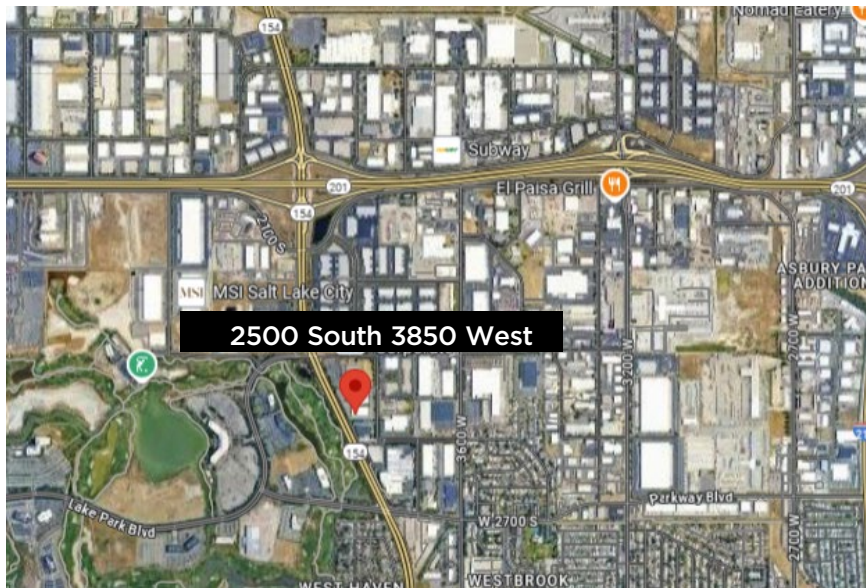

BUILDING

Waterton Place

ADDRESS

2500 South 3850 West
West Valley City, UT 84120

AVAILABLE

Immediately

ASKING RATE

\$10.00/RSF NNN or \$0.833/SF

ADDITIONAL FEATURES

- Office, Office/Warehouse, or Flex/R&D
- Divisible: 2,554 to approx. 30,000 RSF
- Warehouse: Min. 2,000 to approx. 20,000 RSF
- 12' GL door and 14' clear height (potential)
- Shared breakroom
- Immediate access to Bangerter Highway

FLOOR PLAN

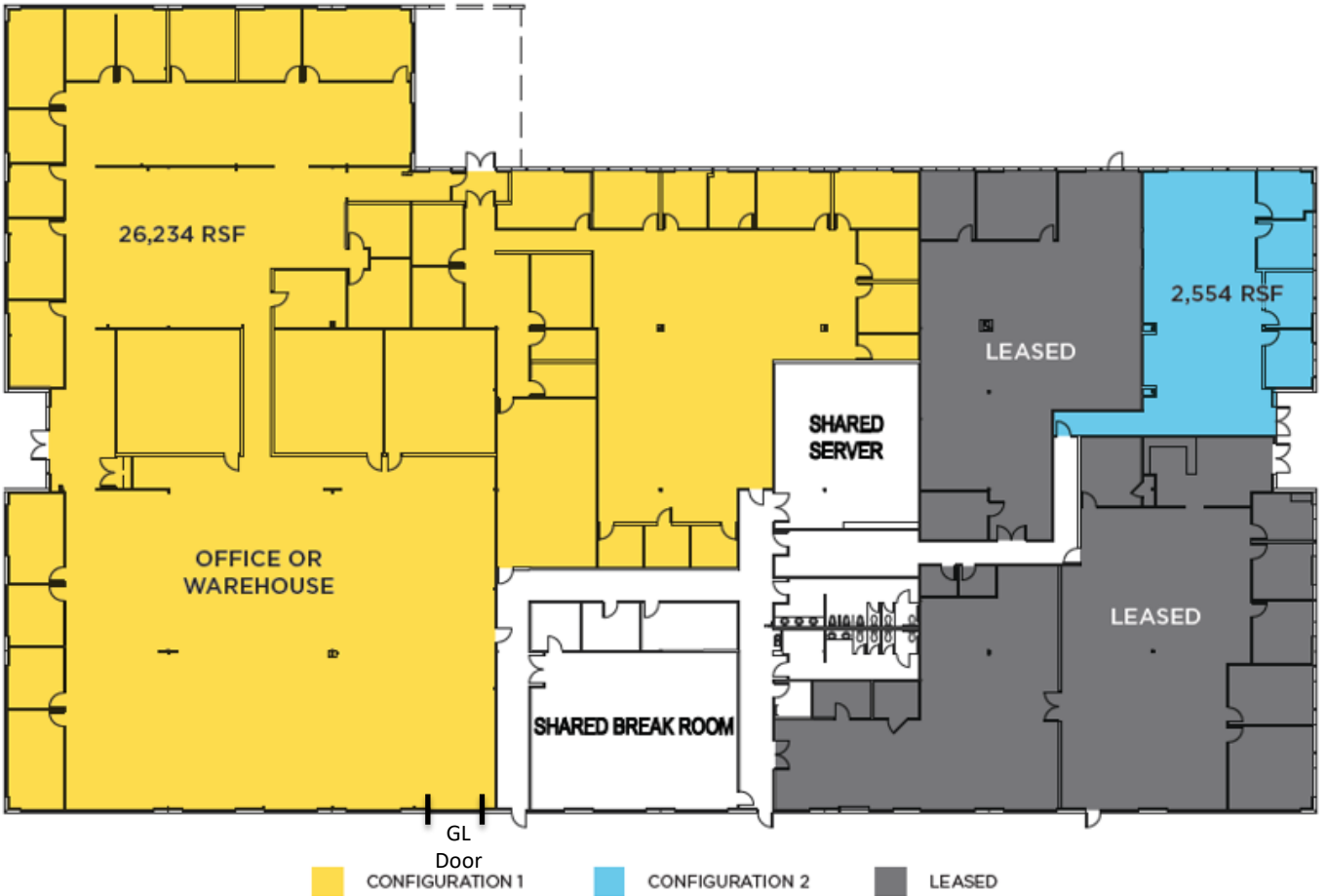

FLOOR PLAN



2500 SOUTH 3850 WEST



CONTACT INFORMATION



LORA MUNSON, CCIM

lora.munson@hughesmarino.com

801.706.5982

Broker Lic. #5468065-PB00

6985 UNION PARK CENTER, SUITE 650

COTTONWOOD HEIGHTS, UT 84047

801.981.2111 | hughesmarino.com

HUGHESMARINO
S.L.C., INC.