

# 2101 L STREET

DISTRICT OF COLUMBIA



**JBG SMITH**

## LOCATION

District of Columbia  
2101 L Street  
Washington, DC 20037

## SPACE AVAILABLE

2,320 - 6,172 sq. ft.

## PROPERTY OVERVIEW

2101 L Street is a high-visibility, corner location at the intersection of 21st and L Streets NW. Home to an array of first class tenants, the building offers superior, direct access to major interstates and is readily accessible via the Foggy Bottom Metro.

## CURRENT RETAILERS

Citibank, Bright Horizons Children Center, Bourbon Coffee Cafe, SOI 38

## DEMOGRAPHICS

RADIUS	HH INCOME	POPULATION
1 mile:	\$101,299	55,892
3 mile:	\$98,028	365,908
5 mile:	\$90,936	778,301

## TRAFFIC COUNT

14,100 vehicles daily on L Street NW



## CONTACT

**Bob Schwenger** | 301.657.7331  
bschwenger@jbgsmith.com

**Ben Brehne** | 240.333.7713  
bbrehne@jbgsmith.com

# 2101 L STREET / SITE PLAN



SHOPPING CENTER RETAILERS		
1	Bright Horizons	
2	Leased	
3	Soi 38	
4	Available	3,852 SF
5	Available	2,320 SF
6	Bourbon Coffee	
7	Citibank	

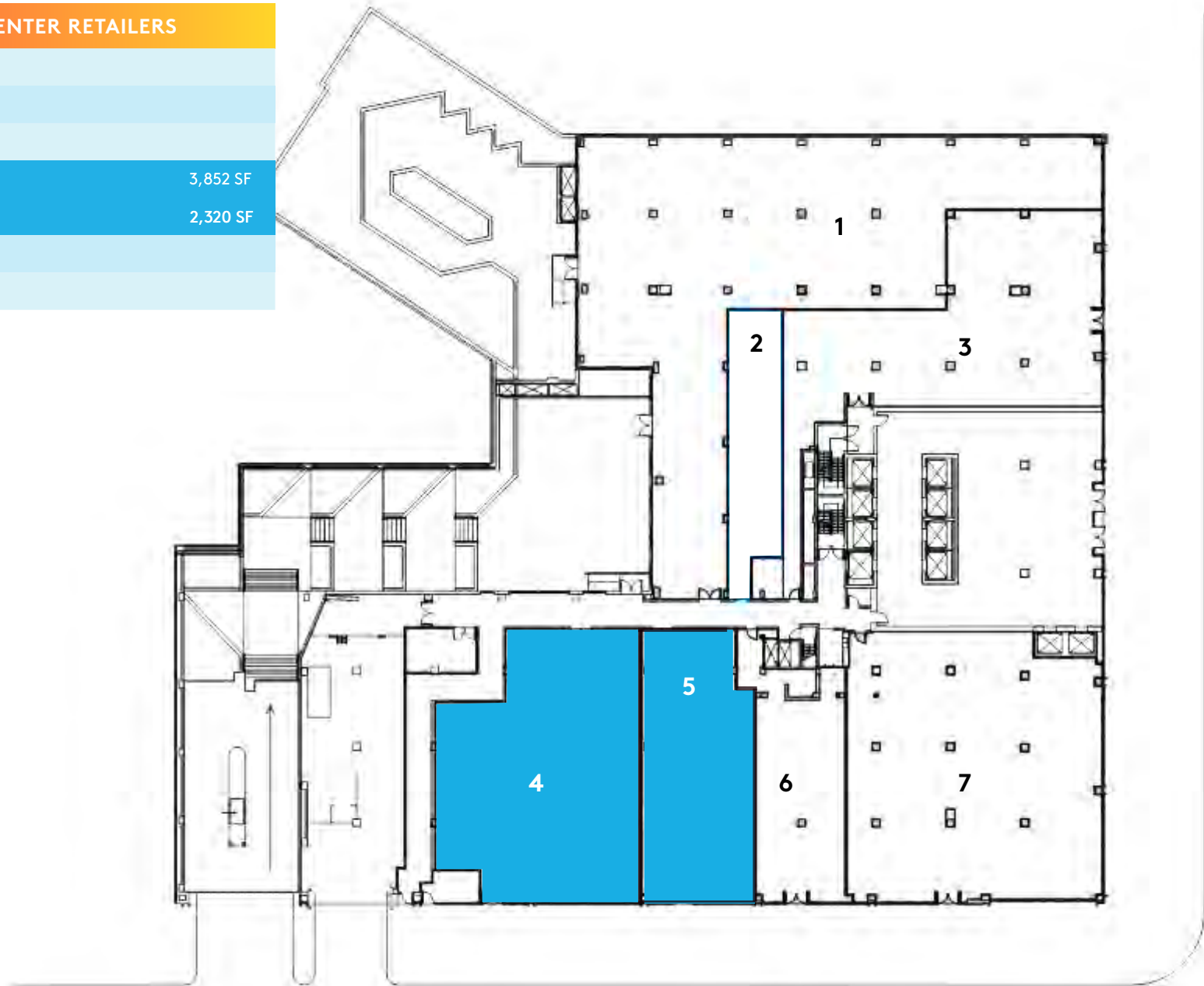

# 2101 L STREET / AERIAL

## NEARBY RETAILERS

- 1 Best Western
- 2 Exxon
- 3 Bobby's Burger Palace
- 4 Domino's Pizza
- 5 CVS, Sun Trust Bank
- 6 AT&T

## PLACES OF INTEREST

- Washington Circle Park
- The White House

