

GPN 7991-09-6721
 N/F PRINCE WILLIAM COUNTY BOARD OF SUPERVISORS
 ZONED A-1
 USE: CEMETARY ON PARCEL LANDFILL BUFFER

LEGEND:

- LARGE DECIDUOUS TREE
- MEDIUM / COMPACT DECIDUOUS TREE
- LARGE EVERGREEN TREE
- MEDIUM / COMPACT EVERGREEN TREE
- SHRUBS

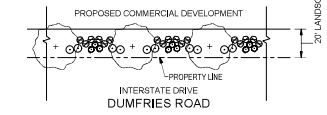

20-FOOT BUFFER AND EXTRA VARIABLE WIDTH (TO BE NO LESS THAN 20-FEET) N.T.S.

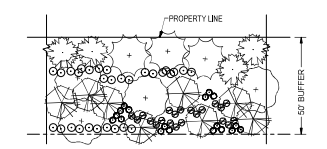

50' TYPE-C LANDSCAPE BUFFER - 320 PU / 100 LF N.T.S.

NOTE "A":

- PROPOSED PLANTING/PRESERVATION AREA
- ALL REASONABLE EFFORTS WILL BE MADE TO PRESERVE THESE MATURE TREE AREAS.
- FINAL AREAS AND PLANTINGS TO BE DETERMINED AT SITE PLAN

NOTE "B":

- LANDSCAPE ENHANCEMENT AREA THAT MAY CONTAIN UTILITIES EASEMENTS

OPEN SPACE CALCULATION
 Minimum 30%

OWNER/ APPLICANT

MINNIEVILLE CAPITAL ACQUISITIONS LLC
 1390 CHAIN BRIDGE RD
 PMB 56035
 MCLEAN, VA 22101

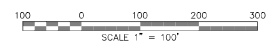

DATE: 04-08-2024

SCALE: 1" = 100'
 DATE: 04-08-2024
 DESIGNED: HAL
 DRAFTED: MB
 REVISIONS:

MID-COUNTY INDUSTRIAL PARK
 PRINCE WILLIAM COUNTY, VIRGINIA
 GENERALIZED DEVELOPMENT PLAN - REZ2024-00006

HAROLD A. LOGAN ASSOCIATES P.C.
 LAND SURVEYING - SITE PLANNING - SUBDIVISION DESIGN
 2114 INDUSTRY DRIVE
 MANASSAS PARK, VA, 20111 (703) 330-1988
 LOGANASSOC@GMAIL.COM

SHEET
 3 OF 3
 P 3453