

**OFFICE BUILDING FOR LEASE**

## **LIBERTY III**

1317 EXECUTIVE BLVD, CHESAPEAKE, VA 23320





# LIBERTY III

1317 EXECUTIVE BLVD, CHESAPEAKE, VA 23320

## PROPERTY OVERVIEW



### OFFERING SUMMARY

<b>Available SF:</b>	6,263 - 7,580 SF
<b>Lease Rate:</b>	\$23.50 SF/yr (Full Service)
<b>Year Built:</b>	2006
<b>Building Size:</b>	73,583 SF

### AVAILABLE SPACES **SF**

Suite 100 (Avail 12/1/24)	7,580 SF
<b>Suite 130 Can Be Subdivided:</b>	<b>6,263 SF</b>
Suite 130	3,846 SF
Suite 170	2,417 SF

### PROPERTY OVERVIEW

This three story, Class A, brick and glass office building was built in 2006 with high quality fixtures, original artwork, and an open, two story atrium lobby overlooking the lake. Several attractive amenities are available for tenants including a walking trail, access to a fitness center, and proximity to the Towne Place at Greenbrier and the new Summit Pointe mixed-use center.

### PROPERTY HIGHLIGHTS

- First floor suite available
- Access to fitness center and shower facilities
- 24 Hour controlled access
- Abundant parking with 5.5 spaces per 1,000 square feet
- Advanced telecommunications
- On-site day porter
- LEED® Silver Certified
- Energy Star Certified

# LIBERTY III

1317 EXECUTIVE BLVD, CHESAPEAKE, VA 23320

SUITE 130 | 6,263 SF | CAN BE SUBDIVIDED

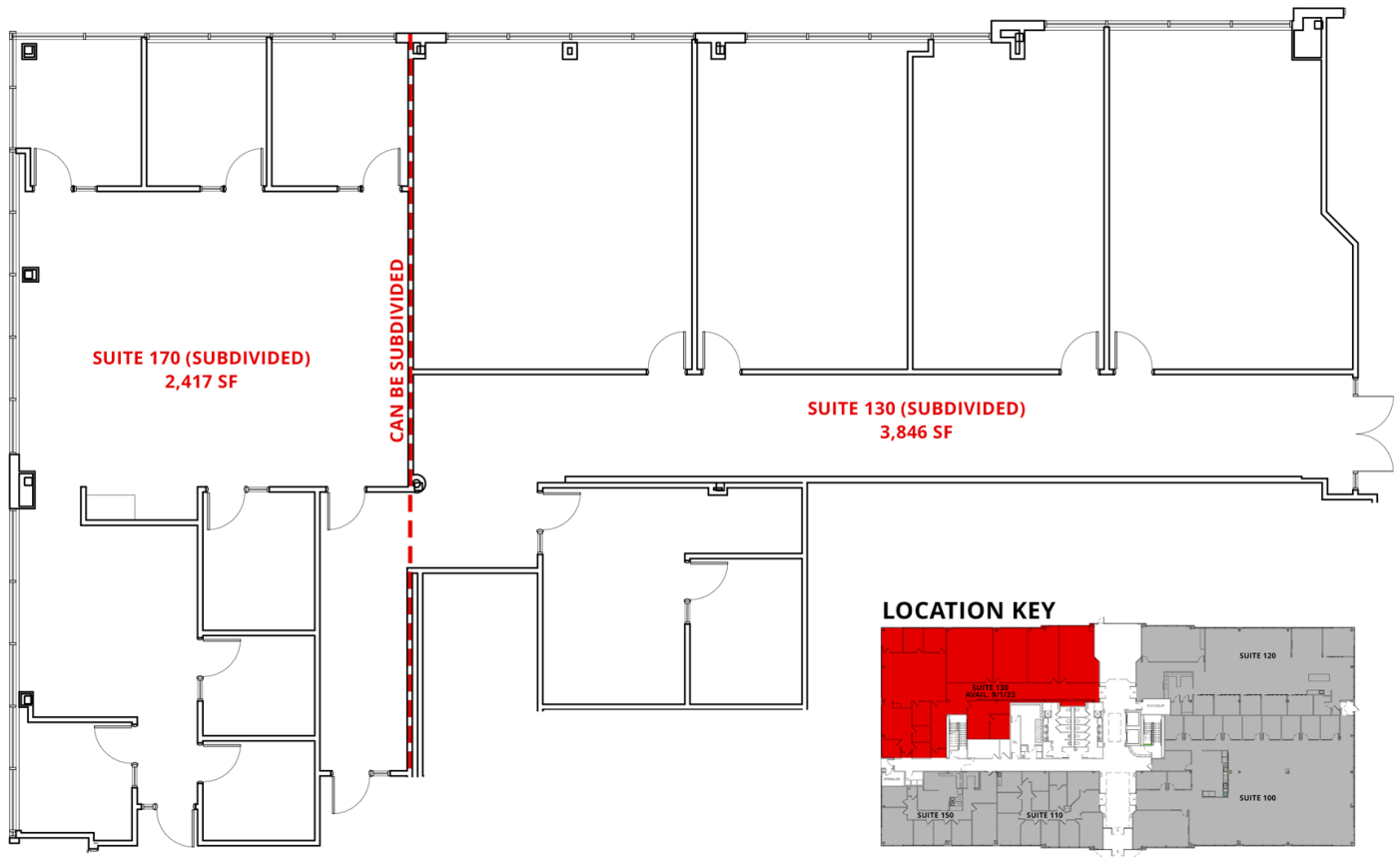



# LIBERTY III

1317 EXECUTIVE BLVD, CHESAPEAKE, VA 23320

ADDITIONAL PHOTOS



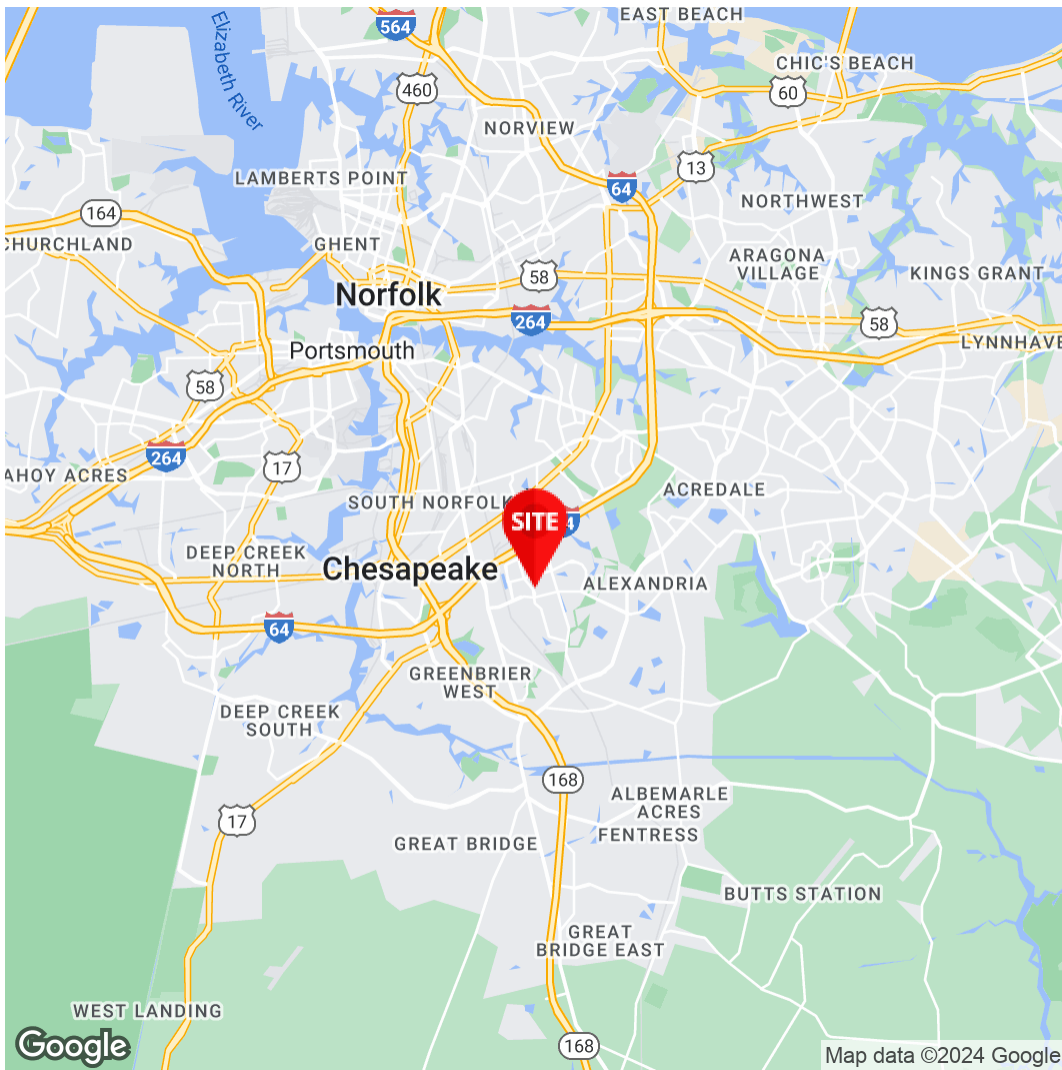

**Brian Devlin, CCIM**  
Senior Vice President  
757.333.4378  
Brian.Devlin@Divaris.Com

**Michael Divaris, SIOR**  
President  
757.497.2113  
Mdivaris@Divaris.Com

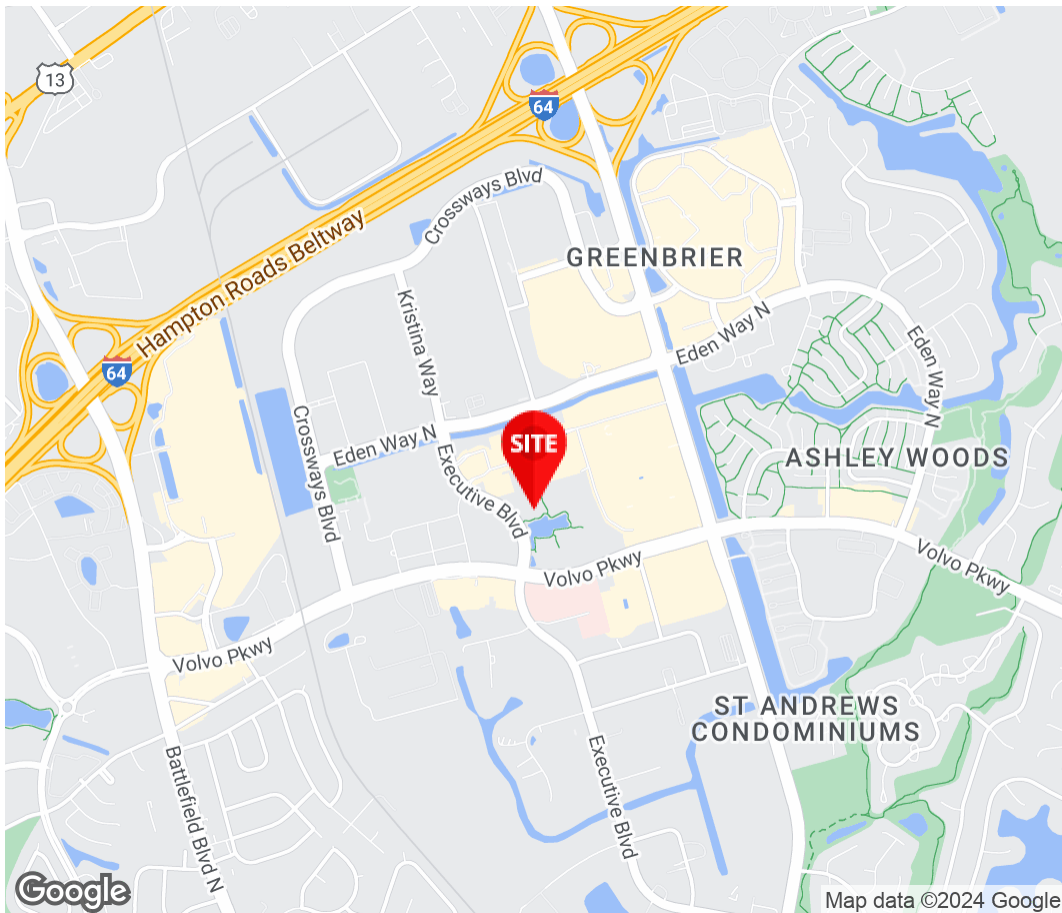

The information contained herein should be considered confidential and remains the sole property of Divaris Real Estate, Inc. at all times. Although every effort has been made to ensure accuracy, no liability will be accepted for any errors or omissions. Disclosure of any information contained herein is prohibited except with the express written permission of Divaris Real Estate, Inc.