

FOR SUBLEASE

#410, 3020 22 STREET
RED DEER, AB



PRICE REDUCED



SALOMONS
COMMERCIAL

Kelly Babcock
Partner
403.314.6188
kelly@salomonscommercial.com

#103, 4315 - 55 Avenue
Red Deer, AB T4N 4N7
www.salomonscommercial.com



About the Property

This 1,604 SF end cap unit is located in the bustling East Hill Shopping Centre, at the high-traffic corner of 30 Avenue and 22nd Street. The shopping centre hosts prominent businesses such as Save on Foods, Tim Horton's, McDonald's, Fas Gas, Tommy Guns, Dog & Cat Hospital, and Hucal & Edwards Orthodontics, ensuring a steady stream of potential customers.

The space boasts newer flooring and fresh paint, featuring a wide-open retail area with a sales counter, two changerooms, a washroom, and a private office/storage room. Track lighting and wrap-around windows on the southeast side provide ample natural light, enhancing the retail environment.

Included are two designated parking stalls, with additional common parking available. The unit is ready for immediate possession, presenting an excellent opportunity for your business.

Pylon signage is offered at an additional cost.

LEGAL DESCRIPTION

Plan 0124299, Block 8, Lot 1

UNIT SIZE

1,604 SF

LOCATION

Easthill Shopping Centre

ZONING

C2 - District Centre Commercial Zone

HEAD LEASE EXPIRY

February 28, 2026

LEASE RATE

~~\$28.00 PSF~~ **\$26.00 PSF** (rate applies until head lease expiration)

ADDITIONAL RENT

\$15.94 PSF + Management Fees

MONTHLY RENT

\$5,873 + GST

POSSESSION

Immediate



Floor Plan

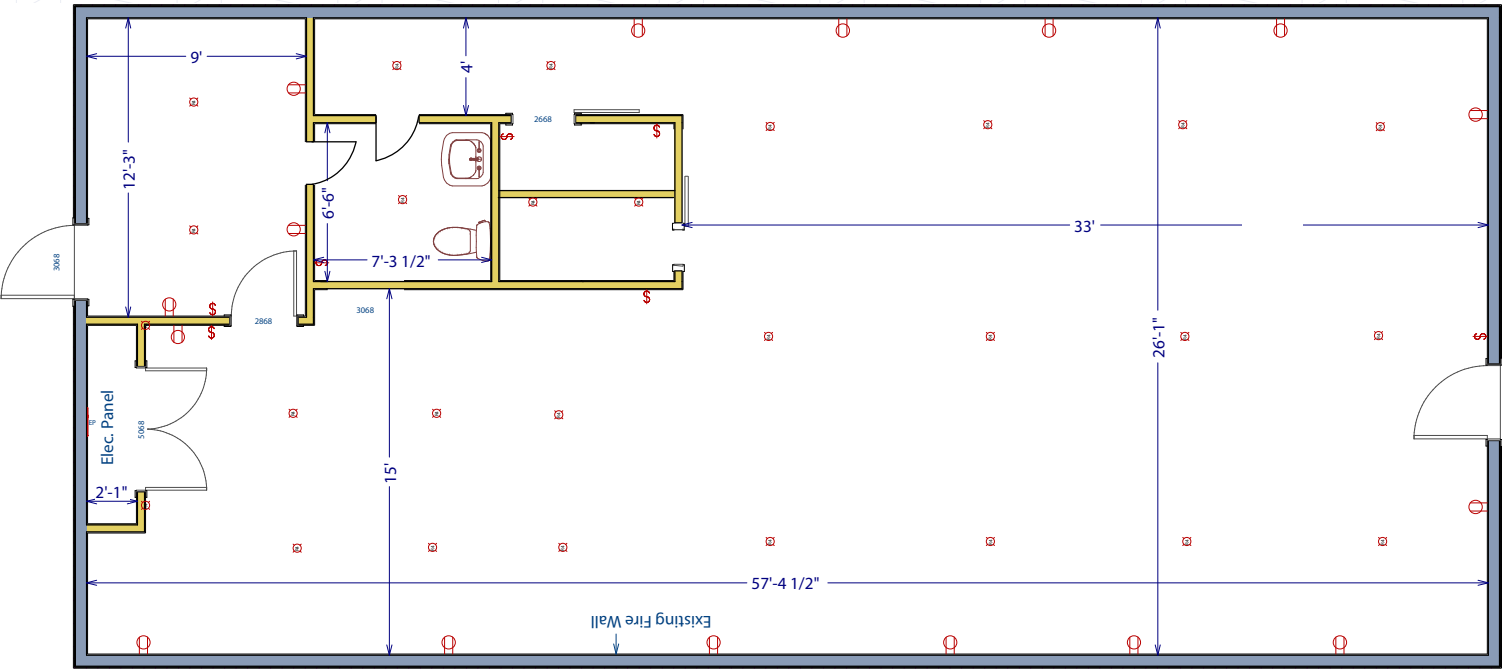



Central Alberta's Ambassador for Commercial Real Estate



#103, 4315 - 55 Avenue Red Deer, AB T4N 4N7
www.salomonscommercial.com

Kelly Babcock
 Listing Agent
 403.314.6188
kelly@salomonscommercial.com

Davin Kemshead
 Associate
 403.314.6190
davin@salomonscommercial.com

Brett Salomons
 Partner
 403.314.6187
brett@salomonscommercial.com

Max Field
 Associate
 403.314.6186
max@salomonscommercial.com

Mike Williamson
 Associate
 403.314.6189
mike@salomonscommercial.com

Jordan Krulicki
 Associate
 403.314.6185
jordan@salomonscommercial.com

This information herein was obtained from sources reliable and is believed to be true: it has not been verified and as such cannot be warranted nor form any part of any future contract. The offering may be withdrawn without notice.