

# SINGLE TENANT INDUSTRIAL BUILDING AVAILABLE FOR LEASE



550 VICTOR ST.  
BARSTOW, CA 92311

## ADDRESS

550 Victor St., Barstow, CA 92311

## PROPERTY OVERVIEW

±6,000 sf industrial building on a ±0.64-acre parcel. The property is fully fenced and paved, providing an additional level of accessibility and security. The building is comprised of ±5,000 sf of warehouse space and ±1,000 sf of office space with one roll-up door and two bathrooms. Additionally, with three-phase power available to the building, it caters to various business operations.

## LOCATION

Positioned just east of the I-15 and I-40 interchange, and directly south of E. Main St., this building's convenient location provides easy access to major transportation routes. The property's adjacency to the Walmart Supercenter further enhances its visibility and accessibility making it ideal for businesses seeking a well-connected and functional space in Barstow.

## MUNICIPALITY

City of Barstow | County of San Bernardino

## PRICE

\$0.90 per sf MG



# SITE SUMMARY





# WAREHOUSE SPACE





# OFFICE SPACE





# AERIAL VIEW

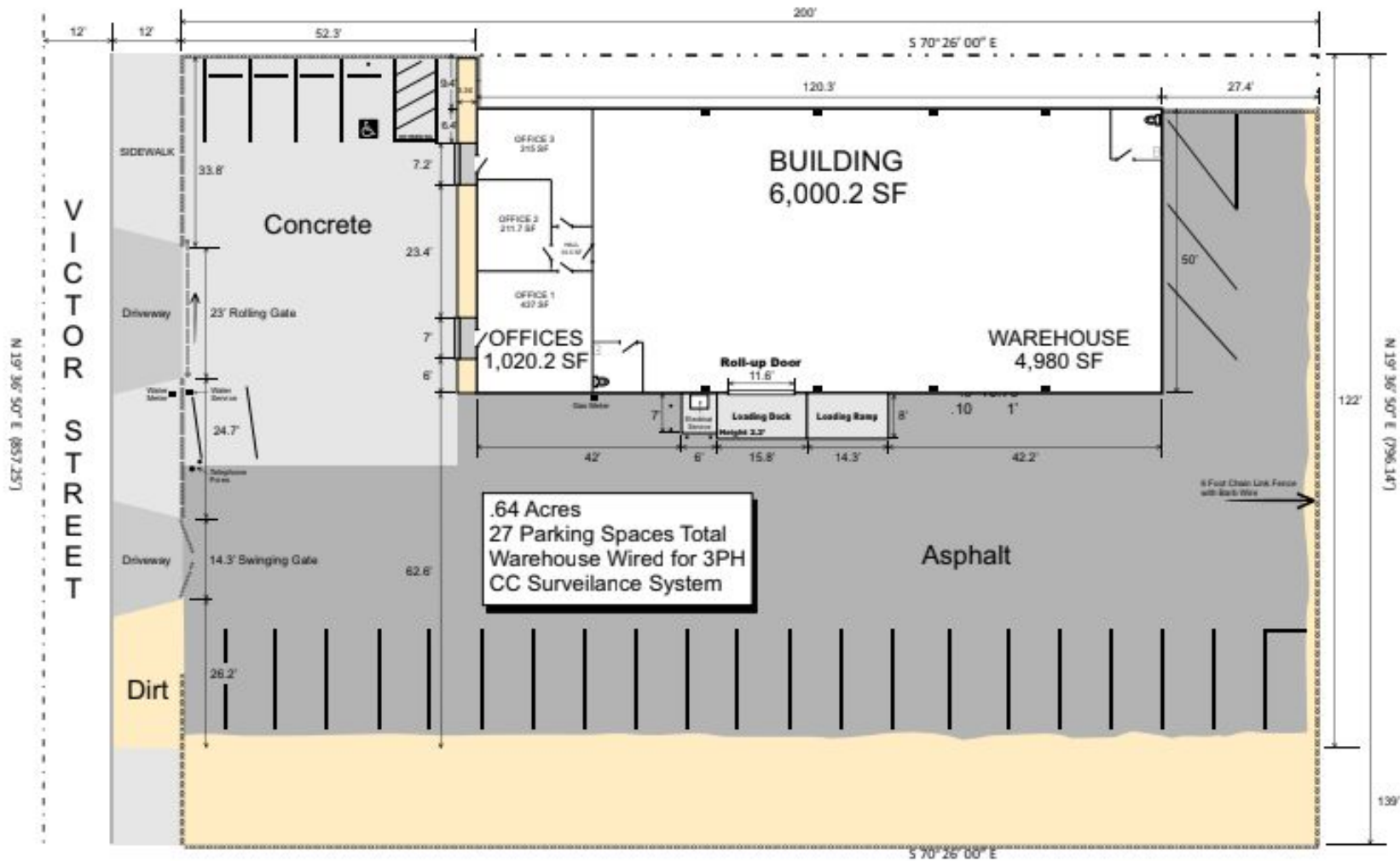

# SITE PLAN



# CONTACT

**Jeremy Schmidt**

jschmidt@kurschgroup.com

760.983.2593

DRE # 01310579

**Aiden Schmidt**

aschmidt@kurschgroup.com

760.983.2592

DRE # 02201573



12180 Ridgecrest Rd., Suite 232  
Victorville, CA 92395

760.983.2383 | [www.kurschgroup.com](http://www.kurschgroup.com)

Corporate DRE # 01896143

The information contained herein has been secured from sources we believe to be reliable. Kursch Group, Inc. and/or agents involved, make no representations or warranties, expressed or implied, as to the accuracy of the information. All information should be verified with another outside agency, government entity or property owner as applicable.