

# 3601 Bearss ave

3601 Bearss ave, Tampa, FL 33618





# 3601 Bearss ave

3601 Bearss ave, Tampa, FL 33618

## Property Details

Available for ground lease 6.5-acre MOL land situated in the prime Carrollwood/Northdale commercial market. Zoned for planned development, featuring approximately 340 feet of frontage on Bearss Ave. Located behind Walmart at the intersection of N. Dale Mabry Hwy and W. Bearss Ave, it is positioned within a major shopping and dining district. The property can be rezoned for various commercial purposes, including medical, retail, office, multi-family, storage, or flex-use. Most of the land is paved with asphalt and includes a 2,000 sqft metal building. The primary access is from W. Bearss Ave, with potential additional access points on Zambito Road. There are 0.8 acres of lowlands on the northeast corner of the property and can be used for retention.

**Price: \$125,000 /SF/YR**

- Carrollwood Commercial Land Ground Lease

View the full listing here: <https://www.loopnet.com/Listing/3601-Bearss-ave-Tampa-FL/32632060/>

Rental Rate:	\$125,000 /SF/YR
Property Type:	Land
Property Subtype:	Commercial
Min. Divisible:	5.70 AC
Proposed Use:	Commercial
Rental Rate Mo:	\$10,417 /SF/MO

# 3601 Bearss ave

3601 Bearss ave, Tampa, FL 33618

## Listing space

### Space 1

Space Available: 248,292 - 248,400 SF  
Rental Rate: \$125,000 /SF/YR  
Date Available: Now

Available for ground lease 6.5-acre MOL land situated in the prime Carrollwood/Northdale commercial market. Zoned for planned development, featuring approximately 340 feet of frontage on Bearss Ave. Located behind Walmart at the intersection of N. Dale Mabry Hwy and W. Bearss Ave, it is positioned within a major shopping and dining district. The property can be rezoned for various commercial purposes, including medical, retail, office, multi-family, storage, or flex-use. Most of the land is paved with asphalt and includes a 2,000 sqft metal building. The primary access is from W. Bearss Ave, with potential additional access points on Zambito Road. There are 0.8 acres of lowlands on the northeast corner of the property and can be used for retention.

# 3601 Bearss ave

3601 Bearss ave, Tampa, FL 33618

## Location



# 3601 Bearss ave

3601 Bearss ave, Tampa, FL 33618

## Property Photos



Zambito Area Map

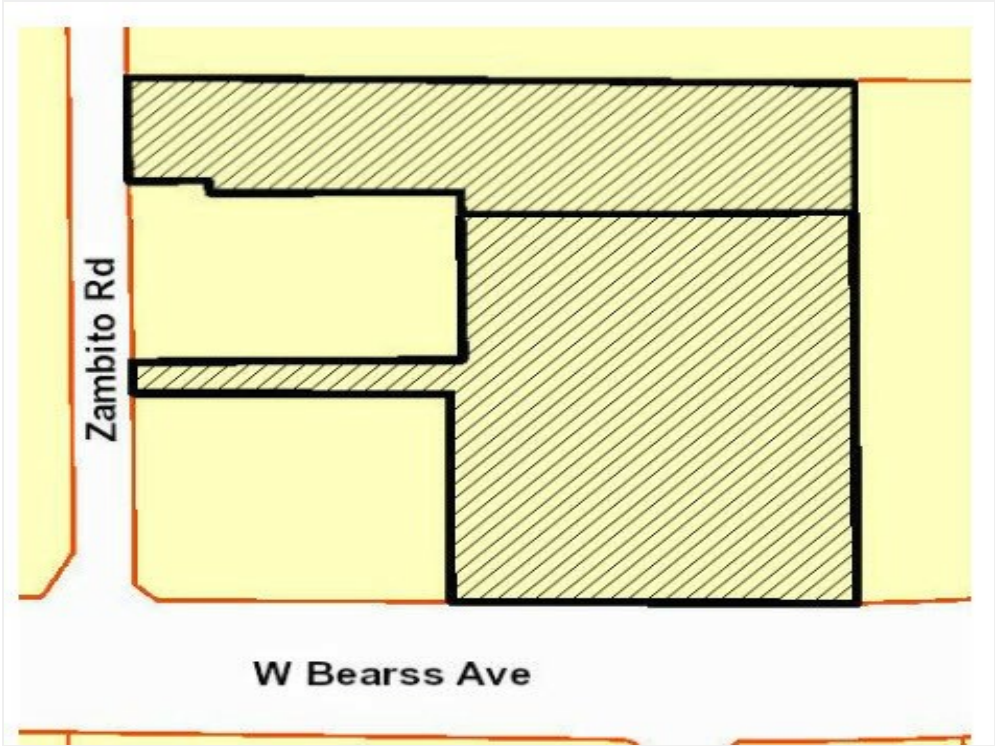

Zambito Shaded



# 3601 Bearss ave

3601 Bearss ave, Tampa, FL 33618

## Property Photos



2020-10-08\_0-39-04

# 3601 Bearss ave

3601 Bearss ave, Tampa, FL 33618

**Sumanth Katta**

[kattarealty@gmail.com](mailto:kattarealty@gmail.com)

(813) 436-9941

**Star Bay Realty Corp**

2409 Fox Forest Dr

Lutz, FL 33549

