

**Available  
For Lease**

**350  
N  
OGDEN  
ST**

**350**

FULTON  
MARKET  
WEST



# PROPERTY HIGHLIGHTS

---

[01]

## Relaxed PMD-4B Zoning

Permitted Uses: Office, Retail, Flex & Distribution

[02]

## Value

Fulton Market Convenience  
Without Fulton Market Pricing

[03]

## Public Transportation

Walking Distance To...  
Green, Pink & Blue Lines

[04]

## Best of Both Worlds

Fulton Market Amenities to East  
Fulton Market West Offers Breweries,  
Restaurants

[05]

## Flex Building

Flexible Lease Terms & Space Sizing

[06]

## Ample Amounts of Natural Light

Window Lines to East overlooking  
Fulton Market, West Loop and City  
Landscape Backdrop

[07]

## Concrete Loft - Office/Flex

Soaring Floor to Ceiling Heights  
Exposed Concrete & Brick

[08]

## Loading

One (1) Freight Elevator  
Six (6) Exterior Loading Docks

[09]

## Secure Building

With Keycard Entry





350

FULTON  
MARKET  
WEST

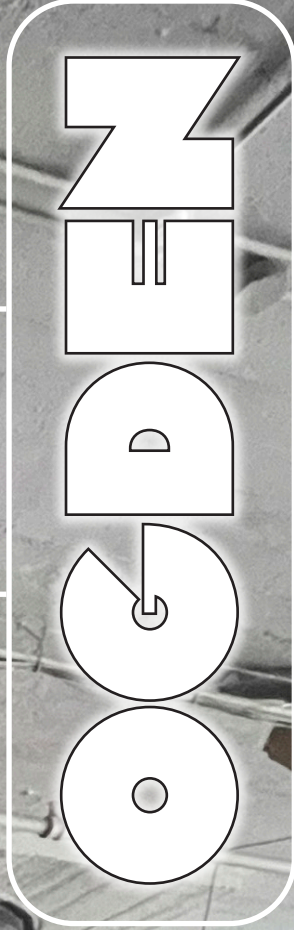

## BUILDING OVERVIEW

Address:	350 N. Ogden   Fulton Market West
Total Building Size:	63,504 RSF
Stories:	4 Stories with Lower Level
Elevator:	1 Freight
Parking:	15 Spaces
Power:	3 Phase   800-1,600 AMPS   120-208 Volts
Loading:	6 Exterior Docks

# AVAILABLE SUITES

**SUITE 1 NORTH: 2,400 SF**

**SUITE 1 SOUTH: 4,850 SF**

## SUITE SPECIFICATIONS

- **Can be Combined for 7,250 SF**
  - Spaces are contiguous
- **Direct Access to Loading & Freight**
  - Lobby Entrance ID
- **Column Spacing**
  - 18' 6" E/W x 17' N/S
- **Ceiling Height**
  - 13'2"

## FLOOR PLAN

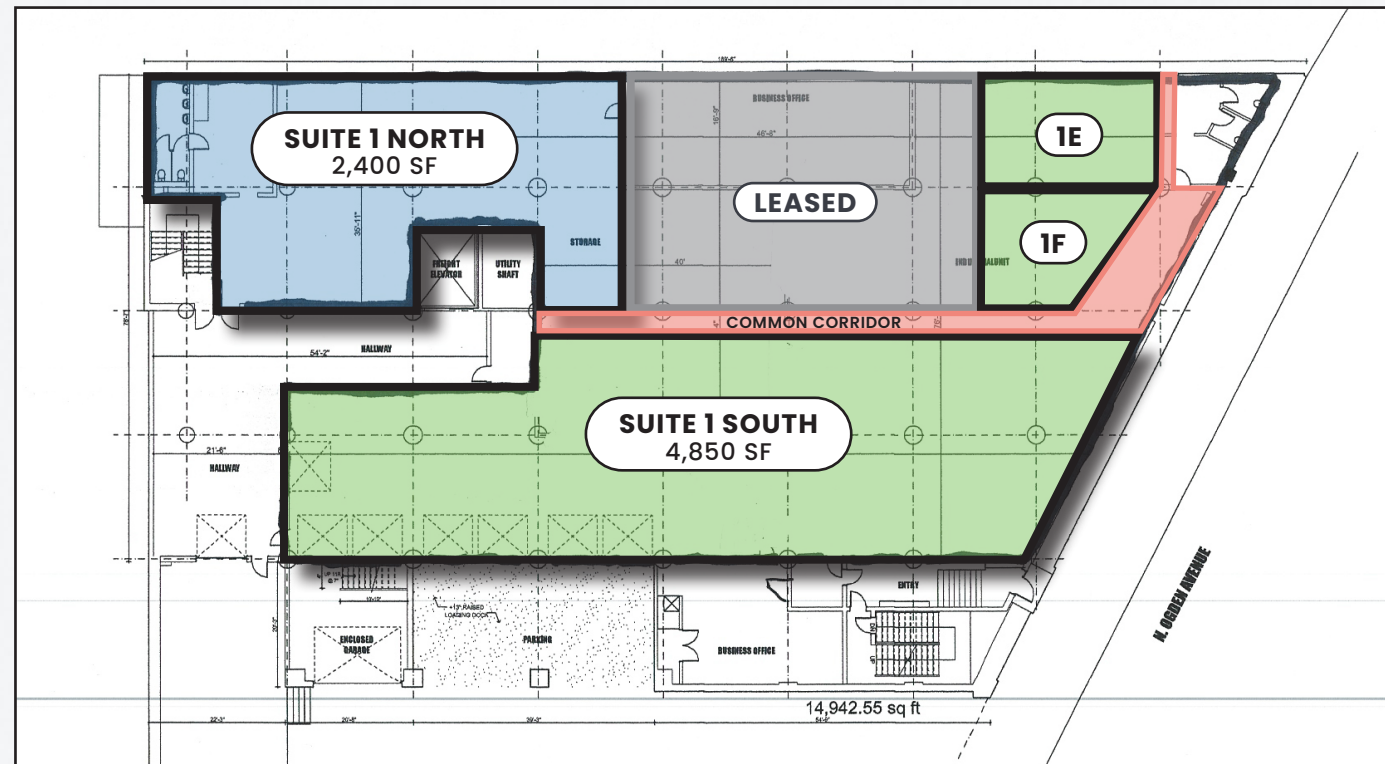

# SUITE 1 NORTH



# SUITE 1 SOUTH



# FULTON MARKET WEST

# THE CENTER OF CONNECTIVITY









350

FULTON  
MARKET  
WEST

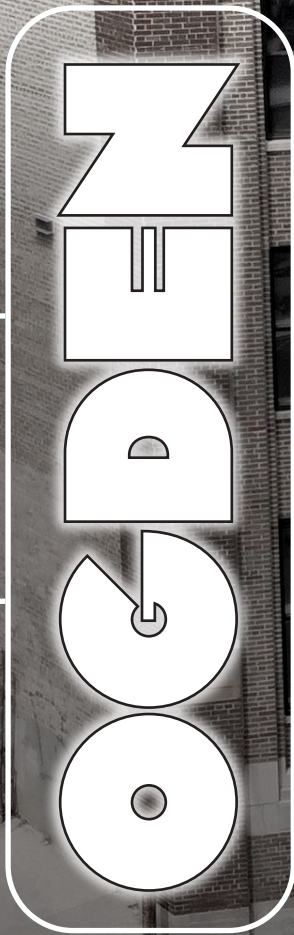

# CONTACT

**BRAYDEN SCHIFF**  
Senior Associate  
(630) 488-8697  
bschiff@cawleycre.com

**KALIE KORPITZ**  
Associate  
(312) 766-4285  
kkorpitz@cawleycre.com

