

# MISSION PACIFIC CENTER

1450 W Mission Rd., San Marcos, CA 92069

**CORNER RETAIL  
SPACE AVAILABLE**

**RETAIL SPACE ±1,350 - ±1,500 SF  
AVAILABLE**

# MISSION PACIFIC CENTER

1450 W Mission Rd.  
San Marcos, CA 92069

- Neighborhood strip retail center
- Mix of residential and daytime employment population
- Near Palomar College (21,141 students)
- Located at the signalized corner of W. Mission Rd. (±14,00 ADT) & N. Pacific St.
- Corner location available
- 60 parking spaces
- Please do not disturb tenants

±1,350 SF - ±1,500 SF AVAILABLE

## TENANTS

**SORRENTO'S**  
PIZZA

**AAA**  
**ELITE SPA**

**SWAN**  
**NAILS & SPA**

**SUE THAI OM**

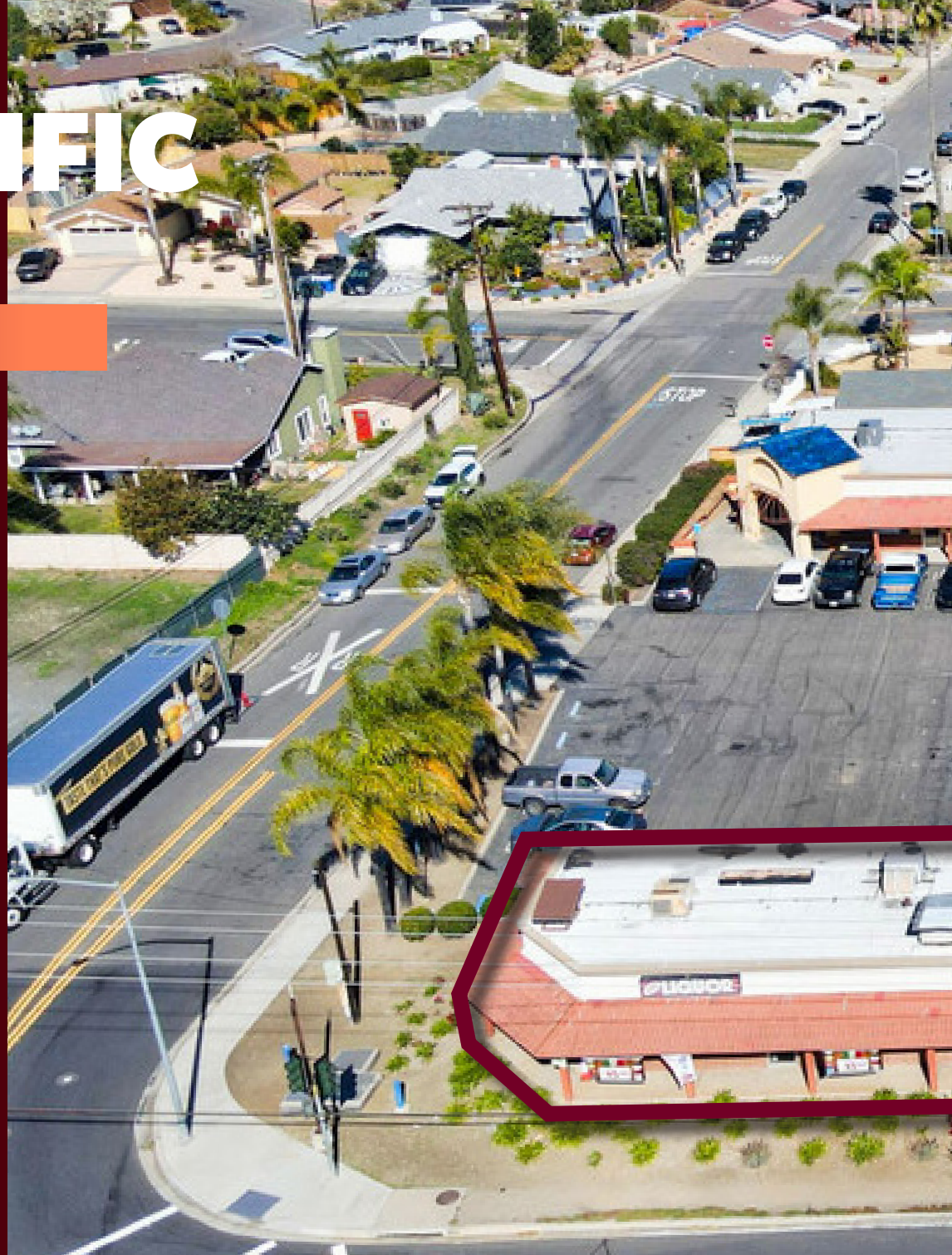



AVAILABLE  
1,350 SF



AVAILABLE  
1,500 SF



# COMPETITION AERIAL

**SITE**

**PALOMAR COLLEGE**

21,141 Students

W. Mission Rd. ADT: 314,000

Palomar College  
Sprinter Station  
0.5 miles from site

ADT: 329,013

ADT: 3144,695



# AT THE Valley of Discovery, San Marcos

WALK  
SCORE  
**71**

## Very Walkable

Most errands can be accomplished on foot.

TRANSIT  
SCORE  
**66**

## Good Transit

Many nearby public transportation options.

BIKE  
SCORE  
**51**

## Bikeable

Some bike infrastructure.



*\*walkscore.com*





### POPULATION

1 mile	15,708
3 miles	93,137
5 miles	206,114



### DAYTIME POPULATION

1 mile	15,003
3 miles	80,929
5 miles	160,783



### AVERAGE HOUSEHOLD INCOME

1 mile	\$112,242
3 miles	\$129,522
5 miles	\$150,201

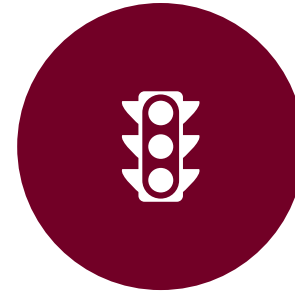

### TRAFFIC COUNTS

W Mission Rd.	14,219 ADT
N Las Posas Rd.	22,024 ADT

### FLOURISHING FAMILIES

Flourishing couples and multi-generational families living a wide range of lifestyles in suburbia.

**13.9% of population**

### FAMILY UNION

Conventional Gen X families living suburban and city lifestyles.

**12.9% of population**

### BOOMING WITH CONFIDENCE

Mature and upscale couples living in suburban homes.

**11.9% of population**

# AREA DEMOGRAPHICS



# SITE PLAN

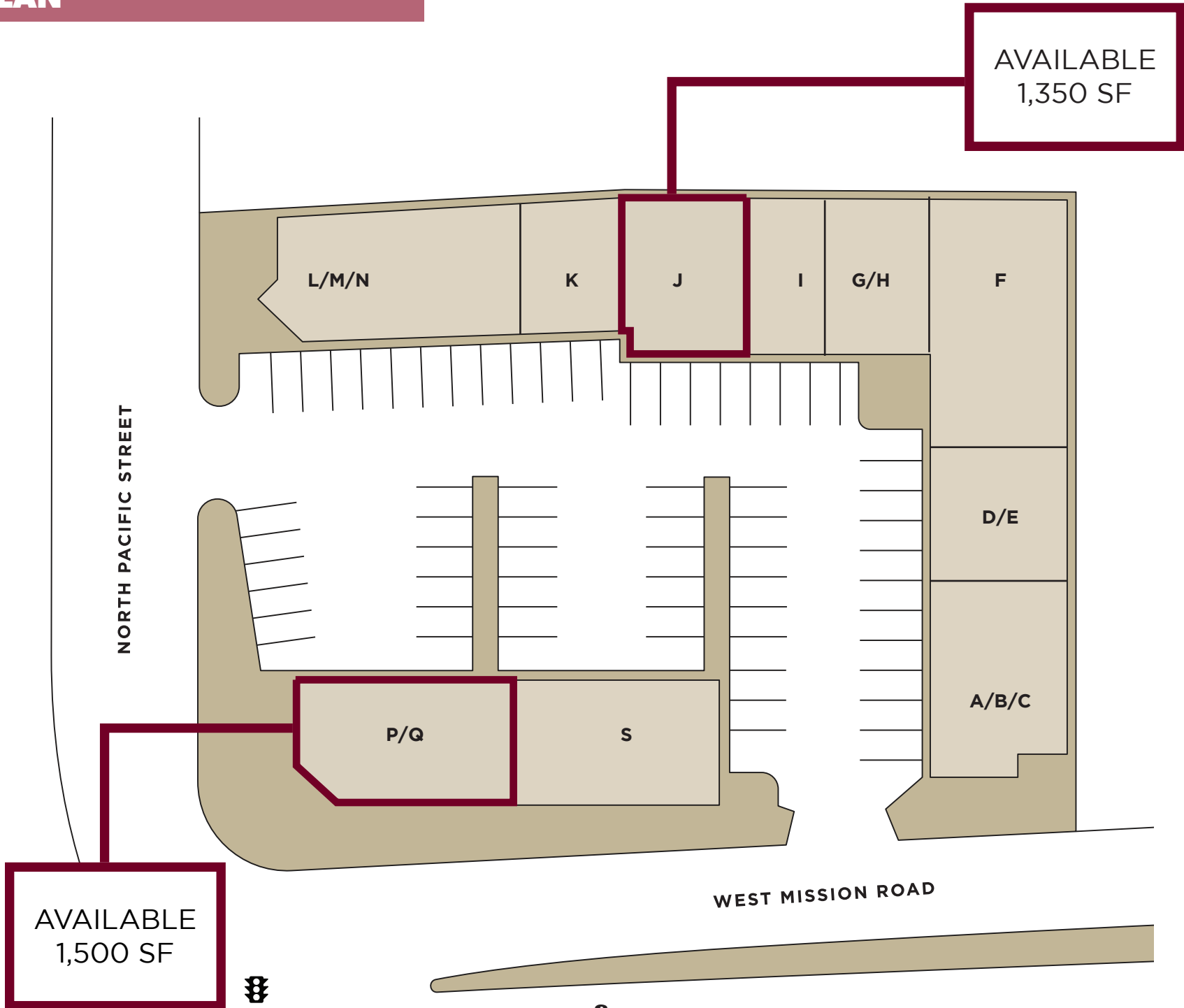



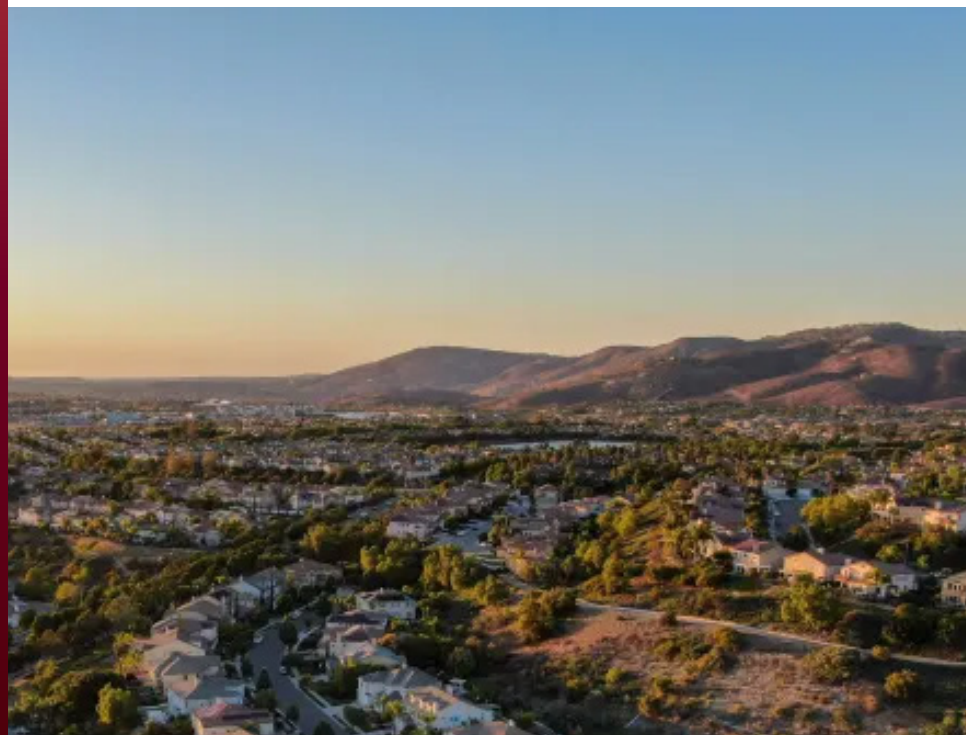

## \*DISCLAIMER

\*All information regarding this property is deemed to be reliable, however, no representation, guarantee or warranty is made to the accuracy thereof and is submitted subject to errors, omissions, change of price or withdrawal without notice.

\*Figures and statements appearing on this form represent our best knowledge and belief based on information gathered regarding the above property. This analysis is to be taken, therefore, as an estimate and not as a guarantee or warranty. Information contained herein is subject to independent verification and no liability for errors or omissions is assumed. You should rely on your own independent analysis and investigation regarding the above property and on the advice of your legal counsel and tax consultant.

\*Any site plans and maps contained herein is not a representation, warranty or guarantee as to size, location, or identity of any tenant, and the improvements are subject to such changes, additions, and deletions as the architect, landlord, or any governmental agency may direct.

\*Demographics contained herein are produced using private and government sources deemed to be reliable. The information herein is provided without representation or warranty. Additional information available upon request.

\*Any geofencing data herein is provided by Placer Labs, Inc. ([www.placer.ai](http://www.placer.ai)) and is provided without representation or warranty.

\*Photos contained herein are property of their respective owners. Use of these photos without the express written consent of the owner is prohibited. Photos do not guarantee the current condition of the property.



# MISSION PACIFIC CENTER

1450 W Mission Rd., San Marcos, CA 92069

FOR LEASING INFORMATION

**LUKE NGUYEN**

858.633.1810

[lnguyen@flockeavoyer.com](mailto:lnguyen@flockeavoyer.com)

CA DRE No.: 02050070

**FLOCKE &  
AVOYER**  
Commercial Real Estate