

# ±24,062 SF Available

Suite 200 For Lease

3505 Thayer Court  
Aurora, IL 60504  
[www.cbre.com/properties](http://www.cbre.com/properties)



## HIGHLIGHTS

- + Well maintained building with flexibility for distribution or manufacturing
- + Newer Roof (2019)
- + Located in Prestigious Meadow Lake Corporate Center
- + Low DuPage County Real Estate Taxes
- + Convenient Access to I-88 by Route 59 or Eola Road Interchange

## SPECIFICATIONS

RBA	64,220 SF
Available For Lease	24,062 SF
Office	±2,960 SF
Docks	2
DID	1
Clear Height	21'
Power	400a/120-208v
Parking	30
Construction	Precast
Year Built	1989
Taxes	\$1.67
CAM	\$1.71
Lease Rate	STO
Sale Price	STO

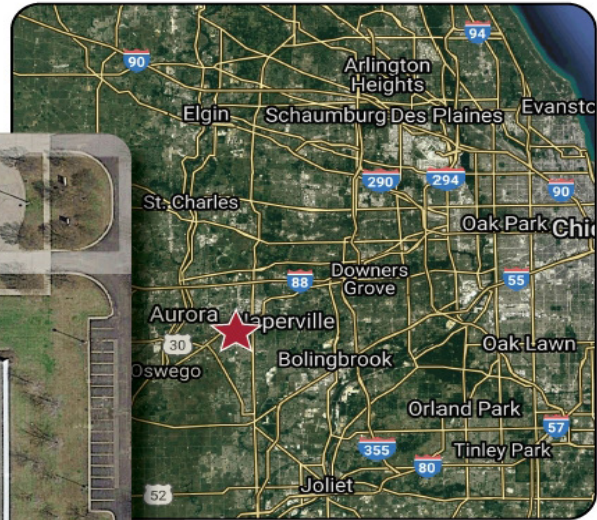
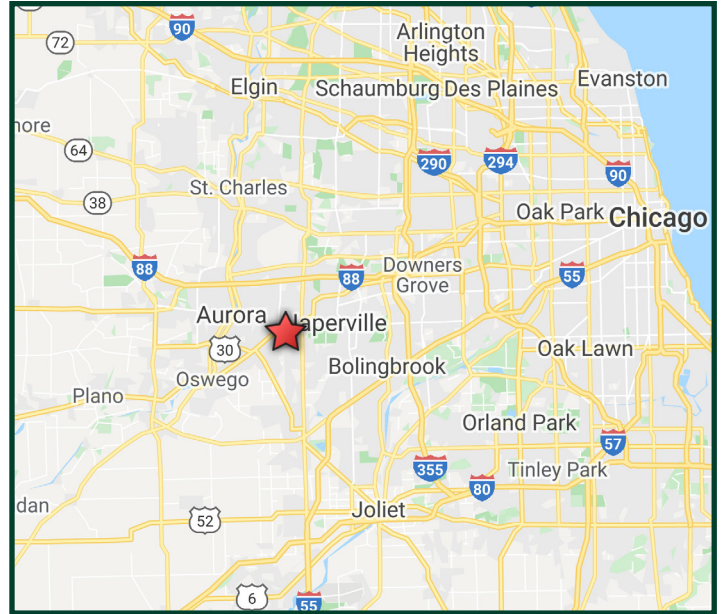

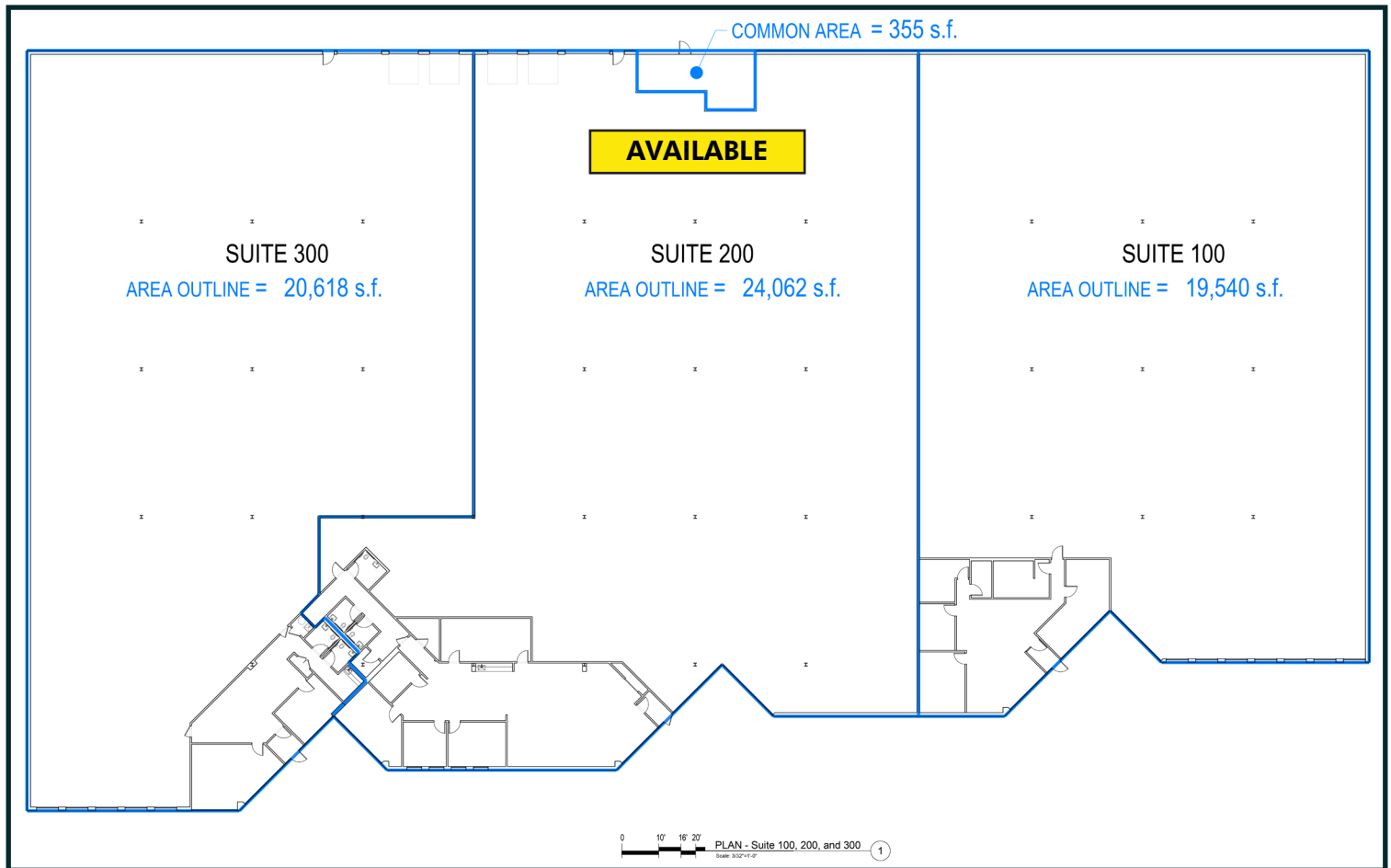

## Contact Us

### John Hamilton

First Vice President  
+1 847 706 4909  
john.hamilton@cbre.com

### Ted Gates

Senior Vice President  
+1 773 318 0018  
ted.gates@cbre.com

© 2024 CBRE, Inc. All rights reserved. This information has been obtained from sources believed reliable, but has not been verified for accuracy or completeness. You should conduct a careful, independent investigation of the property and verify all information. Any reliance on this information is solely at your own risk. CBRE and the CBRE logo are service marks of CBRE, Inc. All other marks displayed on this document are the property of their respective owners, and the use of such logos does not imply any affiliation with or endorsement of CBRE. Photos herein are the property of their respective owners. Use of these images without the express written consent of the owner is prohibited.