

GATEWAY TO MIAMI BEACH



1130 5TH STREET

MIAMI BEACH, FL 33139

RETAIL | RESTAURANT



PREMISES

1130 5TH STREET

GROUND FLOOR	+/- 8,504 SF
MEZZANINE	+/- 3,432 SF
DELIVERY	IMMEDIATE
RENT	UPON REQUEST

PROPERTY INFO

- LOCATED AT THE GATEWAY TO MIAMI BEACH
- TREMENDOUS VISIBILITY & SIGNAGE
- ICONIC BRANDING OPPORTUNITY
- 42,000 VEHICLES PER DAY
- PARKING ON SITE
- ACROSS FROM THE SHOPS AT FIFTH AND ALTON WITH OVER 1,100 PARKING SPACES
- WALKING DISTANCE TO SOUTH OF FIFTH LUXURY CONDOS

NEARBY TENANTS

Publix

TJ-maxx



ROSS
DRESS FOR LESS

theVitamin
Shoppe

wework



Orangetheory
FITNESS

Total Wine
& MORE



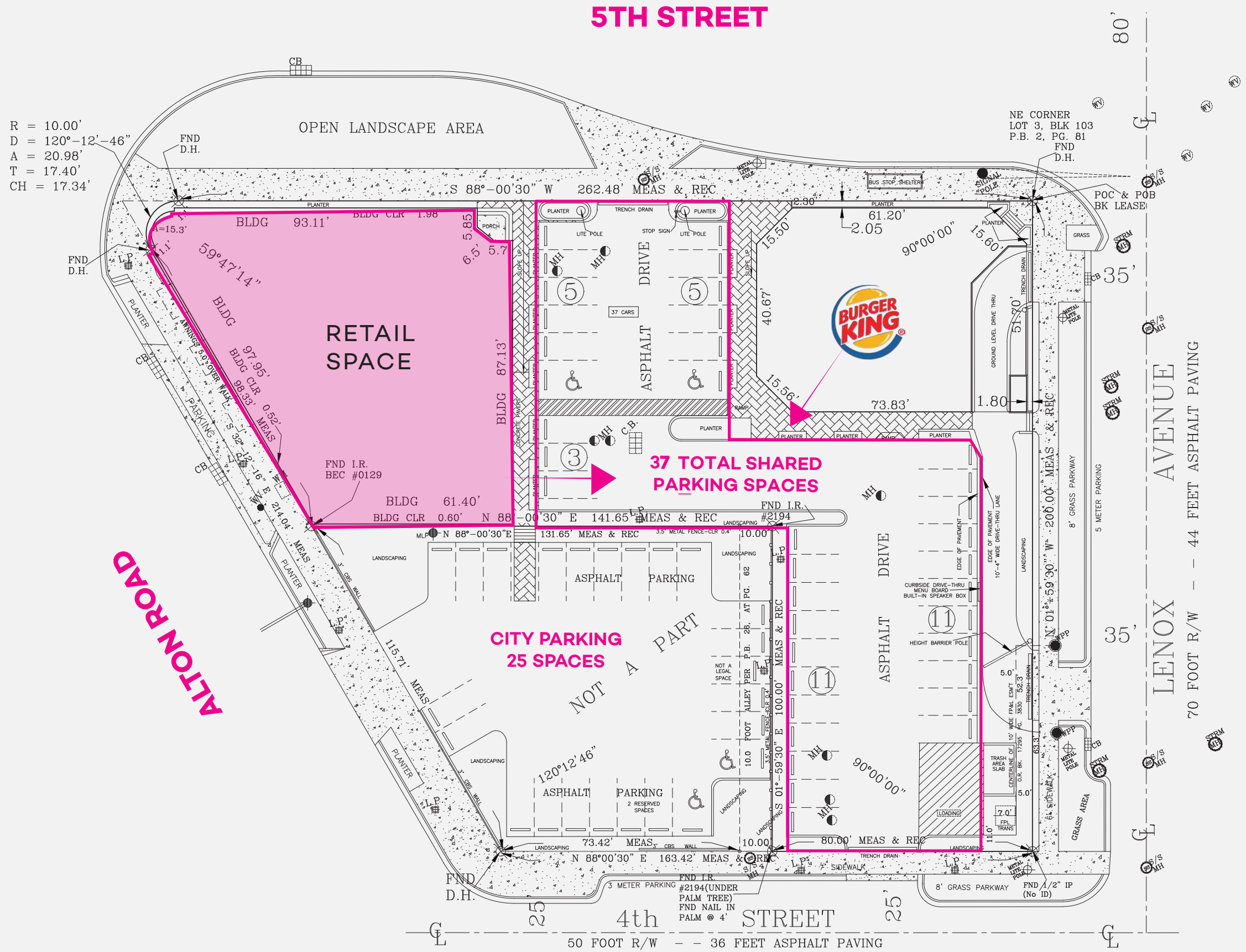

R = 10.00'
D = 120°-12'-46"
A = 20.98'
T = 17.40'
CH = 17.34'

NE CORNER
LOT 3, BLK 103
P.B. 2, PG. 81
FND
D.H.

ALTON ROAD

5TH STREET

4th STREET

LENOX AVENUE

GROUND FLOOR

5th STREET

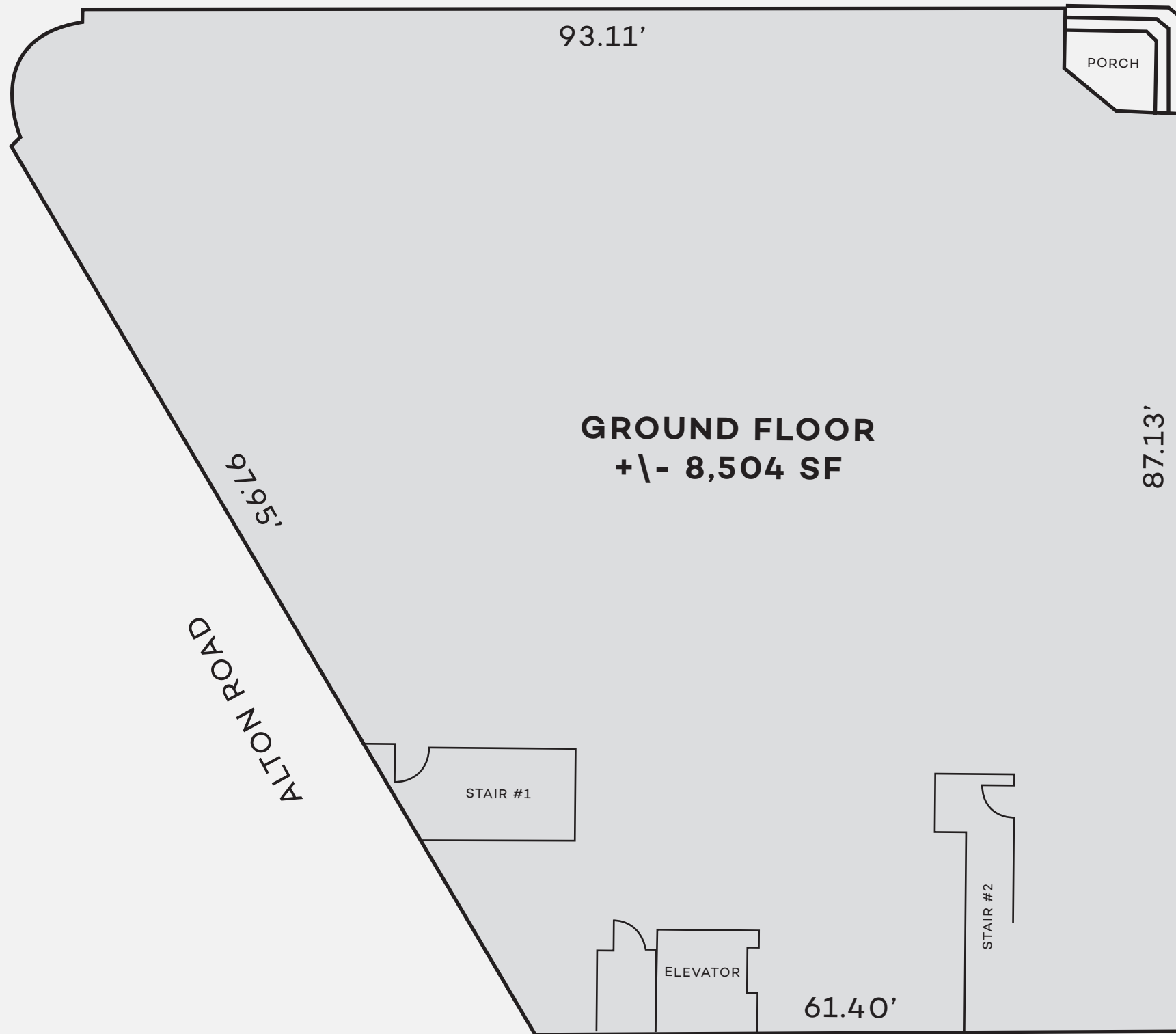

MEZZANINE

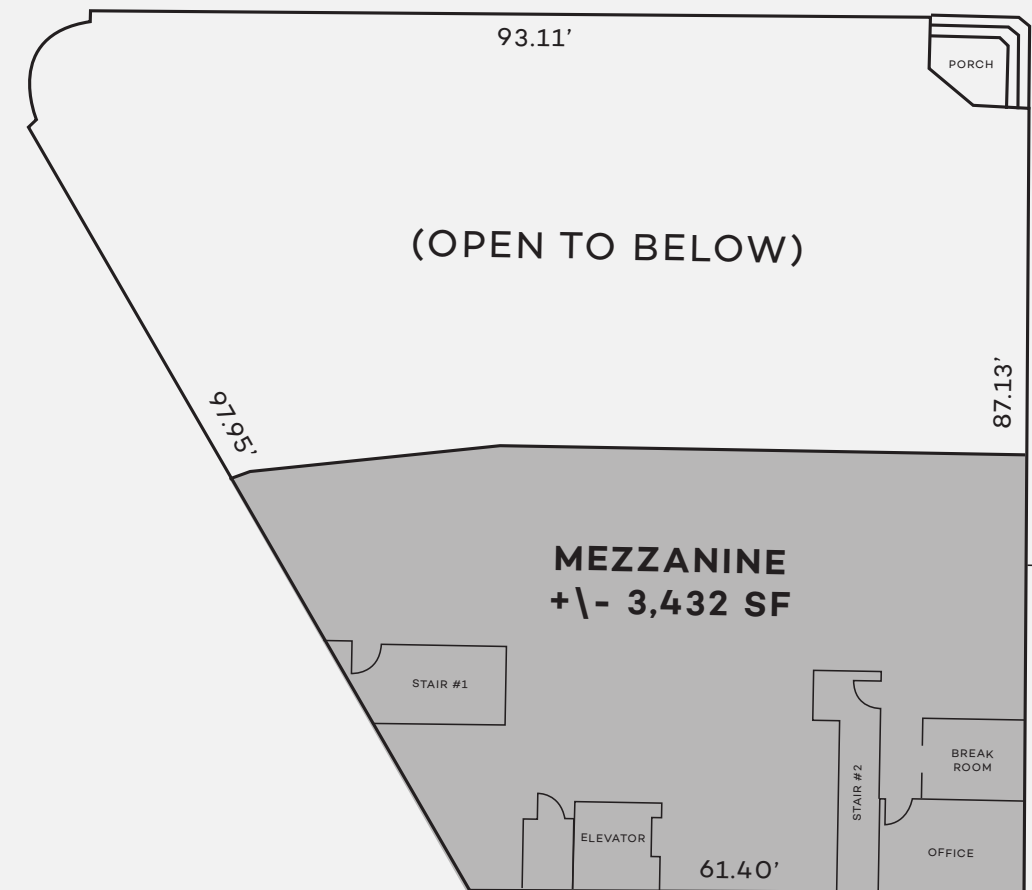

(OPEN TO BELOW)

2nd Floor
MEZZANINE

FLOOR PLAN

1130 5TH STREET

TOTAL SQUARE FEET

+/- 11,936

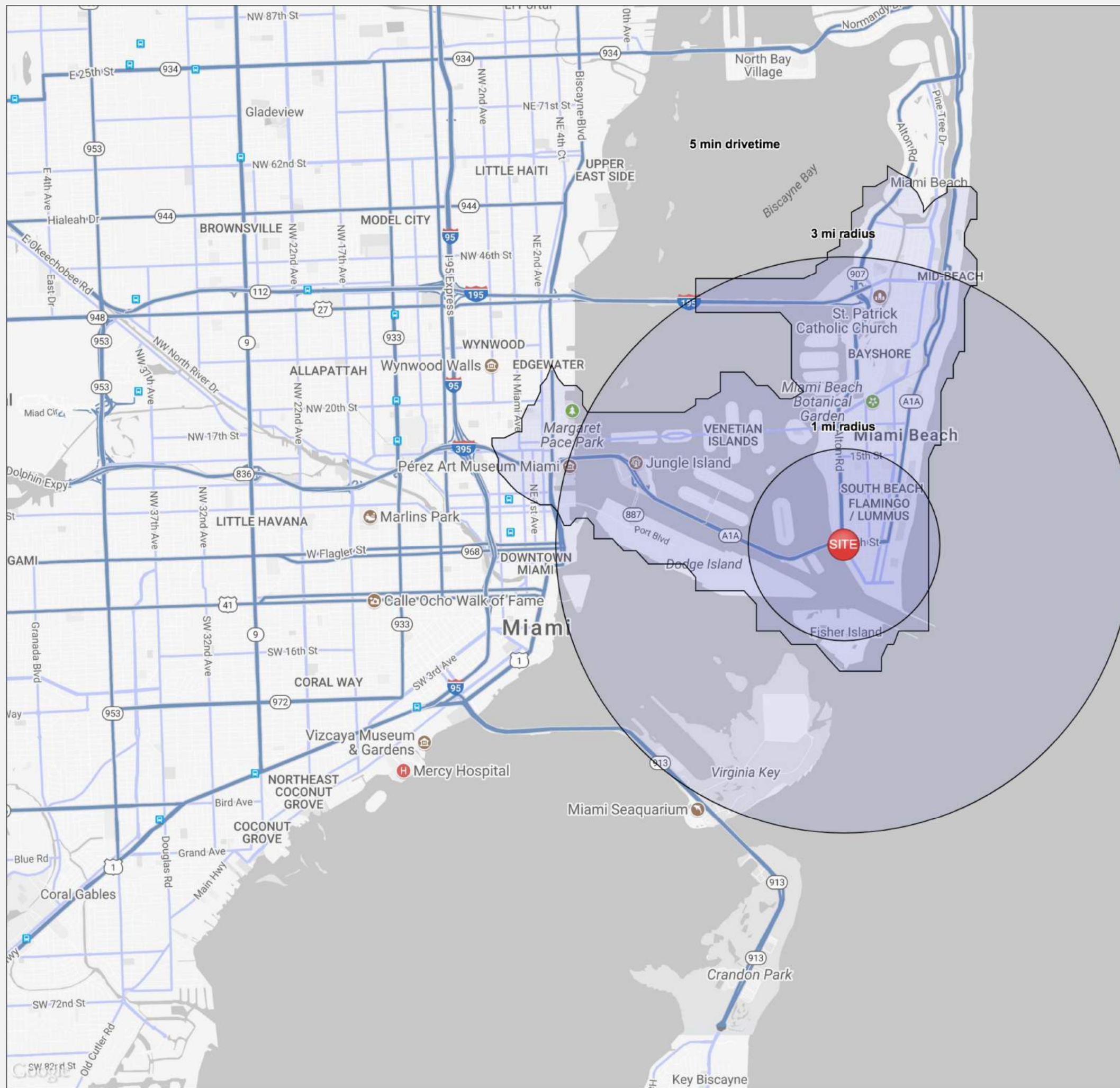

5 Mile Information

225,243	\$61,475	20,627
Employees	Median Income	Businesses

©2017, SITES USA Inc. All Rights Reserved. | (480) 491 - 1112 | 4005 W Chandler Blvd, Chandler AZ 85226
Logos are for identification purposes only and may be trademarks of their respective companies. This map was produced using data from private and government sources deemed to be reliable. The information herein is provided without representation or warranty.

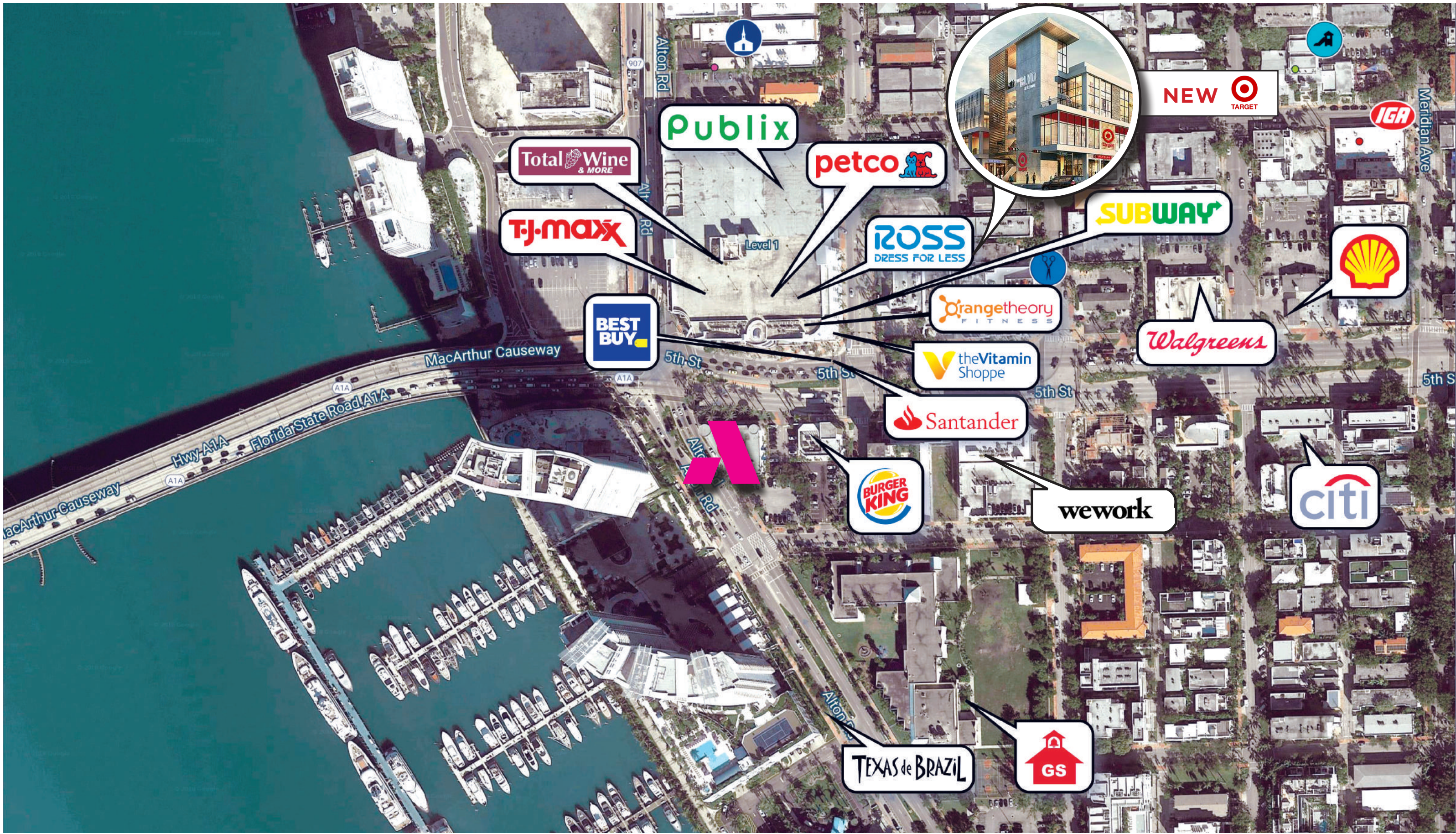

AERIAL VIEW

NEARBY RETAIL



SOUTH OF FIFTH NEIGHBORHOOD

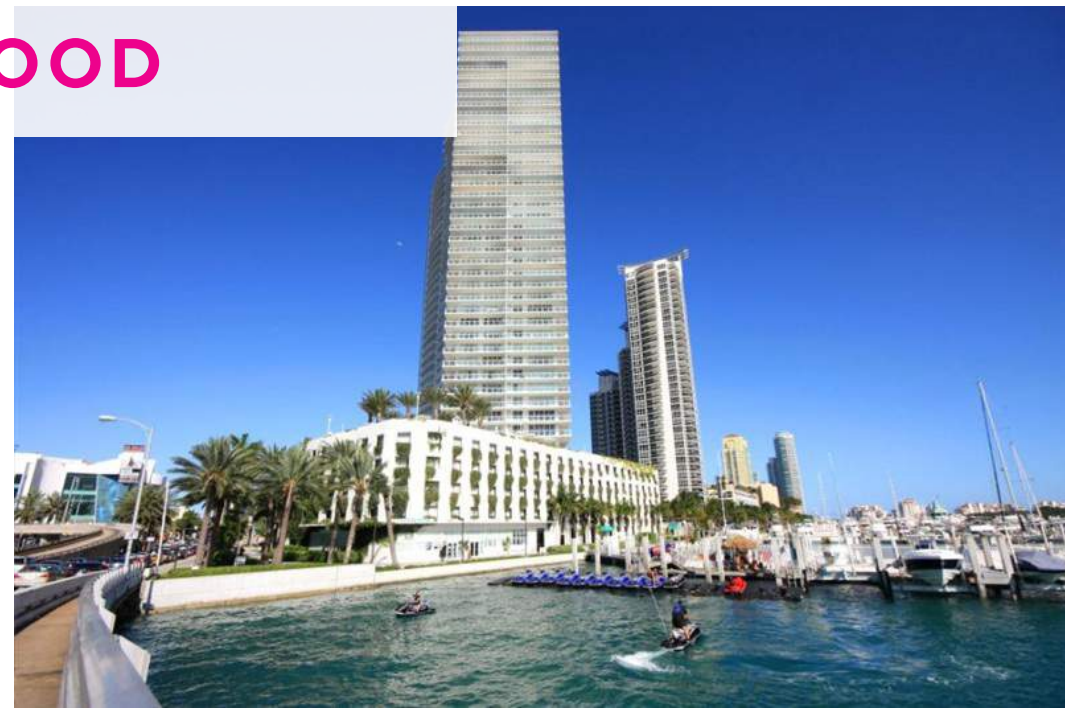



EXCLUSIVE LISTING AGENTS

Aaron J. Butler
305 397 8012
ajbutler@avenuerep.com

AVENUEREP.COM