

FULLY EQUIPPED RESTAURANT SPACE FOR LEASE



EST. 1877

**WILLIAM TELL**  
— HOUSE —

26955 State Route 1  
TOMALES, CA

**maven**  
RETAIL

## ABOUT

The William Tell House boasts a rich and storied history in Marin County. Most recently, it operated as a full-service restaurant and bar (with outdoor event space).

The restaurant was most recently operated as a counter-service establishment but can easily be reconfigured into a full-service dining experience. The updated dining room is fully outfitted with furniture, fixtures, and equipment, including a Type 1 hood. There is an existing Type 47 liquor license on the premises, enabling the operation of a full bar. Conveniently located just off Highway 1, the restaurant is perfectly positioned to attract tourists traveling to popular destinations such as Dillon Beach and Bodega Bay. It is also a well recognized spot for locals to visit.

The outdoor patio, conveniently situated next to the restaurant and bar, offers versatile functionality. It serves as an inviting space for additional seating, a warm and sunny spot for brunch, or a refreshing venue for events and larger gatherings.





## FEATURES

- +/- 2,803 SF includes: Dining room, kitchen, prep, storage + wine storage
- +/- 3,500 SF outdoor patio
- Old-world charm throughout
- Long mahogany bar
- Spacious dining room and outdoor patio
- Interior finishes include, ceramic tile and wood flooring
- Type 47 & 58 liquor license are available on site
- Type 58 license allows for catering alcoholic beverages off-site
- Ample parking which includes dirt and paved areas

EST. 1877

**WILLIAM TELL**  
— HOUSE —





# FLOOR PLAN

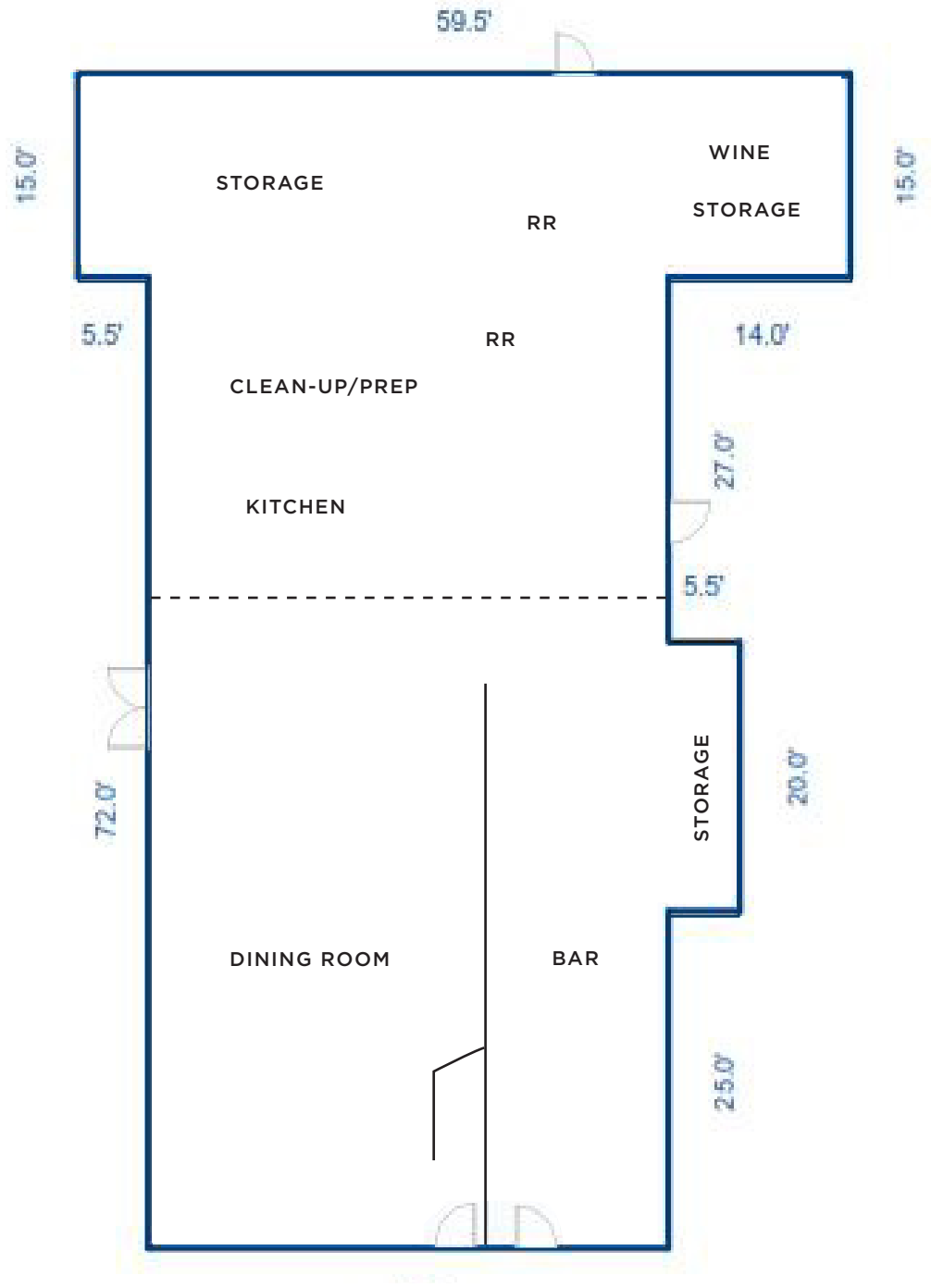

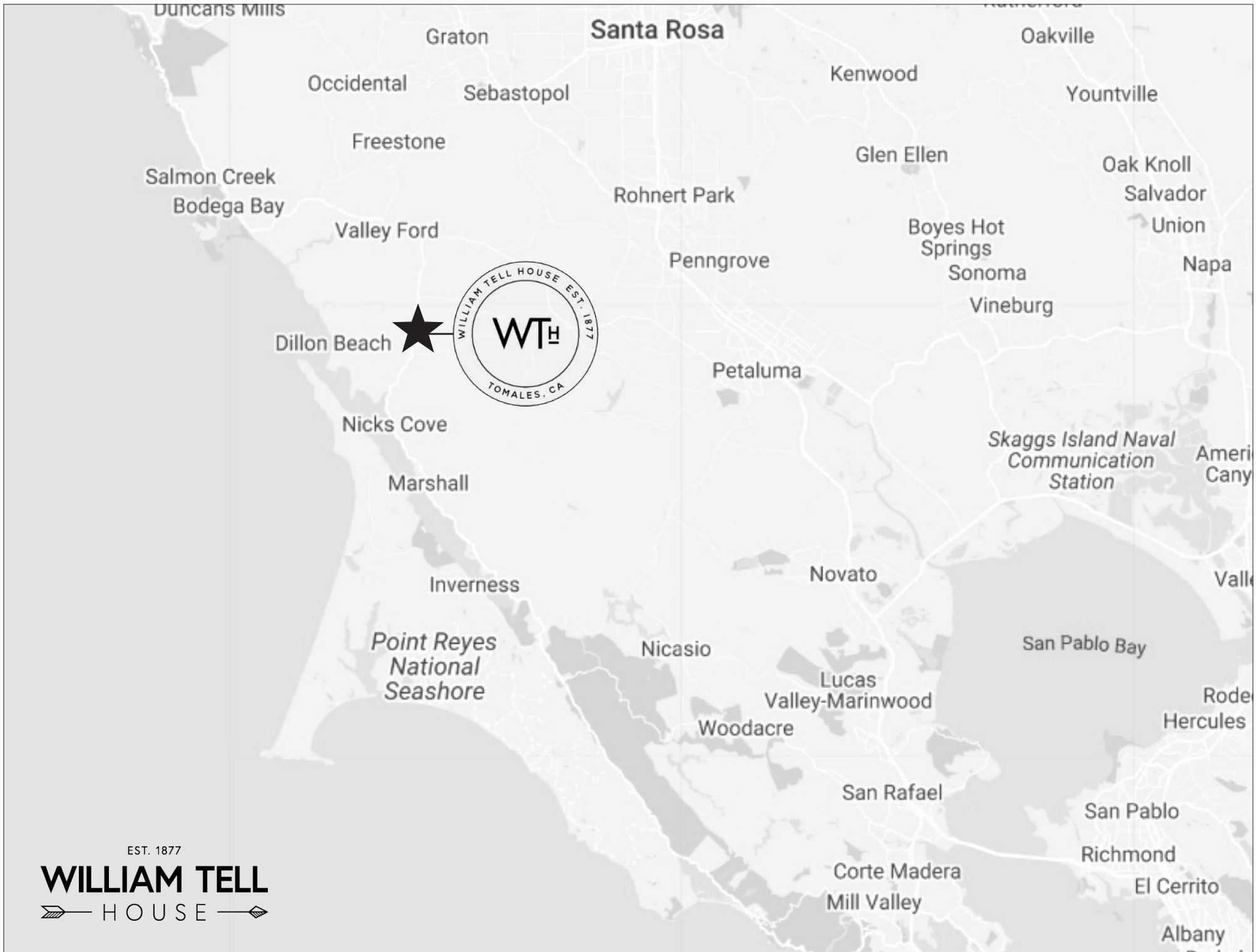

EST. 1877

**WILLIAM TELL**  
HOUSE



## CONTACT

### CATHERINE MEUNIER

DRE #01843732

415.806.5566

catherine@mavenproperties.com

### HALLIE FORMAN

DRE #02252563

415.426.7808

hallie@mavenproperties.com

**maven**  
RETAIL

NOTICE: This information has been secured from sources we believe to be reliable but we make no representations, warranties, express or implied, as to the accuracy of the information. Listing broker has been given enough information to provide only a preliminary interest in the property. The materials are not to be considered fact. The information contained herein is not a substitute for thorough due diligence investigation. References to square footage, zoning, use, or age are approximate. Please contact the San Francisco Planning Department to verify zoning at (415) 558-6378, as neither broker or landlord represent that this space is suitable for your use. Tenant or Buyer must verify the information at their own expense and bears all the risk for any inaccuracies. By receiving these materials you are agreeing to the disclaimers set forth herein. DRE#01878802