

## UNIONTOWN'S RETAIL DESTINATION



# 40,000 SF SPACE FOR LEASE

99 MATTHEW DRIVE / UNIONTOWN, PA 15401

### Highlights:

- Space is Approximately 160' x 240'
- Recessed Doc in Rear of Building
- 1,100 Shared Parking Spaces
- 26,000 +/- VPD - Matthew Drive and McClelland Road
- Join Lowes, Burlington, PA Wine and Spirits Store, Chipotle, Pearl Vision, Longhorn Steakhouse, Sherwin Williams and Shoe Carnival



## NEWMARK

Licensed in Pennsylvania as Newmark Real Estate

The information contained herein has been obtained from sources deemed reliable but has not been verified and no guarantee warranty or representation either express or implied is made with respect to such information. Terms of sale or lease and availability are subject to change or withdrawal without notice.

*For information, please contact:*

**Martin Perry, CCIM**  
Senior Managing Director  
O 412-281-0100  
M 412-310-2315  
[martin.perry@nmrk.com](mailto:martin.perry@nmrk.com)



# 40,000 SF SPACE FOR LEASE

99 MATTHEW DRIVE / UNIONTOWN, PA 15401



## Uniontown's Retail Destination

- *Neighboring Tenants Include:*  
Target, Lowes, Home Depot, Panera Bread, McDonalds, Dunkin Donuts, Staples, AHN Neurology, Boot Barn, Gabe's, Chipotle, Big Lots, Burlington, Harbor Freight and Uniontown Mall
- Pylon Signage Overlooking Highway 119 and at Shopping Center Entrance



For information, please contact:



**Martin Perry, CCIM**  
Senior Managing Director  
O 412-281-0100  
M 412-310-2315  
martin.perry@nrmk.com

**NEWMARK**



# 40,000 SF SPACE FOR LEASE

99 MATTHEW DRIVE / UNIONTOWN, PA 15401

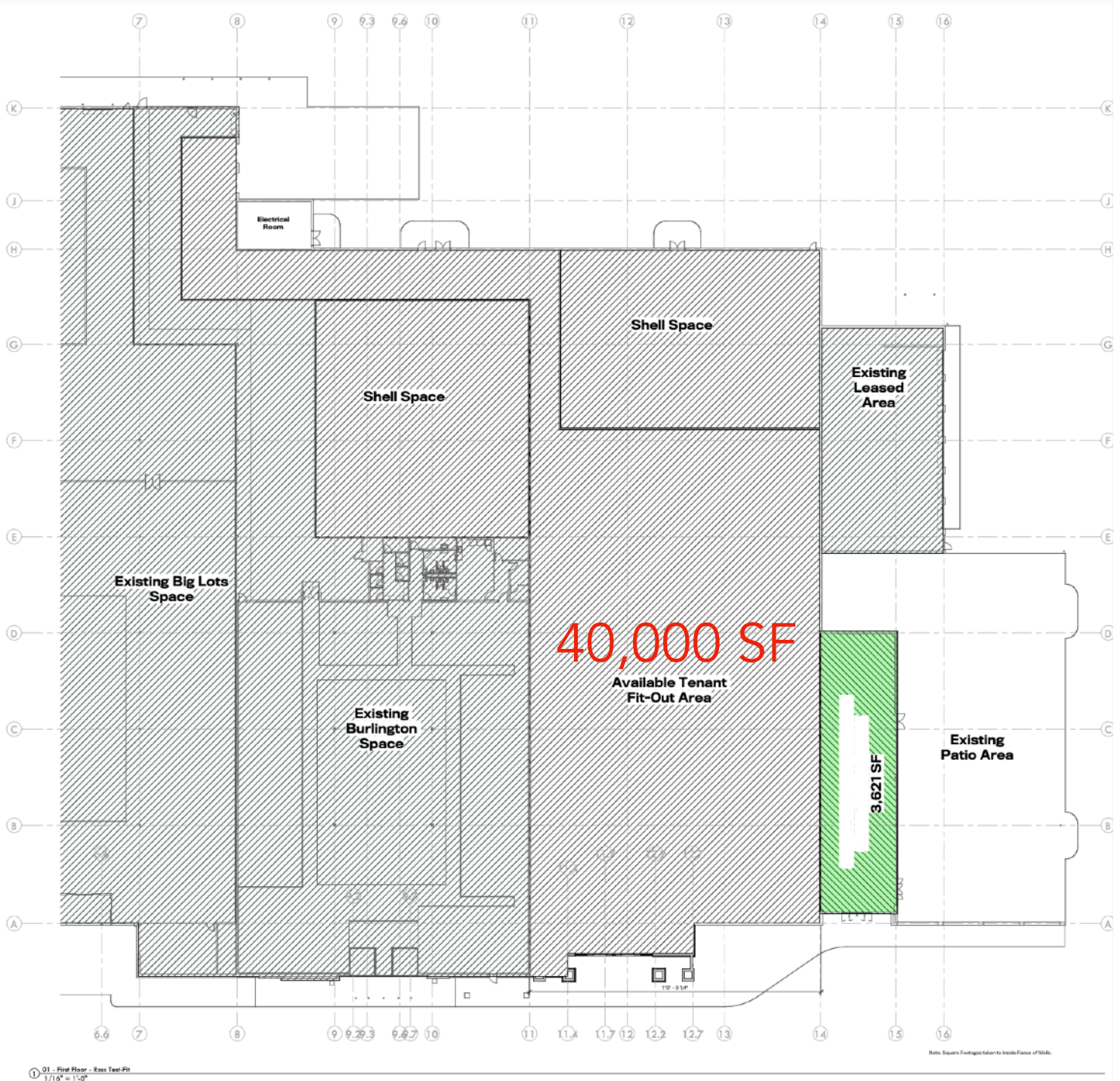

**NEWMARK**

Licensed in Pennsylvania as Newmark Real Estate

The information contained herein has been obtained from sources deemed reliable but has not been verified and no guarantee warranty or representation either express or implied is made with respect to such information. Terms of sale or lease and availability are subject to change or withdrawal without notice.

For information, please contact:

**Martin Perry, CCIM**  
Senior Managing Director  
O 412-281-0100  
M 412-310-2315  
martin.perry@nmrk.com