



B · SQUARE REALTY 盛世地產



BARBIE LI
REAL ESTATE TEAM

866 SECOND AVE #10A
NEW YORK, NY 10017

MIDTOWN EAST OFFICE FOR SALE

ASKING PRICE

\$4,880,000

HIGHLIGHTS

- 2 Blocks to Grand Central Station
- Newly Renovated
- Floor Through Office Condo
- Direct Elevator Access to Unit
- Open Layout & Large Windows
- Perfect Owner/User Opportunity

ALL INFORMATION INCLUDING BUT LIMITED TO LOT SIZE, TAXES, AND AGE OF PROPERTY ARE NOT GUARANTEED AND SHOULD BE INDEPENDENTLY VERIFIED BY PROSPECTIVE BUYERS.

PROPERTY INFO

6,450 SF

GROSS SQFT

\$81,446/Y

R.E. TAXES

\$10,537/M

C.C.

OFFICE SPACE (RB)

BUILDING CLASSIFICATION

OFFICE CONDO

PROPERTY TYPE

1970

YEAR BUILT

\$336/M

UTILITY(ELECTRICITY)

C1-9 / TA

ZONING

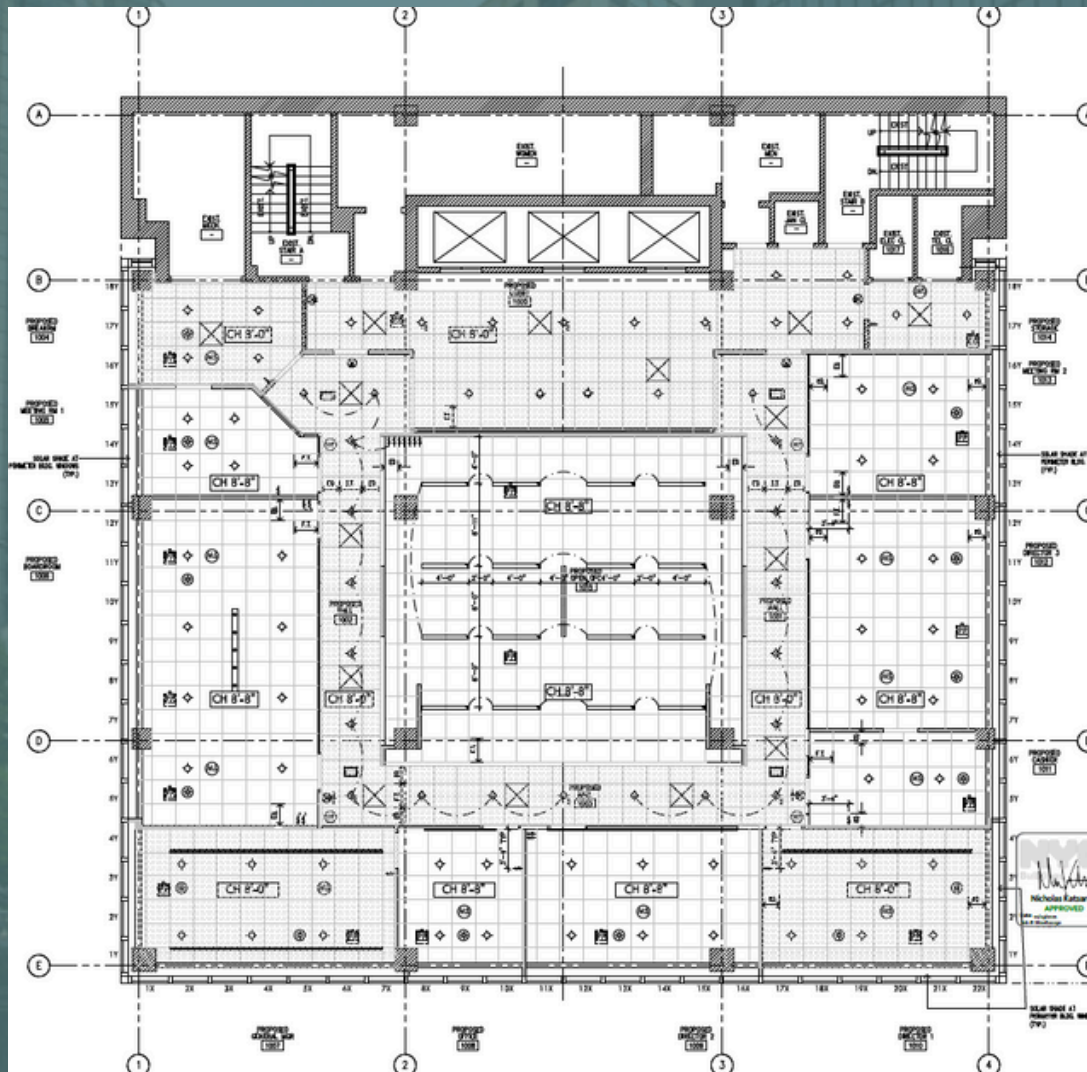

This newly renovated, floor-through office condominium in Midtown East presents an exceptional opportunity for owner/users seeking a prime location just two blocks from Grand Central Station. Spanning approximately 6,450 sqft, the unit features an open layout with large windows that flood the space with natural light, creating an efficient and inviting work environment.

Currently leasing for **\$48,000 per month**, the space offers direct elevator access and is conveniently located near major transportation hubs, the United Nations, and several consulates within the building. It's an ideal space for professional offices looking to establish a prestigious presence in the heart of the city.



PHOTOS





LOCATION

This prime location is just 2 blocks from Grand Central Station. The building is adjacent to Dag Hammarskjöld Plaza, offering a pleasant outdoor space just steps away. It's also within a 10-minute walk to the UN Gift Garden and East River, providing an ideal environment that seamlessly combines convenience and relaxation.



Listing Agent

Barbie Li

Lic. R.E Broker
 Team Leader of BLT
 Team Mentor of B2STARS

Schedule a Showing
 Email us at info@barbieliteam.com

More information
 please call at **646-889-9988**



B · SQUARE REALTY 盛世地產

T: (718)939.8388 136-20 38th Ave 3E, Flushing NY 11354
 COMING SOON 800 Northern Blvd, Great Neck, NY 11021



BARBIE LI
 REAL ESTATE TEAM

Barbiebroker @barbie_li_ny_broker

ALL INFORMATION INCLUDING BUT NOT LIMITED TO LOT SIZE, TAXES, AGE OF PROPERTY ARE NOT GUARANTEED AND SHOULD BE INDEPENDENTLY VERIFIED BY PROSPECTIVE BUYERS.