

Alafaya Corporate Center – East Market

3,852 RSF Available



Property Highlights

- 2100 North Alafaya Trail – Suite 200
- 3,852 Rentable Square Feet Available
- **Available May 1, 2019**
- Direct Alafaya Trail Building and Monument Signage
- Adjacent to the Central Florida Research Park and University of Central Florida
- Close Proximity to SR 408 and SR 417
- No After Hours Air Charges
- 100% Office Space with 1+% Common Area Factor

For Information Contact:

Faith Pamplin, Mike Fess, or Gabriela Ferreira

1300 N Semoran Blvd. – Suite 225, Orlando, FL 32807

Office: 407.660.4949 | Fax: 407.660.4995

faithpamplin@equitypartners.net, mikefess@equitypartners.net,
gabrielaferreira@equitypartners.net

Alafaya Corporate Center – East Market

3,852 RSF Available

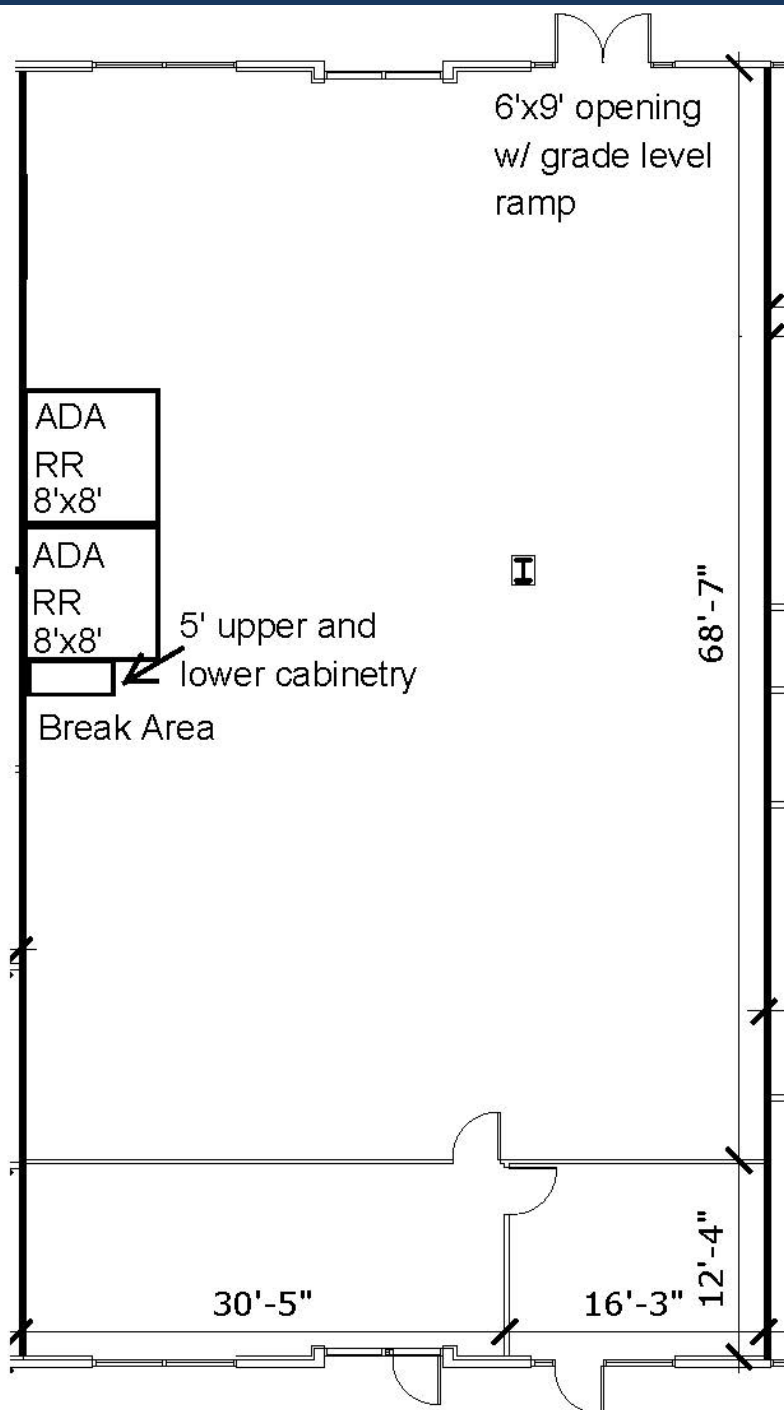

For Information Contact:

Faith Pamplin, Mike Fess, or Gabriela Ferreira

1300 N Semoran Blvd. – Suite 225, Orlando, FL 32807

Office: 407.660.4949 | Fax: 407.660.4995

faithpamplin@equitypartners.net, mikefess@equitypartners.net,

gabrielaferreira@equitypartners.net