

Unauthorized alteration or addition to this survey is a violation of Section 7209 of the New York State Education Law.

Copies of this Survey Map not bearing the land surveyor's mixed seal or embossed seal shall not be considered to be a valid true copy.

Guarantees indicated hereon shall run only to the person for whom the survey is prepared, and on his behalf to the Title Company, Governmental Agency and Lending Institution listed hereon, and to the Assignees of the Lending Institution. Guarantees are not transferable to additional institutions or subsequent owners.

MAP OF SOUTH BAY FARM S.
(P.L.E. No. 421), FILED JAN. 13, 1985

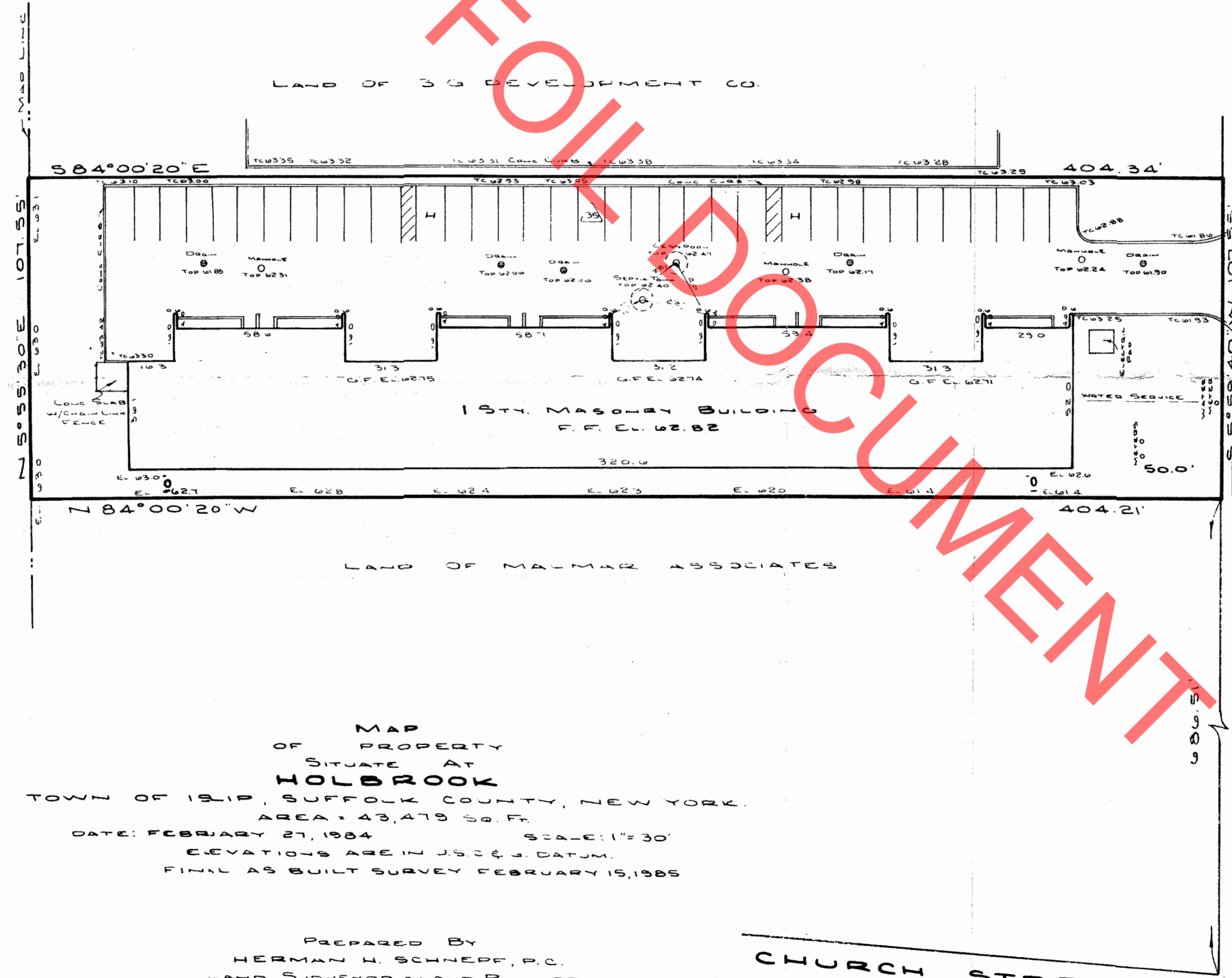

LAND OF S G DEVELOPMENT CO.

FOILED DOCUMENT

1ST MASONRY BUILDING
F.F. CL. 62.82

LAND OF MALMAR ASSOCIATES

KNICKERBOCKER AVENUE

CICURCI STREET

MAP OF PROPERTY OF SITUATE AT HOLBROOK TOWN OF 1918, SUFFOLK COUNTY, NEW YORK. AREA: 43,479 SQ. FT. DATE: FEBRUARY 27, 1984. SCALE: 1"=30'. ELEVATIONS ARE IN U.S.C. & G. DATUM. FINAL AS BUILT SURVEY FEBRUARY 15, 1985.

PREPARED BY HERMAN H. SCHLEPP, P.C. LAND SURVEYOR - LAND PLANNER 286 NORTH MAIN ST. CALVILLE, N.Y.

CERTIFIED TO: PHILIPP R. EBERT

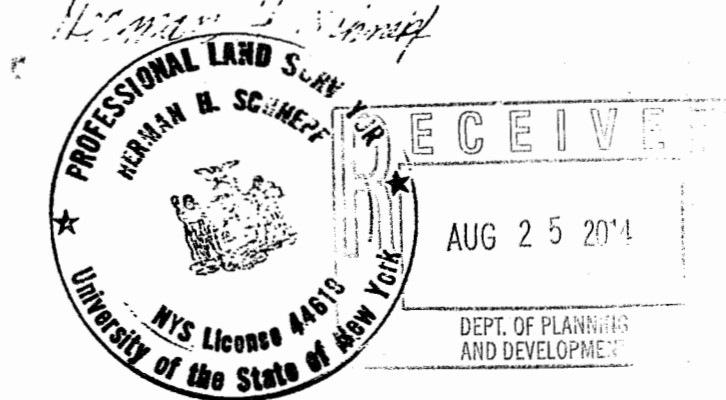

RECEIVED
AUG 25 2014

DEPT. OF PLANNING AND DEVELOPMENT

SCITM. 0500-215-1-29.19

FILE NO. 1246

TANK POOL & WATER LOCATION PROVIDED BY BUFILE 2113/85